



**Heartland**  
**AG SYSTEMS**

Heartland Agriculture, LLC

**6000**  
**APPLICATOR**

**LIQUID FERTILIZER**

**OWNERS MANUAL**  
**ASSEMBLY INSTRUCTIONS**  
**AND PARTS LIST OM-6000L**

HEARTLAND AG SYSTEMS  
1180 STATE HWY 7 EAST  
HUTCHINSON, MN. 55350  
(320) 587-4030

ISSUE  
MARCH 2022



# WARRANTY REGISTRATION

## TO THE DEALER:

Inspect the implement thoroughly after assembly to be certain it is functioning properly before delivering it to the customer. Check off each item as it is found satisfactory or after proper adjust is made.

### PRE -DELIVERY CHECKLIST

- \_\_\_\_\_ 1. All hardware properly tightened.
- \_\_\_\_\_ 2. Lubrication of grease fittings.
- \_\_\_\_\_ 3. All decals properly located and readable.
- \_\_\_\_\_ 4. Other adjustments, "level operation", "drawbar height", etc.
- \_\_\_\_\_ 5. Proper tongue weight after all options are mounted. Adjustments made if required.
- \_\_\_\_\_ 6. Overall condition. Touch-up paint any scratches. Clean and polish
- \_\_\_\_\_ 7. Operator's manual.

Seller Information	
Date set-up	_____
Signature	_____
Dealer name	_____
Address	_____
City, state, zip	_____
Phone	_____

Review the operator's manual with the customer. Explain the following:

- \_\_\_\_\_ 1. Safe operation and service
- \_\_\_\_\_ 2. Correct machine installation and operation.
- \_\_\_\_\_ 3. Correct and periodic lubrication and maintenance.
- \_\_\_\_\_ 4. Daily and periodic inspection.
- \_\_\_\_\_ 5. Troubleshooting.
- \_\_\_\_\_ 6. Storing machine.
- \_\_\_\_\_ 7. Heartland AG Systems parts and service
- \_\_\_\_\_ 8. Have the customer write the machine model and serial number in the space provided in the manual introduction
- \_\_\_\_\_ 9. Give the customer the operator's manual and encourage the customer to read the manual carefully.

Customer Information	
Date delivered	_____
Customer name	_____
Customer address	_____
Signature	_____
Model number	_____
Serial number	_____



# CONTENTS

Dealer Checklist (Fill Out and Return)	2			23
To the Owner				
Warranty	W1-8			24
Introduction	5			25
Safety	6			26
Assembly Procedure	7 - 9			27
Toolbar Illustration	10			28
→ Toolbar Parts List	11			29
Caddy Illustration	12			30
Caddy Parts List	13			31
Liquid Application Plumbing (Manifold methods)	14			32
Liquid Application Plbg (Spray-boom method)	15 - 16			33
Orifice Size Charts	17 - 19			34
Manifold Illustration (Stainless Steel)	20			35
Manifold Illustration (Nylon)	21			36
Fertilizer Suspension Plumbing (low pressure)	22			37-39
				40

## **TO THE OWNER**

This manual has been prepared to assist you in the assembly of your new equipment and contains information pertaining to safety, operating information and all its parts.

Our personnel in sales and service are always available to assist you when questions arise concerning the assembly and operation of your machine.

When ordering parts, please refer to part numbers and descriptions as listed throughout this book. All parts and whole goods will be shipped FOB Hutchinson, Minnesota. Always check merchandise immediately upon receipt for damage or shortage. Note any discrepancy on the carrier's bill of lading and notify Heartland AG Systems within 10 days.

Any returned goods will be subject to a 20 percent restocking charge.

Heartland AG Systems reserves the right to make improvements and modifications on equipment without obligation to change previously built equipment. All prices are subject to change without notice.

## **Warranty Policies and Terms**

The Heartland Agriculture, LLC warranty is a limited warranty that is provided to the retail purchaser in return for consideration paid as part of the purchase price for a product. The selling dealer must review the warranty coverage with the retail purchaser and obtain a signature on the Operators Manual for warranty verification.

The warranty described here is for Heartland Agriculture, LLC doing business as Heartland AG Systems and its product line Heartland AG Systems Equipment sold and registered in the United States and Canada and normally operated in the United States and Canada.

### **Warranty Period**

The warranty period for all coverage begins at the time that any person, dealer or agent first places the unit into service. At the latest, a unit is placed into service when purchased or delivered to a purchaser.

### **What's Covered**

If a defect in material or workmanship is found in a unit and reported during the Warranty period, Heartland AG Systems will pay parts and labor costs to repair the defects if the services are performed by an authorized Heartland AG Systems dealer. If parts are needed during the repair, Heartland AG Systems will, at its option, use genuine Heartland AG Systems, or remanufactured parts.

Heartland AG Systems provides no warranty, express or implied, for a component or other item that is separately warranted to the purchaser by its manufacturer, such as tires. Check with your local dealer for these details.

### **Exclusive Remedy**

The remedy of repairing a defect in material or workmanship at a Heartland AG Systems dealership under the terms of this warranty is the purchaser's exclusive remedy and is in lieu of any other remedy otherwise available.

### **No Modification or Extension of Warranty**

The Heartland AG Systems Warranty is limited to the written terms in the warranty statement. Heartland AG Systems does not authorize any person, dealer, or agent to change or extend the terms of this warranty in any manner. Any assistance to the purchaser in the repair or operation of any Heartland AG Systems product outside the terms or limitations or exclusions of this warranty will not constitute a waiver of the terms, limitations or exclusions of this warranty, nor will such assistance extend or re-establish the warranty.

The warranty is void if the unit is used in an application for which it is not designed or the unit has been scrapped, salvaged, stolen, junked or totaled.

### **Limitations and Exclusions**

The Heartland AG Systems warranty gives you specific legal rights and you may also have other rights, which vary from state to state. This section contains the entire Heartland AG Systems warranty. Heartland AG Systems makes no other representations or warranties, expressed or implied, and specifically excludes the implied warranties of merchantability and fitness for particular purpose. Heartland AG Systems will not be liable for incidental or consequential damages resulting from a breach of the written warranty or any implied warranty.

- These limitations and exclusions may not be allowed by some states or provinces and shall not apply to the extent such limitations or exclusions are not allowed by applicable state/provincial law.

### **Owner's Responsibility**

The Heartland AG Systems Warranty remains in effect during the warranty period if the owner performs the required maintenance at the recommended intervals outlined in the product's operator's manual and the unit is operated within its rated capacity. Genuine Heartland AG Systems service parts or Heartland AG Systems approved service parts that meet Heartland AG Systems specifications must be used for maintenance and repairs.

### **What Is Not Covered**

- Replacement of non-defective wear items expected to be replaced during the warranty period, including, but not limited to: lights, fuses, belts, drive sprockets and chains, hose, soil engaging tools, spray tips, fertilizer deflectors, spinner blades and accessories or items replaced due to customer demand.
- Normal maintenance parts and service, including, but not limited to lubrication, coolants, and filters.
- All travel costs associated with hauling or towing a customer's machine to and from a repair center related to any warranty repair unless specifically covered by a program or policy.
- Repairs arising from any unauthorized modification to the product.
- Repairs arising from service performed by agents not approved by Heartland AG Systems.
- Repairs arising from storage deterioration, failure to maintain the equipment, improper use of the equipment, collision or other accident, vandalism, or other casualty, or operation beyond the rated capacity or specifications.
- Repairs arising from abuse or neglect including, but not limited to operation without adequate lubricants or coolant, over-speeding, contaminated fluids, improper storage, starting, warm-up, or shutdown practices.
- Failure of the machine, its implements or attachments caused by improper field application or overloading.
- Premiums charged for over-time labor costs.
- Economic loss, including lost profits, crop loss, equipment rental or other expenses.
- Cost associated with cleaning of machine in preparation for service.
- Loss or damage during shipment.



- Cost of initial setup or installation of any optional equipment or attachments to a unit.
- Items used for repairs include, but are not limited to: solvents, cleaners, anti-seize lubricants, oil-dry, shop towels, shop supplies, special tools, etc.
- Included, but not limited to are checkups, adjustments, and shimming, tune-ups, spread pattern checks, etc.
- Unauthorized modification or field fixes.
- All costs of special tools or shop supplies incurred with repairs.
- Claims for stolen equipment or parts.
- Claims for replacing a complete assembly when the repair is less than the replacement.
- Claims involving the inspection or reconditioning of units.
- Shop comebacks: any duplicate, repeat, or comeback repair resulting from improper diagnosis, testing, or poor service work.
- Cost of removing or installing Non-Heartland AG Systems optional equipment or attachments.

**Base Warranty Coverage**

- Base Warranty is the factory warranty provided to the customer at no additional cost for a specific period covering the complete machine.
  - Liquid Applicators, except tires 1 Year
  - Spreaders and Tenders, except tires 1 Year
  - Nh3 Wagons, except tires 1 Year
  - Bumper Hitches 1 Year
  - Disc Covers 1 Year
  - Parts 90 Days
  - Tandem Wagons (except tires and main frame) 1 year
    - o Tandem Wagon main frame 5 Years
  - Nitromaster Toolbars shall carry the following pro-rated warranty:
    - o Year one, all components except tires 100%
    - o Year two, center section and wings 80%
    - o Year three, center section and wings 50%
    - o Year four, center section and wings 25%
    - o Year five, center section and wings 10%

### **Tires**

Tires installed on all Heartland AG Systems Equipment are warranted and serviced by their manufacturer's service outlets. Some manufacturers have separate service outlets for off road agricultural and construction equipment. Service is available by contacting the tire manufacturer's local representative.

### **Warranty Registration**

All machinery items, which are invoiced by Heartland AG Systems on separate receivables, must be registered for warranty. The warranty period for all coverage begins at the time that any person, dealer, or agent first places the unit into service. New machine warranty coverage begins when the machine is registered. Registration is accomplished when a properly completed Warranty Registration is received and processed by Heartland AG Systems.

### **Operator's Manual/Warranty Receipt Verification**

The Heartland AG Systems New Equipment Limited Warranty for Agricultural Equipment statement must be filled out and signed by the customer indicating receipt and an understanding of the operator's manual and the warranty statement,

- The original form must be mailed to the address on the form.
- Make one copy for the Dealer. This copy must be retained by your dealership the same as any other legal document.
- Make a second copy for the customer.

### **Heartland AG Systems Responsibility**

If a defect in material or workmanship is found in a product during its warranty period, Heartland AG Systems will pay parts and labor costs to repair the defect when the service is performed by an authorized Heartland AG Systems dealer or agent. If parts are needed during the repair, Heartland AG Systems will, at its option, use genuine Heartland AG Systems new or remanufactured parts. These responsibilities include, but are not limited to:

- Costs for repairs that are the result of defects in material and workmanship
- Payment to dealers per policy in a timely manner
- Service information to dealers
- Identify product deficiencies and take corrective action by field campaigns
- Make determination of premature wear
- Provide unit that is free of defects in material & workmanship

### **Dealer Responsibility**

Heartland AG Systems dealers are responsible for providing prompt, courteous, and willing service to all Heartland AG Systems equipment owners. These responsibilities include but are not limited to:

- Equipment set-up and pre-delivery
- Sell the right product for the intended application
- Inspect the unit and initiate recovery action on any shipping damage and or shortages
- Instruct customer on proper use, maintenance, and safety features of machine
- Advise and explain warranty coverage to customer
- Diagnose the problem, repair the unit, and submit claims in accordance with the terms and conditions of the warranty claim policies
- Take responsibility for saying "NO" to customers on non-warranty failures
- Apply failure analysis to questionable repairs
- Complete product update campaigns
- Have properly trained technicians and adequate tools for the job
- Retain proper documentation of failure repaired

### **Owners Responsibility**

The Heartland AG Systems warranty remains in effect during the stated warranty period if the owner performs the required maintenance at the recommended times as outlined in the products operator's manual. Genuine Heartland AG Systems or Heartland AG Systems approved service parts must be used for maintenance. Additionally, the owner will pay for all transportation or travel expenses related to any warranty repair.

These responsibilities include, but are not limited to:

- Perform maintenance as indicated in the operator's manual
- Use the unit in the correct application (non-abusive)
- Notify dealer of failures and have the machine available for repair in a timely manner
- Training operators
- Travel cost, towing charges, and service calls
- Normal wear items
- Machine damage (accidental)
- Adjustments for application
- Machine inspection (daily walk-around)

### **Warranty Eligibility**

The dealer is responsible to determine that any Heartland AG Systems equipment is covered by Heartland AG Systems warranty before performing a repair and that the repair is a warrantable failure. Any dealer who is in doubt of the equipment's warranty eligibility may call Heartland AG Systems for verification.

### **Warranty Repairs Made by the Customer**

If a Heartland AG Systems dealer determines that the customer is capable, and the customer requests permission to perform select(warranty)repairs on his product, the Heartland AG Systems dealer is authorized to grant this customer request. The servicing dealer should provide the parts to the customer upon request, and to assure that customer is properly instructed on how to perform the repairs correctly.

The servicing dealer is responsible and accountable for claim accuracy and validity; specifically, in areas such as the parts replaced date, and assurances that the parts are installed as instructed by Heartland AG Systems. The comments section of the claim should clearly state that the customer installed the parts. The claim reimbursement will be for parts and applicable handling only. No labor is allowed! All replacement parts must be held for possible recall.

### **Parts Shortages on Whole-Goods**

Dealers may submit a claim for parts shortages discovered during pre-delivery or during final assembly at the dealer's location. All claims for shortages must be submitted 5 days from the original ship date from the plant and before the warranty start date.

### **Warranty Reimbursement Policies**

Heartland AG Systems provides for warranty reimbursement due to defects in material or workmanship only. Warranty does not include restoring any machine or portion thereof, which has accumulated hours of operation, to factory new condition. This includes customer owned and used equipment.

Except for only a few items not available through Heartland AG Systems, all Heartland AG Systems manufactured equipment warranty repairs must be performed using only Heartland AG Systems genuine new or remanufactured parts and accessories. Installation of non-Heartland AG Systems parts does not qualify for warranty reimbursement and can void the machine's warranty.

### **Parts**

It is fully expected that all claims be filed using part numbers from the applicable Heartland AG Systems equipment parts book whenever such part number exists. Heartland AG Systems shall reimburse the dealer at the dealer net price (cost) in effect on the parts replaced date.

### **Labor**

Heartland AG Systems shall reimburse the dealer at 80% of the dealer's posted retail shop labor rate. The retail shop labor rate shall be subject to verification by Heartland AG Systems from copies of actual dealer invoices to customers.

### **Outside Charges**

Specialized repair such as that done by a machine shop will be accepted as part of a warranty claim at actual cost. Explain the parts used and the service work performed in the description section of the claim and retain a copy of the receipt. Retain a copy of the invoice with the shop work order to support the claim. Outside repairs that exceed the cost of the same repair, if performed by the dealer, will be reimbursed at a lower rate.

### **Freight**



Heartland AG Systems will pay the freight charges when a warranty recalled part is to be returned to Heartland AG Systems.

### **Travel**

Travel will only be reimbursed when authorized by a field campaign.

### **Repairing or Replacing Parts and Components**

When performing a warranty repair, a complete part or component should not be replaced under warranty if the repair can be accomplished at a lower cost. If the total cost of the repair including the cost of parts, labor, and/or outside labor or materials is less than 75% of the cost of the parts, the part must be repaired.

### **Filters and Lubricants**

Replacement of lubricants and filters do not qualify for warranty reimbursement unless damage caused by a defect in material or workmanship results in contamination or sudden loss of fluid. Lack of maintenance, operator misuse, or neglect will not qualify for warranty reimbursement.

## **Claim Form Guidelines**

### **Claims Must Have**

1. Product identification number (PIN) or serial number. All characters of the PIN must be used on the warranty claim.
  - Claims for parts warranty must use the word "PARTS" for the PIN. An invoice that shows date of sale or date of installation must be supplied for all parts claims.
2. Model Number
3. Date of failure – Claims must be submitted within 30 days or repair.
4. Date of repair
5. Warranty start date. Date the unit warranty starts or date the parts were sold for parts warranty.
6. Description of the problem. Describe all problems pertinent to the claim.  
Comments should be as precise as possible, attach a separate sheet if necessary, to describe the problem.
7. Description of the work performed. List each significant action of the repair.
8. Itemize labor. Provide a breakdown of labor for each significant repair action in the "Describe Work Performed" column.
9. Shop order numbers. The shop order number field is used for recording your shop work order number that is related to the claim. The shop order number field can also be used to record the parts invoice number when claiming a parts warranty.
10. Customer information. Customer information includes the customer name, city, state, county, and postal code. It must match the warranty registration.
11. Warranty claim total. The total of all reimbursement costs requested.
12. Dealer signature and date. All claims must be signed and dated by the distributor to be validated.

# INTRODUCTION

INTRO

Read this manual carefully. It will instruct you on how to operate and service your machine safely and correctly. Failure to do so could result in personal injury and/or equipment damage.

Right hand and left hand sides of the machine are determined by (standing behind the machine) facing in the direction the machine will travel when going forward.

Warranty is provided for customers who operate and maintain their equipment as described in this manual. Warranty registration is accomplished by the dealer completing and forwarding the WARRANTY REGISTRATION FORM along with a copy of the dealer's invoice to Heartland Ag Systems. It is in your best interest to insure that this has been done.

WARRANTY does not cover the following.

- 1. Cleaning, transporting, mailing and service call charges.
- 2. Depreciation or damage caused by normal wear, accidents, improper protection or improper use.

**WARNING:** This message denotes a specific potential hazard.

\*\*\*\*\* See complete WARRANTY for details

**CAUTION:** This message denotes a reminder of safety practices.

Record your machine model and serial number in the space provided. Your dealer needs this information to give you prompt, efficient service when you order parts.



**NOTE:** Indicates a special point of information.

MODEL NUMBER \_\_\_\_\_

\*\*\*\*\* Carefully read and follow all safety signs.  
\*\*\*\*\* Reinstall safety signs that are damaged or missing.

SERIAL NUMBER \_\_\_\_\_

DATE PURCHASED \_\_\_\_\_

## SAFETY INFORMATION CONTINUED

### FOLLOW SAFETY INSTRUCTIONS

Carefully read all safety messages in this manual and on your machine safety signs. Keep safety signs in good condition. Replace missing or damaged safety signs.

Learn how to operate the machine and how to use the controls properly. Do not let anyone operate without instructions.

Keep your machine in proper working condition. Unauthorized modification to the machine may impair the function and/or safety and affect the machine life

### PROTECT CHILDREN AND BYSTANDERS

Before you back, LOOK CAREFULLY behind for children

Clear area of children, pets, and bystanders

### TRANSPORT SAFETY

-- Always use safety chains during road transportation.

-- Check wheel nuts daily

-- Use hydraulic cylinder transport lock-up during road transportation.

-- Maximum recommended road speed is 25 MPH

-- Clear machine of personnel and obstructions

PART NUMBER: 699102



PART NUMBER: 30481

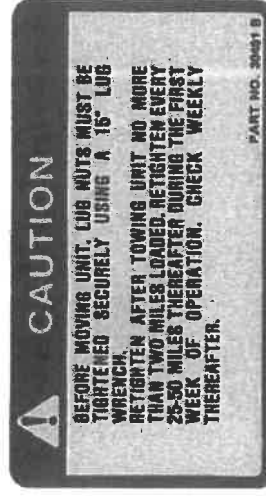

PART NUMBER: 699107



PART NUMBER: 699101



PART NUMBER: USA



PART NUMBER: 699104

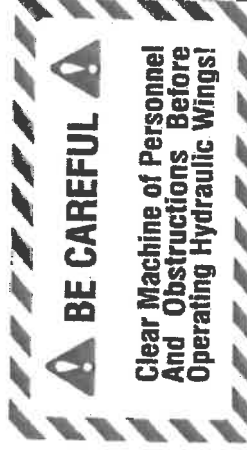



## 6000 TOOLBAR AND CADDY ASSEMBLY PROCEDURE with LIQUID TANK SKID

Your 6000 Toolbar and Caddy are shipped with the small parts and hardware packed in boxes marked for the different sections of the machine. If you find any items missing, contact Ag Systems, Inc. immediately.

- Step 1. Select a smooth level service for the assembly of your toolbar.
- Step 2. Refer to the illustration on Page 12. Place the caddy frame (Item 1) upon four steel saw horses, one at each corner of the frame.
- Step 3. Install the axle assembly (Item 4) left hand, and (Item 5) right hand, with the u-bolts (Item 6) and appropriate hardware, snug only. The hubs are pre-assembled to the axles.
- Step 4. Mount the wheels (Item 11) and tires (Item 13) on the hubs.
- Step 5. Position the wheels at the desired track width and securely tighten the hardware.
- Step 6. Place the toolbar center section (Item 17, Page 10) on two saw horses and attach it to the caddy frame with the pivot pins (Item 2, Page 12) and lynch pins (Item 3).
- Step 7. Assemble the pole (Item 1, Page 10) with the u-bolts (Item 14) and appropriate hardware.
- Step 8. Install the hitch (Item 3) with the hitch pin (Item 2) and the lynch pin (Item 4). Install the hose support (Item 10) with the u-bolt (Item 7) and appropriate hardware. Attach the jack (Item 5).
- Step 9. Position the hydraulic cylinder (Item 40) between the pole and the caddy frame with the body towards the pole and the shaft on the caddy. Use the standard cylinder pin at the body end. Use the clevis pin (Item 50) and assemble the transport lock (Item 49) washer (Item 51) and hairpin (Item 52) at the shaft end of the cylinder. Fully extend the shaft on the hydraulic cylinder and place the transport lock in the transport position. You may now remove the saw horse supports and rest the assembly on the wheels and jack.
- Step 10. Assemble the primary wings (Item 26, 27, or 28) to the center section with the hinge pins (Item 21) and secure with the collar (Item 22) and appropriate hardware. Install the leveling screws (Item 19) with one nut (Item 20) on each side of the end plate on the center section.
- Step 11. If applicable to your machine, assemble the secondary wings (Item 29) to the primary wings with the appropriate hardware.
- Step 12. Position the main hydraulic cylinders (Item 40) to the center section and wings with the body on the center section and the shaft on the wings. Install with the standard cylinder pins supplied.
- Step 13. Assemble the wing transport locks (Items 33 and 34) to the cylinder lugs on the center section with the appropriate hardware..

- Step 14. Assemble the pivot bracket base (Item 23, Page 12) to the center of the rear tube on the caddy frame with the u-bolts (Item 24) and appropriate hardware.
- Step 15. Assemble the pivot bracket (Item 27) and pivot link (Item 34) to the bracket base with the clevis pin (Item 29) and the hairpin (Item 30).
- Step 16. Assemble the hinge bracket (Item 14) to the left axle (Item 4) with the appropriate hardware.
- Step 17. Assemble the ground wheel control (Item 22) to the hinge bracket with the shaft (Item 18) and appropriate hardware.
- Step 18. Assemble the ground wheel control as follows:
- A. Assemble the bearings (Item 47) to the inside of the ground wheel control with the appropriate hardware.
  - B. Assemble the shaft (Item 53) with the drive sprocket (Item 54), the hub (Item 58), and the square key (Item 55) and secure with the set screws in the hub and sprocket.
  - C. Install the shaft assembly in the bearings in the ground wheel control and secure with the set screws in the bearings.
  - D. Assemble the idler sprocket (Item 49) to the ground wheel control with the bolt (Item 48) and one washer (Item 50) on each side of the sprocket and fasten with the appropriate hardware.
  - E. Position the eye bolt (Item 38) thru the slotted hole in the ground wheel assembly and attach it to the hinge bracket (Item 14) with the clevis pin (Item 39) and the cotter pin (Item 40).
  - F. Position the transport lock pin (Item 35) thru the guide tube on the ground wheel control and install the expansion pin (Item 37) in the end hole on the lock pin. Insert the hairpin (Item 36) in the hole in the guide tube and thru the hole nearest the handle in the lock pin.
  - G. Assemble the spring (Item 41) and the spring cap (Item 42) to the eye bolt and secure with two nuts (Item 43). Turn the nuts onto the eye bolt to a point so that at least 3/4 inch of thread is protruding from the nuts.
  - H. Mount the wheel (Item 59) on the hub (Item 58).
  - I. Mount the pump (Not Shown) and install the drive chain (Item 56) and link (Item 57). Adjust the idler and drive sprocket positions so that all three sprockets line up and the drive wheel (Item 59) is centered on the caddy wheel. To do this you may have to move the sprocket on the shaft or reposition the shaft in the bearings and/or add washers to the idler sprocket.
- Step 19. Assemble the clamp plate (Item 28) to the pivot bracket (Item 27) with the appropriate hardware, firmly clamping in place the square tube on the ground wheel control.
- Step 20. Position a temporary shim (approximately 1/4" thick) at the end of the transport lock pin (Item 35). Assemble the pivot control rod (Item 62) to the pole with one clevis pin (Item 65) and one hairpin (Item 66). Extend the adjustable clevis (Item 63) on the pivot control rod far enough so that when assembled with the pivot link (Item 34) all the play is removed from the assembly. Remove the temporary shim from the transport lock pin. You should now be able to push in the transport lock pin and freely insert the hairpin. If you cannot insert the hairpin, repeat the above procedure using a thicker shim. When this assembly is adjusted satisfactorily, secure it in place with the nut on the adjustable clevis.

- Step 21. Assemble the tank skid (Items 86, 91, 101. or 110) ) to the caddy frame with the appropriate hardware.
- Step 22. Install the hydraulic fittings (Items 42 to 47) as indicated on the illustration on Page 10. Install the hoses (Items 55 to 59) as indicated.
- Step 23. Purge the air from the hydraulic system.
- A. Firmly anchor the pole to a heavy stationary object or attach it to a tractor.
  - B. Pressurize the hydraulic system. Fully extend all cylinders and circulate the oil for approximately one minute.
  - C. Partially lift the wings and stop. Observe if the wings will sag. This would indicate air in the system.
  - D. Repeat Step B and Step C until the system operates satisfactorily.
  - E. Secure the hydraulic hoses as needed.
- Step 24. Mount your chemical tank and install the plumbing to the pump.
- Step 25. Attach the knife shanks (and coulters) at the desired spacings.
- Step 26. Assemble the desired knives to the shanks.
- Step 27. Install the chemical application hoses and secure safely.
- Step 28. Fold the wings and raise the machine to full transport height. Secure the transport locks at the wings, the caddy cylinder, and the ground wheel control. Release the hydraulic pressure so that all supported items are resting on their transport locks.
- Step 29. Check to see that all hoses are in a safe and secure position.

**YOUR 6000 TOOLBAR IS NOW FULLY ASSEMBLED AND FIELD READY.**

# 6000 SERIES TOOLBAR

6000TBR03  
10-29-12

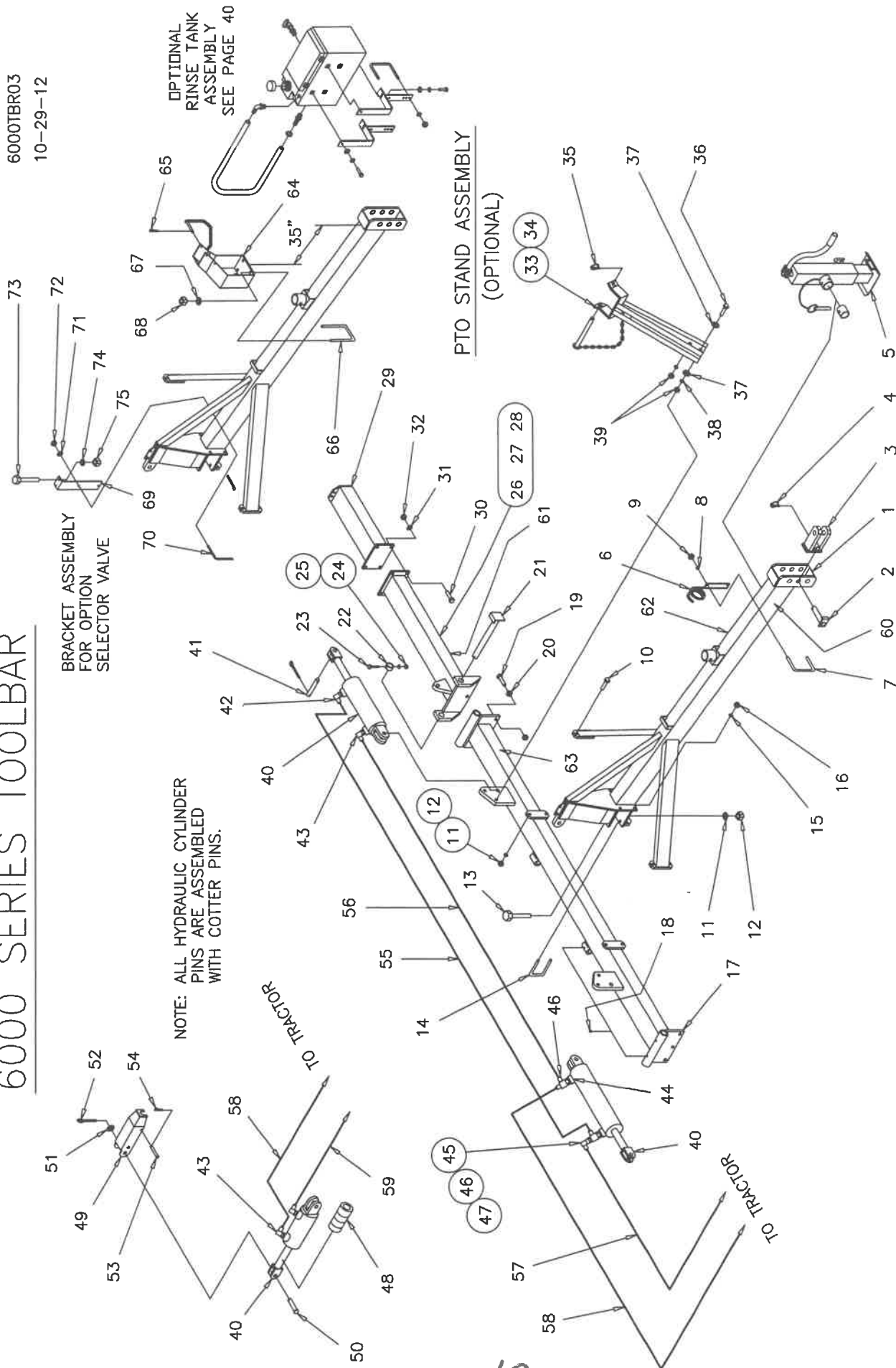

BRACKET ASSEMBLY FOR OPTION SELECTOR VALVE

NOTE: ALL HYDRAULIC CYLINDER PINS ARE ASSEMBLED WITH COTTER PINS.

PTO STAND ASSEMBLY (OPTIONAL)

TO TRACTOR

TO TRACTOR



## 6000 SERIES TOOLBAR PARTS LIST

ITEM	PART NO.	DESCRIPTION	QTY.	ITEM	PART NO.	DESCRIPTION	QTY.
1	47007236	POLE	1	39	18418400	HEX. NUT, 3/4-10NC.	4
2	47007238	HITCH PIVOT PIN	1	40	47300091	HYDRAULIC CYLINDER (3 1/2 X 8)	3
3	47007237	HITCH	1		47300092	HYDRAULIC CYLINDER (4 X 8)	
4	600190	LYNCH PIN	1			USE ON WINGS ONLY	OPT.
5	70924	JACK COMPLETE (FINISH PAINTED)	1	41	47003513	CYL. PIN KIT, (1 X 3 1/2)(2 PINS)	3
					47003514	CYL. PIN KIT, FOR 4 X 8 CYL.	OPT.
6	47010165	HOSE SUPPORT BRACKET	2		620232	HYD. FITTING PKG. (INCL. ITEMS 42 TO 47)	
7	47001028	U-BOLT, 3/8-16NC. (HOSE BRKT)	2	42	6801-6-8R	ELBOW, #6 MJIC X #8 M O-RING	1
8	18891200	LOCKWASHER, 3/8	4			WITH .045 ORIFICE (BLACK FINISH)	
9	18436800	HEX. NUT, 3/8-16NC.	4	43	6801-6-8	ELBOW, #6 MJIC X #8 M O-RING	3
10	18097934	BOLT, 5/8-11NC. X 2 1/2 GR. 8	4	44	6400-6-8	CONNECTOR, #6 MJIC X #8 M O-RING	1
11	18891600	LOCKWASHER, 5/8	6	45	6400-6-8R	CONNECTOR, #6 MJIC X #8 M O-RING	1
12	18417900	HEX. NUT, 5/8-11NC.	6			WITH .045 ORIFICE (BLACK FINISH)	
13	18097971	BOLT, 5/8-11NC. X 6 1/2 GR. 8	2	46	6602-6	RUN TEE, #6 MJIC X #6 FJIC SWIVEL	2
14	47996951	U-BOLT, 5/8-11NC. (GALV.)	2	47	6500-6	ELBOW, #6 MJIC X #6 FJIC SWIVEL	1
15	18991600	LOCKWASHER, 5/8 (GALV.)	4	48	47005455	SET, DEPTH CONTROLS (3 1/2 CYL)	1
16	18997900	HEX. NUT, 5/8-11NC. (GALV.)	4	49	47007229	TRANSPORT LOCK (3 1/2 CYL)	1
17	47007235	CENTER SECTION, STANDARD	1	50	18541651	CLEVIS PIN, 1 X 4 1/2	1
	47007488	CENTER SECTION, 28 FT. T'BAR ONLY	1	51	18852200	FLATWASHER, 1"	1
18	18901805	GREASE ZERK, STRAIGHT	6	52	18560826	COTTER PIN, 3/16 X 1 1/2	1
19	18098437	BOLT, 3/4-10NC. X 2 1/2 (FULL THD)	4	53	18541254	CLEVIS PIN, TRAVEL LOCK	1
20	18418400	HEX. NUT, 3/4-10NC.	8	54	18590916	HAIRPIN BRIDGE, (.125 DIA.)	1
21	47009562	WING HINGE PIN	2		609999	HYD. HOSE PKG. (INCL. ITEMS 55 TO 59)	
22	47006310	HINGE PIN COLLAR	2	55	609810	HOSE, 3/8 X 106 #6 JICFS (EA. END)	1
23	18056834	BOLT, 3/8-16NC. X 2 1/2	2	56	609610	HOSE, 3/8 X 82 #6 JICFS (EA. END)	1
24	18891200	LOCKWASHER, 3/8	2	57	609143	HOSE, 3/8 X 171 #6 JICFS X 1/2 MPT	1
25	18436800	HEX. NUT, 3/8-16NC.	2	58	609133	HOSE, 3/8 X 159 #6 JICFS X 1/2 MPT	2
26	47009642	SET, PRIMARY WINGS, (21 FT. T'BAR)	1	59	609123	HOSE, 3/8 X 147 #6 JICFS X 1/2 MPT	1
27	47009645	SET, PRIMARY WINGS, (26 FT. T'BAR)	1	60	699107	DECAL, AG SYSTEMS INC.	2
	47007000	SET, WINGS- PRIMARY & SECONDARY		61	699101	DECAL, DANGER FALLING WINGS	2
		INCLUDES ITEMS 28 TO 32 FOR 23 FT. T.BAR ONLY		62	699104	DECAL, BE CAREFUL	1
28	47007156	SET, PRIMARY WINGS, W/END PLTS.	1	63	699102	DECAL, DANGER - VAPORS	1
29	47007159	SET, SECONDARY WINGS	1	64	47008244	PTO STAND	1
30	18057930	BOLT, 5/8-11NC. X 2	8	65	18590091	HAIRPIN BRIDGE (.091 DIA.)	1
31	18891600	LOCKWASHER, 5/8	8	66	47006951	U-BOLT, 5/8-11NC.	2
32	18417900	HEX. NUT, 5/8-11NC.	8	67	18891600	LOCKWASHER, 5/8	4
33	47002880	WING TRANSPORT LOCK L.H.	1	68	18447900	HEX. NUT, 5/8-11NC.	4
34	47009564	WING TRANSPORT LOCK R.H.	1	69	47010171	SELECTOR VALVE BRACKET	1
35	600188	LYNCH PIN	2	70	47001028	U-BOLT, 3/8-16NC.	1
36	18058436	BOLT, 3/4-10NC. X 3	4	71	18891200	LOCKWASHER, 3/8	2
37	18851800	FLATWASHER, 3/4	4	72	18436800	HEX. NUT, 3/8-16NC.	2
38	18891800	LOCKWASHER, 3/4	4	73	18056469	BOLT, 5/16-18NC. X 3 1/4	2
				74	18811100	LOCKWASHER, 5/16	2
				75	18406400	HEX. NUT, 5/16-18NC.	2

FOR OPTIONAL RINSE TANK KIT  
SEE PAGE 40 OF THIS MANUAL

# 6000 SERIES CADDY ASSEMBLY

6000CDY03  
06-23-15

## FOR LIQUID APPLICATION

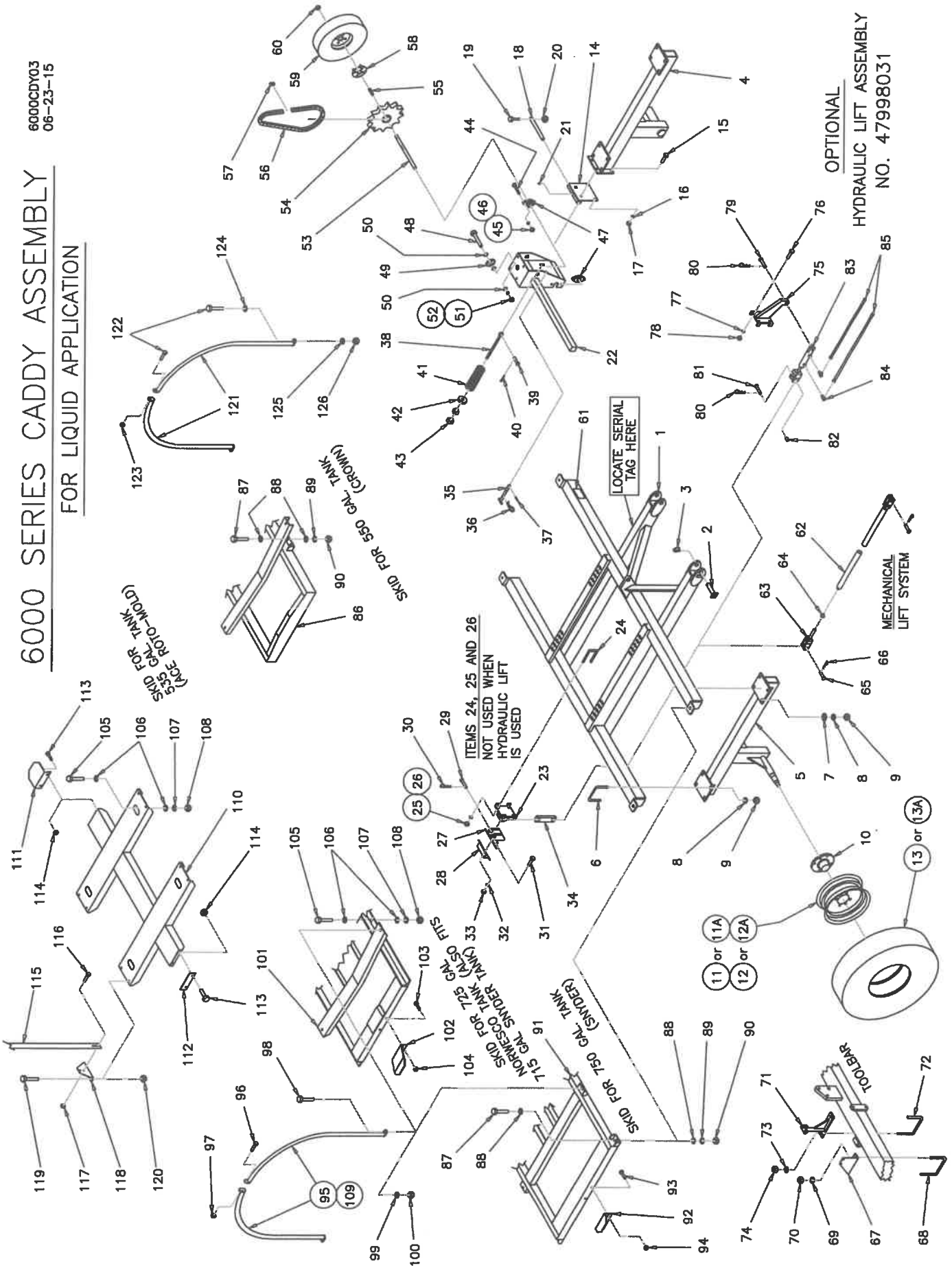

OPTIONAL  
HYDRAULIC LIFT ASSEMBLY  
NO. 47998031

MECHANICAL  
LIFT SYSTEM

SKID FOR 550 GAL. TANK  
(FACE ROTO-MOLD)

SKID FOR 550 GAL. TANK  
(CROWN)

ITEMS 24, 25 AND 26  
NOT USED WHEN  
HYDRAULIC LIFT  
IS USED

SKID FOR 725 GAL. TANK  
(ALSO FITS  
NORMESCO TANK (ALSO  
SKID FOR 750 GAL. TANK  
(SANDERS)

LOCATE SERIAL  
TAG HERE

TOOLBAR

ALL HARDWARE IS  
ZINC PLATED UNLESS  
OTHERWISE SPECIFIED.

### 6000 SERIES CADDY ASSEMBLY

FOR LIQUID APPLICATION

6000CLST03  
06-23-15

ITEM	PART NO.	DESCRIPTION	QTY.	ITEM	PART NO.	DESCRIPTION	QTY.
1	47007206	CADDY FRAME	1	68	47001028	U-BOLT, 3/8-16NC.	1
2	47007254	PIVOT PIN, CADDY	2	69	18891200	LOCKWASHER, 3/8	2
3	600190	LYNCH PIN	2	70	18436800	HEX. NUT, 3/8-16NC.	2
4	47997190	AXLE COMPLETE W/HUB L.H. (STD)	1	71	47002631	MANIFOLD STAND, (STD. TEE)	OPT.
	47007190	AXLE, LEFT HAND	1		47008060	MANIFOLD STAND, (S.S. TEE)	OPT.
5	47998190	AXLE COMPLETE W/HUB R.H. (STD)	1			(USE 1/2-13NC. HARDWARE)	
	47008190	AXLE, RIGHT HAND	1	72	47006545	U-BOLT, 1/2-13NC.	1
6	47996518	U-BOLT, 3/4-10NC. (GALV)	8	73	18891400	LOCKWASHER, 1/2	2
7	18981800	FLATWASHER, 3/4 (GALV)	8	74	18417400	HEX. NUT, 1/2-13NC.	2
8	18991800	LOCKWASHER, 3/4 (GALV)	16		47998031	HYDRAULIC LIFT ASSEMBLY	1
9	18998400	HEX. NUT, 3/4-10NC. (GALV)	16			INCLUDES ITEMS 75 TO 85	
10	47008712	HUB ASSEMBLY	2	75	47008031	CYLINDER BRACKET	1
11	47005816	RIM, 11 X 16.1 8 ON 8	2	76	18997456	BOLT, 1/2-13NC. X 5 1/2 (S.S.)	4
11A	47006023	RIM, 22.5 x 8.25 8 on 8	2	77	18991400	LOCKWASHER, 1/2 (S.S.)	4
12	20120012	VALVE STEM	2	78	18997400	HEX. NUT, 1/2-13NC. (S.S.)	4
12A	20120022	VALVE STEM	2	79	18541642	CLEVIS PIN, 5/8 X 2 1/2	1
13	32297	TIRE, 16.5L X 16.1 10PLY (36 psi)	2	80	18560722	COTTER PIN, 5/32 X 1	2
13A	179906	TIRE, 11X22.5 NYL 8 ON 8 (90 psi)	2	81	18541644	CLEVIS PIN, 5/8 X 3	1
	40012	WHEEL ASSY includes 11, 12, 13	2	82	47008016	LINK BUSHING	1
	40028	WHEEL ASSY includes 11A, 12A, 13A	2	83	47005437	HYDRAULIC CYLINDER ( 1 1/2 X 4)	1
14	47007193	HINGE BRACKET	1	84	2501-6-6	ELBOW, 90 DEG. 3/8MPT. X #6 MJIC	2
15	18057426	BOLT, 1/2-13NC. X 1 1/2	4	85	609222	HOSE, 1/4 X 222	2
16	18891400	LOCKWASHER, 1/2	4			#6 JICFS X 1/2 MPT ENDS	
17	18417400	HEX. NUT, 1/2-13NC.	4	86	47007138	SKID (550 GAL. TANK) (CROWN)	OPT.
18	47007200	PIVOT SHAFT	1			FOR HOOPS & HARDWARE SEE ITEMS 121 TO 126	
19	18056830	BOLT, 3/8-16NC. X 2	1	87	18057930	BOLT, 5/8-11NC. X 2	4
20	18457800	SELF-LOCKING NUT, 3/8-16NC.	1	88	18811600	FLATWASHER, 5/8	8
21	18901807	GREASE ZERK, 45 DEG.	1	89	18891600	LOCKWASHER, 5/8	4
22	47007201	GROUND WHEEL CONTROL	1	90	18417900	HEX. NUT, 5/8-11NC.	4
23	47007247	PIVOT BRACKET MOUNT	1	91	47008070	SKID (750 GAL TANK) (SNYDER)	OPT.
24	47996487	U-BOLT, 1/2-13NC. (GALV)	2			MOUNT WITH HARDWARE ITEMS 87 TO 90	
25	18991500	LOCKWASHER, 1/2 (GALV)	4	92	47008465	VALVE SUPPORT BRACKET	1
26	18997500	HEX. NUT, 1/2-13NC. (GALV)	4	93	18056822	BOLT, 3/8-16NC. X 1	2
27	47007250	PIVOT BRACKET	1	94	18496800	FLANGE NUT, 3/8-16NC.	2
28	47007251	CLAMP PLATE	1		47028889	HOOP ASSEMBLY FOR SKID ITEM 91	3
29	18541566	CLEVIS PIN, 3/4 X 3 1/2	1			(750 GAL. TANK)	
30	18590148	HAIRPIN BRIDGE (.148 DIA.)	1	95	47008889	HOOP (HALF)	6
31	18027417	BOLT, 1/2-13NC. X 2 (S.S.)	4	96	18057430	BOLT, 1/2-13NC. X 2	3
32	18991400	LOCKWASHER, 1/2 (S.S.)	4	97	18457650	SELF-LOCKING NUT, 1/2-13NC.	3
33	18997400	HEX. NUT, 1/2-13NC. (S.S.)	4	98	18057430	BOLT, 1/2-13NC. X 2	6
34	47007227	PIVOT LINK	1	99	18811400	FLATWASHER, 1/2	6
35	47007197	TRANSPORT LOCK PIN	1	100	18457650	SELF-LOCKING NUT, 1/2-13NC.	6
36	18590094	HAIRPIN BRIDGE (.177 DIA.)	1	101	47008018	SKID (725 GAL. NORWESCO TANK)	OPT.
37	18511033	EXPANSION PIN 1/4 X 1 1/2	1			(ALSO FITS 715 GAL. SNYDER TANK)	
38	47301547	EYE BOLT	1	102	47008464	VALVE SUPPORT BRACKET	1
39	18541428	CLEVIS PIN, 1/2 X 1 3/4	1	103	18056822	BOLT, 3/8-16NC. X 1	2
40	18560722	COTTER PIN, 5/32 X 1	1	104	18496800	FLANGE NUT, 3/8-16NC.	2
41	47301524	COMPRESSION SPRING	1	105	18058430	BOLT, 3/4-10NC. X 2	4
42	47301530	SPRING CAP	1	106	18811800	FLATWASHER, 3/4	8
43	18417900	HEX. NUT, 5/8-11NC.	2	107	18891800	LOCKWASHER, 3/4	4
44	18057426	BOLT, 1/2-13NC. X 1 1/2	4	108	18418400	HEX. NUT, 3/4-10NC.	4
45	18891400	LOCKWASHER, 1/2	4		47028012	HOOP ASSEMBLY FOR SKID ITEM 101	3
46	18417400	HEX. NUT, 1/2-13NC.	4			(725 GAL. TANK)	
47	47008462	BEARING ASSEMBLY, 1"	2	109	47008012	HOOP (HALF) MOUNT WITH	6
48	18057934	BOLT, 5/8-11NC. X 2 1/2	1			HARDWARE ITEMS 96 TO 100	
49	34318	IDLER SPROCKET	1	110	47008461	SKID (535 GAL. TANK) (ACE R-M)	OPT.
50	18811600	FLATWASHER, 5/8	3			MOUNT WITH HARDWARE ITEMS 105 TO 108	
51	18891600	LOCKWASHER, 5/8	1	111	47008458	VALVE SUPPORT BRACKET	1
52	18417900	HEX. NUT, 5/8-11NC.	1	112	47008457	END STOP PLATE	1
53	47007266	DRIVE SHAFT	1	113	18056822	BOLT, 3/8-16NC. X 1	4
54	10342	DRIVE SPROCKET	1	114	18496800	FLANGE NUT, 3/8-16NC.	4
55	47006519	DRIVE KEY, 1/4 X 1/4 X 1 1/2	2	115	47008455	TANK BAND	2
56	47007268	DRIVE CHAIN, #50 X 96 LINKS	1	116	18706621	TRUSS HD. BOLT, 3/8 X 3/4 S.S.	8
57	31212	CONNECTING LINK	1	117	18496800	FLANGE NUT, 3/8-16NC.	8
58	47007068	HUB, PUMP DRIVE WHEEL	1	118	47008456	BAND END BRACKET	4
59	44105518	DRIVE WHEEL ASSEMBLY (40 psi)	1	119	18057430	BOLT, 1/2-13NC. X 2	8
60	47005011	WHEEL NUT, 1/2-20NF.	4	120	18497400	FLANGE NUT, 1/2-13NC.	8
61	30481	DECAL, CAUTION (TIGHTEN LUG NUTS)	1		47019267	HOOP ASSEMBLY FOR SKID ITEM 86	2
	47997219	PIVOT CONTROL ROD COMPLETE				(550 GAL. TANK)	
		INCLUDES ITEMS 62 TO 64		121	47999267	HOOP HALF	4
62	47007219	PIVOT CONTROL ROD	1	122	18057934	BOLT, 5/8-11NC. X 2 1/2	6
63	47007220	CLEVIS, PIVOT ROD	1	123	18457900	NUT, SELF-LOCKING, 5/8-11NC.	2
64	18449003	HEX. JAM NUT, 3/4-10NC.	1	124	18811600	FLATWASHER, 5/8	4
65	18541835	CLEVIS PIN, 3/4 X 2 1/2	2	125	18891600	LOCKWASHER, 5/8	4
66	18590148	HAIRPIN BRIDGE, (.148 DIA.)	2	126	18417900	HEX. NUT, 5/8-11NC.	4
67	47008049	MANIFOLD BRACKET (USE 3/8 HDWR) OPT.					

# 6000/6200 SERIES LIQUID APPLICATION PLUMBING (MANIFOLD METHOD)

6000L002  
10-17-12  
REV 06-23-15

AVAILABLE TANKS (ITEM 13)

1004337 LEG TANK, 715 GAL (SNYDER)

FOR 6200 CADDY

W 7500 LB CAPACITY AXLES ONLY

7541137 LEG TANK, 1000 GAL (SNYDER)

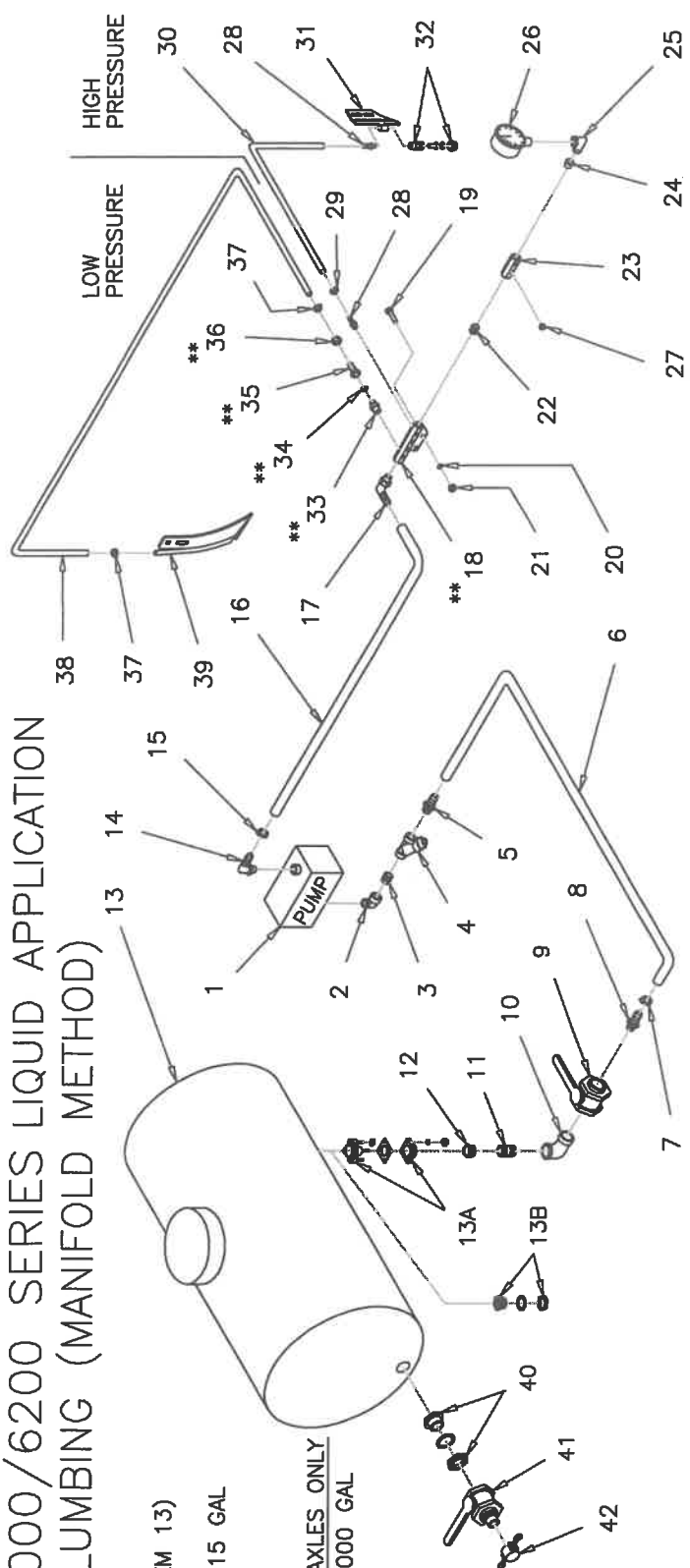

ITEM	PART NO.	DESCRIPTION	QTY.	ITEM	PART NO.	DESCRIPTION	QTY.
1	NGP-7055	PUMP ASSEMBLY, SINGLE PISTON	1	25	200771	STREET ELBOW, 1/4 NPT. X 90	1
2	NGP-9055	PUMP ASSEMBLY TWIN PISTON	OPT.	26	100347	PRESSURE GAUGE, 0 TO 160 PSI	1
3	200888	STREET ELBOW, 1 1/2 NPT X 90	1	27	200826	PLUG, 1/4 NPT. S.S. AS REQ'D. *	1
4	200556	CLOSE NIPLLE, 1 1/2 NPT.	1	ITEMS 28 TO 32 USE FOR HI-PRESS. APPLICATION ONLY*			
5	200056	LINE STRAINER, 1 1/2 X 1 1/2 NPT.	1	28	100859	HOSEBARB, 1/4 NPT. X 1/2 S.S.	2
6	200334	HOSEBARB, 1 1/2 X 1 1/2	1	29	200244	HOSE CLAMP, 5/16 TO 7/8	2
7	12012705	SOLUTION HOSE, 1 1/2 X 72"	1	30	100804	HOSE, BRAIDED 1/2 X 85 FT (8 ROW) 1/2 X 135 FT. (11 ROW) 1/2 X 150 FT (12 ROW)	1
8	200256	HOSE CLAMP, 1 5/16 TO 2 1/4	2	31	47309038	NOZZLE BRACKET	1
9	200334	HOSEBARB, 1 1/2 X 1 1/2	1	32	504017	NOZZLE BODY, INCLUDES (1) EACH OF	1
10	201150	BALL VALVE, 1 1/2 NPT	1	500192	NOZZLE BODY ADAPTER	1	
11	215090	STREET ELBOW, 1 1/2 NPT	1	504015	NOZZLE BODY ADAPTER	1	
12	200556	CLOSE NIPLLE, 1 1/2 NPT	1	504015	STREAM STABILIZER	1	
13	200422	REDUCING BUSHING, 2 X 1 1/2 NPT	1	503127	SELECT FROM ORIFICE CHART	1	
13A	290387	AS SPECIFIED, SEE LIST ABOVE	1	503127	CAP	1	
13B	290387	BOLT-IN FLANGE ASSEMBLY, 2 NPT.	1	ITEMS 33 TO 39 USE FOR LO-PRESS. APPLICATION ONLY			
14	501591	SUPPLIED WITH TANK	1	33	500192	NOZZLE BODY ADAPTER	1
15	OBSOLETE	BULKHEAD ASSEMBLY, 1 1/2 NPT	1	34	ORIFICE	SELECT FROM ORIFICE CHART	1
16	200380	SHOWN FOR REPAIR PART ONLY	1	35	500643	HOSEBARB INSERT	1
17	200248	HOSEBARB ELBOW, 1 X 1	1	36	503127	CAP, HOSEBARB	1
18	10040000	HOSE CLAMP, 1 1/16 TO 1 1/2	2	37	200244	HOSE CLAMP, 5/16 TO 7/8	2
19	200367	SPRAYER HOSE, 1 X 156"	1	38	15017007	TUBING, 1/2 X 85 FT. (8 ROW) 1/2 X 150 FT. (12 ROW)	1
20	47008033	HOSEBARB ELBOW, 1/2 NPT. X 1	1	39	KNIFE	AS SPECIFIED	1
21	18026824	MANIFOLD, (8) PORT, S.S.	* 1	212600	FORCE-FILL PACKAGE	OPT.	
22	18881201	BOLT, 3/8-16NC. X 1 1/4 S.S.	2	20020019	INCL. ITEMS, 40 TO 42	1	
23	18476800	3/8 LOCKWASHER, S.S.	2	41	200037	TANK BUNG, 2"	1
24	200714	HEX. NUT, 3/8-16NC. S.S.	2	42	200172	BALL VALVE, 2 NPT CAP, 2 NPT.	1
25	200714	CLOSE NIPLLE, 1/2 NPT. S.S.	OPT.				
26	47008035	MANIFOLD, (4) PORT, S.S.	OPT.				
27	200810	REDUCING BUSHING, 1/2 X 1/4 NPT.	1				

FOR ALTERNATE GAUGE MOUNTINGS, REFER TO THE "MANIFOLD ASSEMBLY ILLUSTRATIONS".

QUANTITIES MARKED \* ARE FOR ONE NOZZLE ONLY. REFER TO THE "MANIFOLD ASSEMBLY ILLUSTRATIONS" TO DETERMINE ACTUAL QUANTITIES FOR YOUR TOOLBAR.

FOR NYLON MANIFOLD INFO ITEM 18 MARKED \*\* AND ITEMS 33,34,35, & 36 MARKED \* REFER TO THE "NYLON" MANIFOLD ASSEMBLY ILLUSTRATION.



**LIQUID PLUMBING**  
**6000 SERIES APPLICATORS**  
**NON-MANIFOLD PLUMBING**  
**(SPRAY-BOOM STYLE)**  
**HIGH PRESSURE SYSTEM**

6000LQAPP2  
 10-18-12  
 REV 06-23-15

TANK REFERENCE CHART (ITEM 13)  
 AVAILABLE TANKS (ITEM 13)  
 1004337 LEG TANK, 715 GAL.  
 (SNYDER)

APPLICATION RATE  
 THIS METHOD IS USED FOR  
 UP TO MAX 30 GAL/ ACRE

QUANTITIES MARKED \*  
 ARE FOR ONE ROW ONLY.

REFER TO THE PLUMBING LAYOUT  
 TO DETERMINE ACTUAL  
 QUANTITIES REQ'D FOR YOUR  
 TOOLBAR DEPENDING ON  
 THE NUMBER OF ROWS.

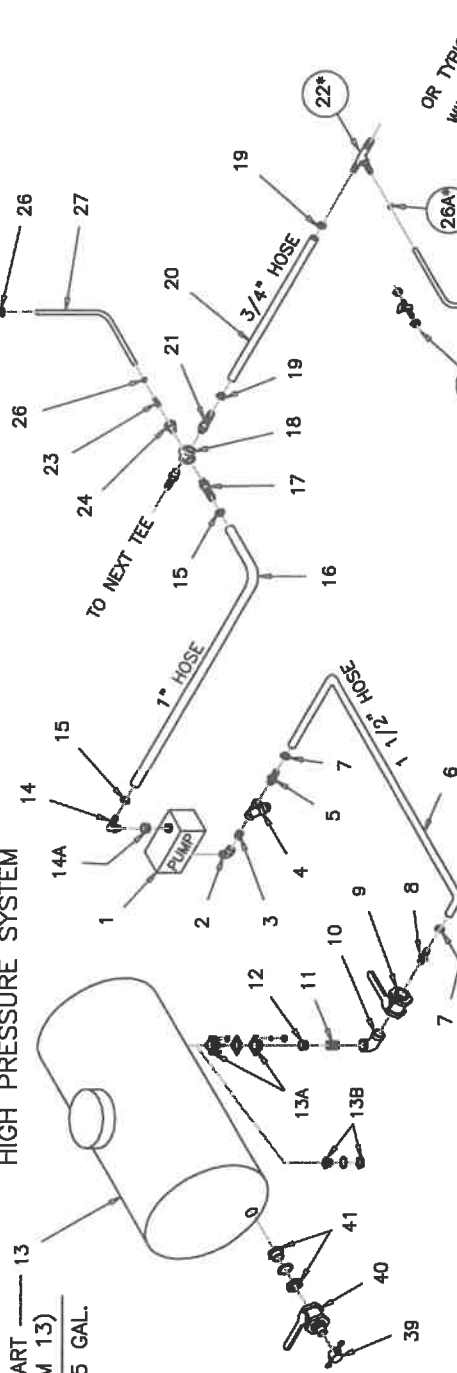

ITEM	PART NO.	DESCRIPTION	QTY.
1	NGP-7055	PUMP ASSY, HI-PRESS. SGL PISTON	1
	NGP-9055	PUMP ASSY, HI-PRESS. DBL PISTON	OPT
2	606200	TANK TO PUMP PLUMBING PACKAGE	1
		INCLUDES ITEMS 2 THRU 12	
3	215090	STREET ELBOW, 1/2" NPT X 90	1
4	200556	CLOSE NIPPLE, 1/2" NPT.	1
5	200056	LINE STRAINER, 1/2" X 1/2" NPT.	1
6	12012705	SOLUTION HOSE, 1/2" X 1/2" X 6 FT LONG	1
7	200256	HOSE CLAMP, 1/5/16 TO 2 1/4"	2
8	200334	HOSEBARB, 1/2" X 1/2"	1
9	201150	BALL VALVE, 1/2" NPT	1
10	215090	STREET ELBOW 1/2" NPT	1
11	200556	CLOSE NIPPLE 1/2" NPT	1
12	200422	REDUCER BUSHING 2" X 1 1/2" NPT	1
13	TANK	(SEE AVAILABLE TANKS CHART)	1
13A	290387	BOLT-IN FLANGE ASSEMBLY, 2" NPT (SUPPLIED WITH TANK)	1
13B	501591	BULKHEAD ASSEMBLY, 1 1/2" NPT	1
14	OBSOLETE, SHOWN HERE FOR REPAIR PARTS ONLY		
14A	200360	HOSEBARB ELBOW, 1" X 1"	1
15	2150100	REDUCER BUSHING, 1 1/2" - 1"	1
16	200250	HOSE CLAMP, 3/4" - 1 3/4"	2
17	10040000	SPRAYER HOSE 1" X 20 FT LONG	1
18	250100	HOSEBARB, POLY 1" NPT X 1" HOSE	1
19	200250	POLY CROSS, 1 INCH NPT	1
20	200228	HOSECLAMP, 1 11/16" (7 ROW)	2*
		HOSE, 3/4" ID X 14 FT. (8 ROW)	
		HOSE, 3/4" ID X 15 FT. (9 ROW)	
		HOSE, 3/4" ID X 17 FT. (10 ROW)	
		HOSE, 3/4" ID X 19 FT. (11 ROW)	
		HOSE, 3/4" ID X 23 FT. (12 ROW)	
		HOSE, 3/4" ID X 27 FT. (13 ROW)	
21	HB100-075	HOSEBARB, POLY 1" X 3/4" HOSE	2
22	HB075-050	HOSEBARB TEE	1*
23	HB025-050	HOSEBARB POLY, 1/4" MPT X 1/2" HB	1
606200	TANK TO PUMP PKG	(includes items 2 thru 12)	1

AVAILABLE PUMP PACKAGES

NGP-7055 HI-PRESS. JBLUE SGL PISTON  
 NGP-9055 HI-PRESS. JBLUE TWIN PISTON  
 212600 FORCEFILL PKG INCLUDES ITEMS 39 THRU 41

ITEM	PART NO.	DESCRIPTION	QTY.
24	2100025	REDUCER BUSHING, POLY 1" X 1/4"	1
25	200376	HOSEBARB ELBOW, 3/4" NPT X 3/4"	2
25A	200449	FEMALE HOSEBARB 3/4" NPT X 1/2"	2
26	200244	HOSE CLAMP, 7/16 - 1" (4 per row)	4*
26A	200244	TUBING, BRAIDED EVA 1/2" X 10 FT	4*
27	100804	PRESSURE GAUGE, 0 TO 160 PSI	1
28	100347	HOSEBARB, 1/4" NPT X 1/2" SS	1
29	100859*	HOSE, BRAIDED 1/2" X 28 FT. (7 ROW)	1
		HOSE, BRAIDED 1/2" X 32 FT. (8 ROW)	
		HOSE, BRAIDED 1/2" X 36 FT. (9 ROW)	
		HOSE, BRAIDED 1/2" X 40 FT. (10 ROW)	
		HOSE, BRAIDED 1/2" X 44 FT. (11 ROW)	
		HOSE, BRAIDED 1/2" X 48 FT. (12 ROW)	
31	47309038	NOZZLE BRACKET	1
32	504017	NOZZLE ASSY, INCLUDES (1) EACH OF	1
	500192	NOZZLE BODY	1
	504015	STREAM STABILIZER	1
	ORIFICE	SELECT FROM ORIFICE CHART	1
	503127	CAP	1
33	115286-01	CHECKVALVE, POLY	1
34	100804	TUBING, BRAIDED EVA 1/2" X 1 FT	1
35	100859	HOSEBARB, 1/4" NPT X 1/2" SS	1
36	47306661	SHIM, 1/4" X 2" X 4 1/2"	1
	47306662	SHIM, 1/8" X 2" X 4 1/2"	1
	47306663	SHIM, 1/4" X 2" X 4 1/2"	1
37	500553	COMBO WING SHUTOFF VALVE (per row)	OPT
38	200244	HOSE CLAMP, 7/16 - 1" (per row)	OPT
39	212600	FORCEFILL PKG (includes items 39 - 41)	OPT
40	200172	CAP	1
41	200337	BALL VALVE, 2" NPT	1
	20020019	TANK BUNG ASSEMBLY, 2 NPT.	1
42	18057434	BOLT, HEX HD 1/2" X 2 1/2" GR 5	2*
43	18417400	NUT, HEX, 1/2" NC ZC	2*
44	18811400	FLATWASHER, USS ZC 1/2"	4*
45	18891400	WASHER, LOCK 1/2" ZC	2*
	609643	CABLE TIES 28" (NOT SHOWN)	2*
	4455	CHART, Slide Rule INJ (not shown)	1

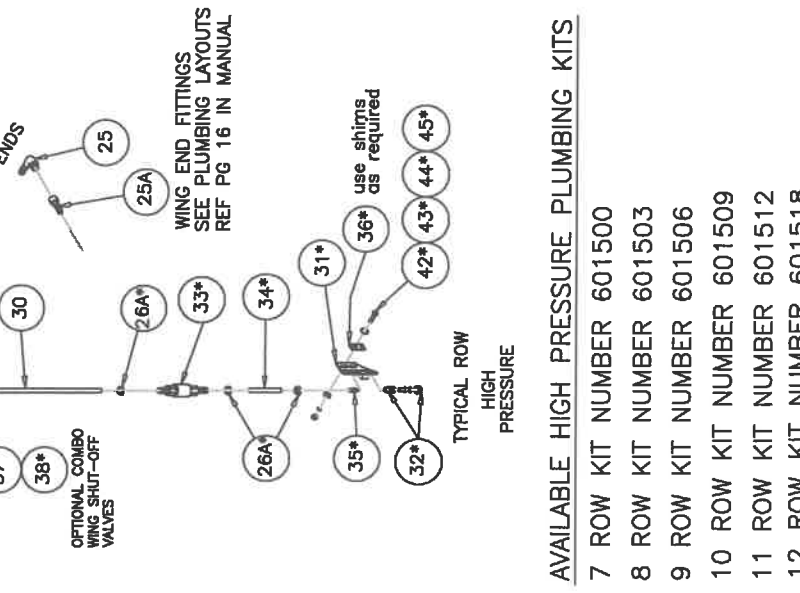

AVAILABLE HIGH PRESSURE PLUMBING KITS

7	ROW KIT NUMBER	601500
8	ROW KIT NUMBER	601503
9	ROW KIT NUMBER	601506
10	ROW KIT NUMBER	601509
11	ROW KIT NUMBER	601512
12	ROW KIT NUMBER	601518

AVAILABLE PUMP PLUMBING PACKAGE  
 20026000 JBLUE PUMP PLUMBING PKG  
 SEE PAGE 16 FOR GENERAL TOOLBAR PLUMBING REFERENCE

# 6000 TOOLBAR 28 FT

6K30LQPLBG2  
PRO 10-10-12

NON-MANIFOLD HIGH PRESSURE METHOD  
GENERAL LIQUID PLUMBING LAYOUT  
(SPRAY-BOOM METHOD SHOWN)  
AG37 COULTERS AT 30 INCH SPACING  
(11 ROWS AT 30" SPACING SHOWN)

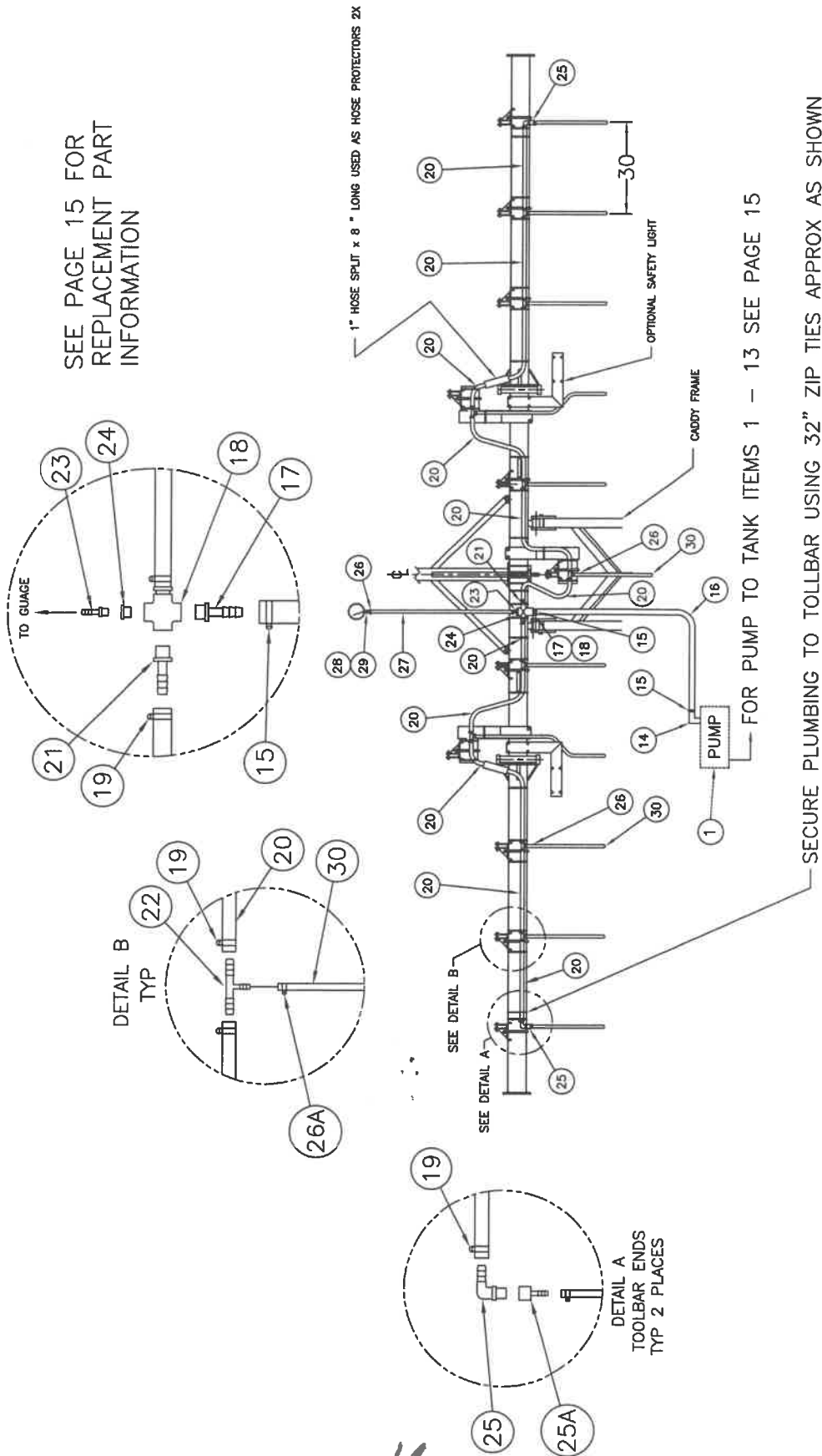

NOTE: MAKE SURE HOSES DON'T RUB ON FRAME WHEN FOLDING OR PREMATURE WEAR-THRU MAY OCCUR.  
HOSES NEAR HINGED AREAS SHOULD BE SLIGHTLY LONGER TO ALLOW FOR FOLDING  
BE SURE HOSES CLEAR PROPERLY AND DO NOT KINK OR HANG UP WHEN FOLDING.

**Application Information Using 4916 Orifice Plates**  
**(Table based on spraying 28% Nitrogen on 22 inch spacings)**  
**\*\*see conversion tables below for other weight solutions**

Orifice Plate No.	Pressure (psi)	Capacity Spraying 28% Nitrogen (GPM)	GPA Spraying 28% Nitrogen on 22 inch spacing			
			3 mph	4 mph	5 mph	6 mph
4916-37	60	0.18	16.6	12.5	10.0	8.3
	80	0.21	18.9	14.2	11.3	9.5
	90	0.23	21	15.5	12.4	10.4
	100	0.24	22	16.2	13.0	10.8
	120	0.26	23	17.6	14.0	11.7
4916-40	60	0.22	19.8	14.9	11.9	9.9
	80	0.25	23	16.9	13.5	11.3
	90	0.27	24	18.2	14.6	12.2
	100	0.28	25	18.9	15.1	12.6
	120	0.31	28	21	16.7	14.0
4916-43	60	0.25	22	16.8	13.4	11.2
	80	0.29	26	20	15.7	13.1
	90	0.30	27	20	16.2	13.5
	100	0.32	29	22	17.3	14.4
	120	0.35	32	24	18.9	15.8
4916-47	60	0.30	27	20	16.0	13.3
	80	0.34	31	23	18.4	15.3
	90	0.36	32	24	19.4	16.2
	100	0.38	34	26	21	17.1
	120	0.42	38	28	23	18.9
4916-49	60	0.32	29	21	17.2	14.3
	80	0.37	33	25	20	16.7
	90	0.39	35	26	21	17.6
	100	0.41	37	28	22	18.5
	120	0.45	41	30	24	20
4916-52	60	0.36	32	24	19.5	16.2
	80	0.42	38	28	23	18.9
	90	0.44	40	30	24	20
	100	0.47	42	32	25	21
	120	0.51	46	34	28	23
4916-55	60	0.41	37	27	22	18.3
	80	0.47	42	32	25	21
	90	0.50	45	34	27	23
	100	0.52	47	35	28	24
	120	0.57	51	38	31	26
4916-56	60	0.43	39	29	23	19.4
	80	0.50	45	34	27	23
	90	0.53	48	36	29	24
	100	0.56	50	38	30	25
	120	0.61	55	41	33	27
4916-59	60	0.47	42	31	25	21
	80	0.54	49	36	29	24
	90	0.57	51	38	31	26
	100	0.60	54	41	32	27
	120	0.66	59	45	36	30
4916-61	60	0.50	45	34	27	23
	80	0.58	52	39	31	26
	90	0.61	55	41	33	27
	100	0.65	59	44	35	29
	120	0.71	64	48	38	32

Orifice Plate No.	Pressure (psi)	Capacity Spraying 28% Nitrogen (GPM)	GPA Spraying 28% Nitrogen on 22 inch spacing			
			3 mph	4 mph	5 mph	6 mph
4916-65	60	0.56	51	38	30	25
	80	0.65	59	44	35	29
	90	0.69	62	47	37	31
	100	0.73	66	49	39	33
	120	0.80	72	54	43	36
4916-68	60	0.62	55	42	33	28
	80	0.71	64	48	38	32
	90	0.75	68	51	41	34
	100	0.80	72	54	43	36
	120	0.87	78	59	47	39
4916-70	60	0.66	59	44	36	30
	80	0.76	68	51	41	34
	90	0.81	73	55	44	36
	100	0.85	77	57	46	38
	120	0.93	84	63	50	42
4916-75	60	0.75	67	50	40	34
	80	0.86	77	58	46	39
	90	0.92	83	62	50	41
	100	0.97	87	65	52	44
	120	1.06	95	72	57	48
4916-80	60	0.85	77	58	46	38
	80	0.99	89	67	53	45
	90	1.05	95	71	57	47
	100	1.10	99	74	59	50
	120	1.21	109	82	65	54
4916-83	60	0.97	87	65	52	44
	80	1.12	101	76	60	50
	90	1.19	107	80	64	54
	100	1.25	113	84	68	56
	120	1.37	123	92	74	62
4916-89	60	1.06	95	71	57	48
	80	1.22	110	82	66	55
	90	1.29	116	87	70	58
	100	1.36	122	92	73	61
	120	1.49	134	101	80	67
4916-93	60	1.18	106	80	64	53
	80	1.36	122	92	73	61
	90	1.44	130	97	78	65
	100	1.52	137	103	82	68
	120	1.67	150	113	90	75
4916-95	60	1.23	111	83	67	55
	80	1.42	128	96	77	64
	90	1.51	136	102	82	68
	100	1.59	143	107	86	72
	120	1.74	157	117	94	78
4916-98	60	1.35	121	91	73	61
	80	1.55	140	105	84	70
	90	1.65	149	111	89	74
	100	1.74	157	117	94	78
	120	1.90	171	128	103	86

Orifice Plate No.	Pressure (psi)	Capacity Spraying 28% Nitrogen (GPM)	GPA Spraying 28% Nitrogen on 22 inch spacing			
			3 mph	4 mph	5 mph	6 mph
4916-103	60	1.41	127	95	76	63
	80	1.63	147	110	88	73
	90	1.72	155	116	93	77
	100	1.82	164	123	98	82
	120	1.99	179	134	107	90
4916-107	60	1.58	143	107	86	71
	80	1.83	165	124	99	82
	90	1.94	175	131	105	87
	100	2.04	184	138	110	92
	120	2.24	202	151	121	101
4916-110	60	1.32	119	89	71	59
	80	1.52	137	103	82	68
	90	1.62	146	109	87	73
	100	1.70	153	115	92	77
	120	1.87	168	126	101	84
4916-115	60	1.85	166	125	100	83
	80	2.13	192	144	115	96
	90	2.26	203	153	122	102
	100	2.39	215	161	129	108
	120	2.61	235	176	141	117
4916-125	60	2.11	190	143	114	95
	80	2.44	220	165	132	110
	90	2.59	223	175	140	117
	100	2.73	246	184	147	123
	120	2.99	269	202	161	135
4916-132	60	2.36	212	159	127	106
	80	2.72	245	184	147	122
	90	2.89	260	195	156	130
	100	3.04	274	205	164	137
	120	3.34	301	225	180	150
4916-140	60	2.73	246	184	147	123
	80	3.15	284	213	170	142
	90	3.34	301	225	180	150
	100	3.52	317	238	190	158
	120	3.86	347	261	208	174
4916-147	60	2.97	268	201	161	134
	80	3.43	309	232	185	154
	90	3.64	328	246	197	164
	100	3.84	346	259	207	173
	120	4.21	379	284	227	189
4916-156	60	3.34	301	226	181	150
	80	3.86	347	261	208	174
	90	4.10	369	277	221	185
	100	4.32	389	292	233	194
	120	4.73	426	319	255	213
4916-166	60	3.70	333	249	200	166
	80	4.27	384	288	231	192
	90	4.53	408	306	245	204
	100	4.77	429	322	258	215
	120	5.23	471	353	282	235

**\*\*Conversion Factors for Spraying Solutions other than 28% Nitrogen for use only with the Above GPA tables**

Weight of Solution	Conversion Factor
7.0 lbs./gal.	0.81
8.0 lbs./gal.	0.87
8.34 lbs./gal. - Water	0.88
9.0 lbs./gal.	0.92
10.0 lbs./gal.	0.97

Weight of Solution	Conversion Factor
10.65 lbs./gal. - 28% N	1.00
11.00 lbs./gal.	1.01
12.0 lbs./gal.	1.06
14.0 lbs./gal.	1.14

**Application Information Using 4916 Orifice Plates**  
**(Table based on spraying 28% Nitrogen on 30 inch spacings)**  
**\*\*see conversion tables below for other weight solutions**

Orifice Plate No.	Pressure (psi)	Capacity Spraying 28% Nitrogen (GPM)	GPA Spraying 28% Nitrogen on 30 inch spacing				
			3 mph	4 mph	5 mph	6 mph	
4916-37	60	0.18	12.2	9.1	7.3	6.1	
	80	0.21	13.9	10.4	8.3	6.9	
	90	0.23	15.2	11.4	9.1	7.6	
	100	0.24	15.8	11.9	9.5	7.9	
4916-40	120	0.26	17.2	12.9	10.3	8.6	
	60	0.22	14.5	10.9	8.7	7.3	
	80	0.25	16.5	12.4	8.9	8.3	
	90	0.27	17.8	13.4	10.7	8.9	
4916-43	100	0.28	18.5	13.9	11.1	9.2	
	120	0.31	20	15.3	12.3	10.2	
	60	0.25	16.4	12.3	9.8	8.2	
	80	0.29	19.1	14.4	11.5	9.6	
4916-47	90	0.30	20	14.9	11.9	9.9	
	100	0.32	21	15.8	12.7	10.6	
	120	0.35	23	17.3	13.9	11.6	
	60	0.30	20	14.6	11.7	9.8	
4916-49	80	0.34	22	16.8	13.5	11.2	
	90	0.36	24	17.8	14.3	11.9	
	100	0.38	25	18.8	15.0	12.5	
	120	0.42	28	21	16.6	13.9	
4916-52	60	0.32	21	15.7	12.6	10.5	
	80	0.37	24	18.3	14.7	12.2	
	90	0.39	26	19.3	15.4	12.9	
	100	0.41	27	20	16.2	13.5	
4916-55	120	0.45	30	22	17.8	14.9	
	60	0.36	24	17.9	14.3	11.9	
	80	0.42	28	21	16.6	13.9	
	90	0.44	29	22	17.4	14.5	
4916-56	100	0.47	31	23	18.6	15.5	
	120	0.51	34	25	20	16.8	
	60	0.41	27	20	16.1	13.4	
	80	0.47	31	23	18.6	15.5	
4916-59	90	0.50	33	25	20	16.5	
	100	0.52	34	26	21	17.2	
	120	0.57	38	28	23	18.8	
	60	0.43	28	21	17.1	14.2	
4916-61	80	0.50	33	25	20	16.5	
	90	0.53	35	26	21	17.5	
	100	0.56	37	28	22	18.5	
	120	0.61	40	30	24	20	
4916-66	60	0.47	31	23	18.5	15.4	
	80	0.54	36	27	21	17.8	
	90	0.57	38	28	23	18.8	
	100	0.60	40	30	24	20	
4916-70	120	0.66	44	33	26	22	
	60	0.502	33	25	20	16.6	
	80	0.58	38	29	23	19.1	
	90	0.61	40	30	24	20	
4916-75	100	0.65	43	32	26	21	
	120	0.71	47	35	28	23	
	60	0.52	34	26	21	17.2	
	80	0.59	39	29	23	18.6	
4916-80	90	0.62	41	31	24	20	
	100	0.65	43	32	25	21	
	120	0.71	47	35	28	23	
	60	0.55	37	28	22	18.5	
4916-83	80	0.62	41	31	24	20	
	90	0.65	43	32	25	21	
	100	0.69	46	34	27	23	
	120	0.73	48	36	29	24	
4916-89	60	0.80	53	40	32	26	
	80	0.87	57	43	34	29	
	90	0.91	60	45	36	31	
	100	0.95	64	48	38	32	
4916-93	120	1.06	70	52	42	35	
	60	0.85	56	42	34	28	
	80	0.99	65	49	39	33	
	90	1.05	69	52	42	35	
4916-98	100	1.10	73	54	44	36	
	120	1.21	80	60	48	40	
	60	0.97	64	48	38	32	
	80	1.12	74	55	44	37	
4916-103	90	1.19	79	59	47	39	
	100	1.25	83	62	50	41	
	120	1.37	90	68	54	45	
	60	1.06	70	52	42	35	
4916-107	80	1.06	70	52	42	35	
	90	1.22	81	60	48	40	
	100	1.29	85	64	51	43	
	120	1.49	98	74	59	49	
4916-110	60	1.18	78	58	47	39	
	80	1.36	90	67	54	45	
	90	1.44	95	71	57	48	
	100	1.52	100	75	60	50	
4916-115	120	1.67	110	83	66	55	
	60	1.23	81	61	49	41	
	80	1.42	94	70	56	47	
	90	1.51	100	75	60	50	
4916-125	100	1.59	105	79	63	52	
	120	1.74	115	86	69	57	
	60	1.35	89	67	53	44	
	80	1.55	102	77	61	51	
4916-132	90	1.65	109	82	65	54	
	100	1.74	115	86	69	57	
	120	1.90	125	94	75	63	
	60	1.23	81	61	49	41	
4916-140	80	1.42	94	70	56	47	
	90	1.51	100	75	60	50	
	100	1.59	105	79	63	52	
	120	1.74	115	86	69	57	
4916-147	60	1.35	89	67	53	44	
	80	1.55	102	77	61	51	
	90	1.65	109	82	65	54	
	100	1.74	115	86	69	57	
4916-156	120	1.90	125	94	75	63	
	60	1.35	89	67	53	44	
	80	1.55	102	77	61	51	
	90	1.65	109	82	65	54	
4916-166	100	1.74	115	86	69	57	
	120	1.90	125	94	75	63	
	60	1.35	89	67	53	44	
	80	1.55	102	77	61	51	

Orifice Plate No.	Pressure (psi)	Capacity Spraying 28% Nitrogen (GPM)	GPA Spraying 28% Nitrogen on 30 inch spacing				
			3 mph	4 mph	5 mph	6 mph	
4916-103	60	1.41	93	70	56	46	
	80	1.63	108	81	65	54	
	90	1.72	114	85	68	57	
	100	1.82	120	90	72	60	
4916-107	120	1.99	131	99	79	66	
	60	1.58	105	78	63	52	
	80	1.83	121	91	72	60	
	90	1.94	128	96	77	64	
4916-110	100	2.04	135	101	81	67	
	120	2.24	148	111	89	74	
	60	1.32	87	65	52	44	
	80	1.52	100	75	60	50	
4916-115	90	1.62	107	80	64	53	
	100	1.70	112	84	67	56	
	120	1.87	123	93	74	62	
	60	1.85	122	91	73	61	
4916-125	80	2.13	141	105	84	70	
	90	2.26	149	112	89	75	
	100	2.36	158	118	95	79	
	120	2.61	172	129	103	86	
4916-132	60	2.11	139	105	84	70	
	80	2.44	161	121	97	81	
	90	2.59	171	128	103	85	
	100	2.73	180	135	108	90	
4916-140	120	2.99	197	148	118	99	
	60	2.36	156	117	93	78	
	80	2.72	180	135	108	90	
	90	2.89	191	143	114	95	
4916-147	100	3.04	201	150	120	100	
	120	3.34	220	165	132	110	
	60	2.73	180	135	106	90	
	80	3.15	208	156	125	104	
4916-156	90	3.34	220	165	132	110	
	100	3.52	232	174	139	116	
	120	3.86	255	191	153	127	
	60	2.97	196	147	118	98	
4916-166	80	3.43	226	170	136	113	
	90	3.64	240	180	144	120	
	100	3.84	253	190	152	127	
	120	4.21	278	208	167	139	
4916-166	60	3.34	221	166	132	110	
	80	3.86	255	191	153	127	
	90	4.10	271	203	162	135	
	100	4.32	285	214	171	143	
4916-166	120	4.73	312	234	187	156	
	60	3.70	244	183	146	122	
	80	4.27	282	211	169	141	
	90	4.53	299	224	179	149	
4916-166	100	4.77	315	236	189	157	
	120	5.23	345	259	207	173	

**\*\*Conversion Factors for Spraying Solutions other than 28% Nitrogen for use only with the Above GPA tables**

Weight of Solution	Conversion Factor
7.0 lbs./gal.	0.81
8.0 lbs./gal.	0.87
8.34 lbs./gal. - Water	0.88
9.0 lbs./gal.	0.92
10.0 lbs./gal.	0.97

Weight of Solution	Conversion Factor
10.65 lbs./gal. - 28% N	1.00
11.00 lbs./gal.	1.01
12.0 lbs./gal.	1.06
14.0 lbs./gal.	1.14

**Application Information Using 4916 Orifice Plates**  
 (Table based on spraying 28% Nitrogen on 38 inch spacings)  
 \*\*\*see conversion tables below for other weight solutions

Orifice Plate No.	Pressure (psi)	Capacity Spraying 28% Nitrogen (GPM)	GPA Spraying 28% Nitrogen on 38 inch spacing				Capacity Spraying 28% Nitrogen (GPM)	GPA Spraying 28% Nitrogen on 38 inch spacing			
			3 mph	4 mph	5 mph	6 mph		3 mph	4 mph	5 mph	6 mph
4916-103	60	1.41	75	56	44	37	1.41	75	56	44	37
	80	1.63	85	64	51	42		85	64	51	42
	90	1.72	90	67	54	45		90	67	54	45
	100	1.82	95	71	57	47		95	71	57	47
4916-107	60	1.68	83	62	50	41	1.68	83	62	50	41
	80	1.83	95	72	57	48		95	72	57	48
	90	1.94	101	76	61	51		101	76	61	51
	100	2.04	105	80	64	53		105	80	64	53
4916-110	60	1.32	69	52	41	34	1.32	69	52	41	34
	80	1.62	79	59	48	40		79	59	48	40
	90	1.62	84	63	51	42		84	63	51	42
	100	1.70	89	66	53	44		89	66	53	44
4916-115	60	1.85	96	72	58	48	1.85	96	72	58	48
	80	2.13	111	83	67	55		111	83	67	55
	90	2.28	118	88	71	59		118	88	71	59
	100	2.39	125	93	75	62		125	93	75	62
4916-125	60	2.11	110	83	68	55	2.11	110	83	68	55
	80	2.44	127	95	76	64		127	95	76	64
	90	2.59	135	101	81	67		135	101	81	67
	100	2.73	142	107	85	71		142	107	85	71
4916-132	60	2.36	123	92	74	61	2.36	123	92	74	61
	80	2.72	142	106	85	71		142	106	85	71
	90	2.89	151	113	90	75		151	113	90	75
	100	3.04	158	119	95	79		158	119	95	79
4916-140	60	3.34	174	131	104	87	3.34	174	131	104	87
	80	3.73	192	142	107	85		192	142	107	85
	90	3.86	201	151	112	90		201	151	112	90
	100	4.21	219	165	121	101		219	165	121	101
4916-147	60	2.97	155	116	93	77	2.97	155	116	93	77
	80	3.43	179	134	107	89		179	134	107	89
	90	3.64	190	142	114	85		190	142	114	85
	100	3.84	200	150	120	100		200	150	120	100
4916-156	60	3.34	174	131	105	87	3.34	174	131	105	87
	80	3.86	201	151	121	101		201	151	121	101
	90	4.10	214	160	128	107		214	160	128	107
	100	4.32	225	169	135	113		225	169	135	113
4916-166	60	3.70	248	185	148	123	3.70	248	185	148	123
	80	4.27	282	216	167	133		282	216	167	133
	90	4.63	306	236	177	142		306	236	177	142
	100	4.77	324	249	186	149		324	249	186	149

Orifice Plate No.	Pressure (psi)	Capacity Spraying 28% Nitrogen (GPM)	GPA Spraying 28% Nitrogen on 38 inch spacing				Capacity Spraying 28% Nitrogen (GPM)	GPA Spraying 28% Nitrogen on 38 inch spacing			
			3 mph	4 mph	5 mph	6 mph		3 mph	4 mph	5 mph	6 mph
4916-65	60	0.56	29	22	17.6	14.6	0.56	29	22	17.6	14.6
	80	0.65	34	25	20	16.9		34	25	20	16.9
	90	0.69	36	27	22	18.0		36	27	22	18.0
	100	0.73	38	29	23	19.0		38	29	23	19.0
4916-68	60	0.80	42	31	25	21	0.80	42	31	25	21
	80	0.92	49	37	28	22		49	37	28	22
	90	0.97	51	39	30	23		51	39	30	23
	100	1.06	55	41	33	24		55	41	33	24
4916-70	60	0.66	34	26	21	17.2	0.66	34	26	21	17.2
	80	0.76	40	30	24	19.8		40	30	24	19.8
	90	0.81	42	32	25	21		42	32	25	21
	100	0.85	44	33	27	22		44	33	27	22
4916-75	60	0.75	39	29	23	19.5	0.75	39	29	23	19.5
	80	0.86	45	34	27	22		45	34	27	22
	90	0.92	48	36	29	24		48	36	29	24
	100	0.97	51	38	30	25		51	38	30	25
4916-80	60	0.85	44	33	27	22	0.85	44	33	27	22
	80	0.99	52	39	31	26		52	39	31	26
	90	1.05	55	41	33	27		55	41	33	27
	100	1.10	57	43	34	29		57	43	34	29
4916-83	60	0.97	50	38	30	25	0.97	50	38	30	25
	80	1.12	58	44	35	29		58	44	35	29
	90	1.19	62	47	37	31		62	47	37	31
	100	1.25	65	49	39	33		65	49	39	33
4916-89	60	1.37	71	54	43	36	1.37	71	54	43	36
	80	1.52	80	61	48	38		80	61	48	38
	90	1.59	84	64	50	40		84	64	50	40
	100	1.67	87	65	52	44		87	65	52	44
4916-93	60	1.18	61	46	37	31	1.18	61	46	37	31
	80	1.38	71	53	43	35		71	53	43	35
	90	1.44	75	55	45	38		75	55	45	38
	100	1.52	79	59	48	40		79	59	48	40
4916-95	60	1.67	87	65	52	44	1.67	87	65	52	44
	80	1.92	100	76	60	48		100	76	60	48
	90	2.01	105	80	64	53		105	80	64	53
	100	2.10	110	84	66	54		110	84	66	54
4916-98	60	1.35	70	53	42	35	1.35	70	53	42	35
	80	1.55	81	61	48	40		81	61	48	40
	90	1.65	86	64	52	43		86	64	52	43
	100	1.74	91	68	54	45		91	68	54	45

Orifice Plate No.	Pressure (psi)	Capacity Spraying 28% Nitrogen (GPM)	GPA Spraying 28% Nitrogen on 38 inch spacing				Capacity Spraying 28% Nitrogen (GPM)	GPA Spraying 28% Nitrogen on 38 inch spacing			
			3 mph	4 mph	5 mph	6 mph		3 mph	4 mph	5 mph	6 mph
4916-37	60	0.18	9.6	7.2	5.8	4.8	0.18	9.6	7.2	5.8	4.8
	80	0.21	10.9	8.2	6.6	5.5		10.9	8.2	6.6	5.5
	90	0.23	12.0	9.0	7.2	6.0		12.0	9.0	7.2	6.0
	100	0.24	12.5	9.4	7.5	6.3		12.5	9.4	7.5	6.3
4916-40	60	0.26	13.5	10.2	8.1	6.8	0.26	13.5	10.2	8.1	6.8
	80	0.31	15.2	11.5	9.2	7.5		15.2	11.5	9.2	7.5
	90	0.33	16.4	12.5	10.0	8.3		16.4	12.5	10.0	8.3
	100	0.35	17.7	13.5	10.9	9.1		17.7	13.5	10.9	9.1
4916-43	60	0.25	12.9	9.7	7.8	6.5	0.25	12.9	9.7	7.8	6.5
	80	0.29	15.1	11.3	9.1	7.6		15.1	11.3	9.1	7.6
	90	0.30	15.6	11.7	9.4	7.8		15.6	11.7	9.4	7.8
	100	0.32	16.7	12.5	10.0	8.3		16.7	12.5	10.0	8.3
4916-47	60	0.30	16.4	11.6	9.2	7.7	0.30	16.4	11.6	9.2	7.7
	80	0.34	17.7	13.3	10.6	8.9		17.7	13.3	10.6	8.9
	90	0.36	18.8	14.1	11.3	9.4		18.8	14.1	11.3	9.4
	100	0.38	20.0	14.9	11.9	9.9		20.0	14.9	11.9	9.9
4916-49	60	0.42	18.2	13.7	10.9	9.1	0.42	18.2	13.7	10.9	9.1
	80	0.48	21.0	15.9	12.5	10.2		21.0	15.9	12.5	10.2
	90	0.50	22.2	16.6	13.3	11.1		22.2	16.6	13.3	11.1
	100	0.51	23.4	17.4	14.1	11.7		23.4	17.4	14.1	11.7
4916-52	60	0.36	18.8	14.1	11.3	9.4	0.36	18.8	14.1	11.3	9.4
	80	0.42	22.2	16.4	13.1	10.9		22.2	16.4	13.1	10.9
	90	0.44	23.4	17.2	13.8	11.5		23.4	17.2	13.8	11.5
	100	0.47	24.6	18.0	14.5	12.1		24.6	18.0	14.5	12.1
4916-55	60	0.51	27	20	15.9	13.3	0.51	27	20	15.9	13.3
	80	0.61	32	24	18.8	15.6		32	24	18.8	15.6
	90	0.63	34	26	20	16.3		34	26	20	16.3
	100	0.66	36	28	22	17.0		36	28	22	17.0
4916-56	60	0.43	22	16.9	13.5	11.2	0.43	22	16.9	13.5	11.2
	80	0.50	26	20	15.6	13.0		26	20	15.6	13.0
	90	0.53	28	21	16.6	13.8		28	21	16.6	13.8
	100	0.58	29	22	17.5	14.6		29	22	17.5	14.6
4916-59	60	0.61	32	24	19.1	15.9	0.61	32	24	19.1	15.9
	80	0.72	38	29	23.0	19					

# MANIFOLD ASSEMBLY ILLUSTRATION

WITH STAINLESS STEEL MANIFOLD

FOR LOW PRESSURE SYSTEM  
 REPLACE ITEM 7 WITH AN ASSEMBLY  
 OF ITEMS 8,9,10, AND 11

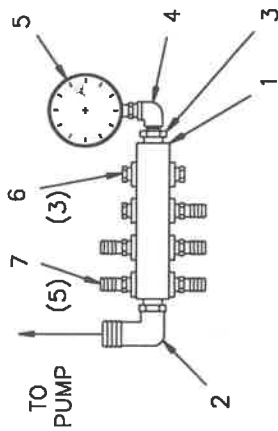
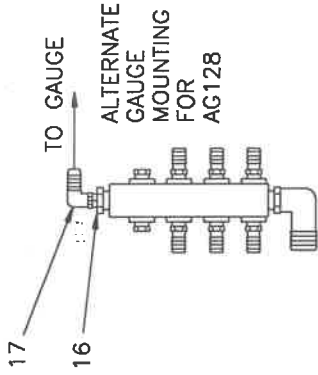
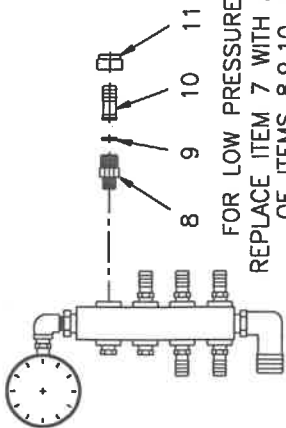

WITH 5 SHANKS

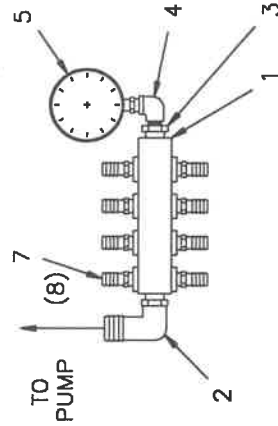

WITH 8 SHANKS

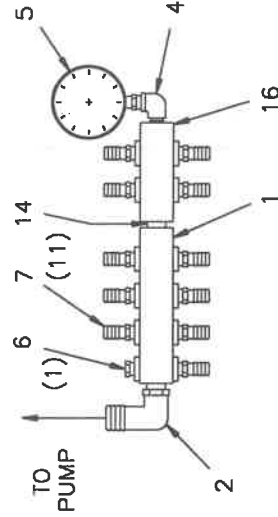

WITH 11 SHANKS

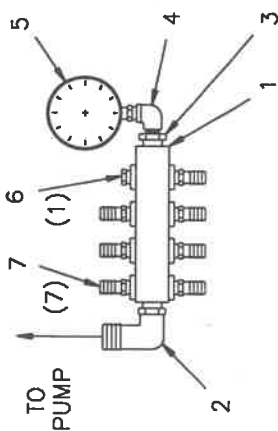

WITH 7 SHANKS

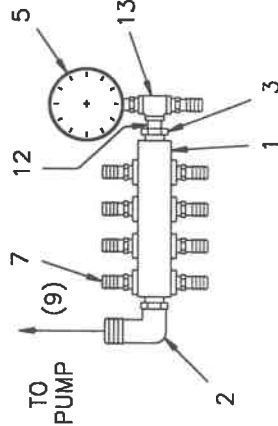

WITH 9 SHANKS

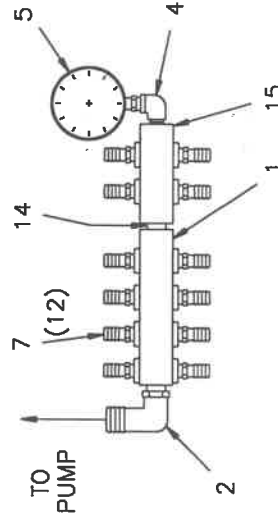

WITH 12 SHANKS

NO

ITEM	PART NO.	DESCRIPTION	QTY	ITEM	PART NO.	DESCRIPTION	QTY
1	47008033	MANIFOLD, 8 OUTLET	1	10	500643	HOSEBARB INSERT, 1/2" {LO-PRESSURE} *	*
2	200367	HOSEBARB ELBOW, 1/2 NPT. X 1	1	11	503127	CAP, HOSEBARB INSERT { ONLY }	*
3	200810	RED. BUSHING, 1/2 X 1/4 NPT.	*	12	200712	CLOSE NIPPLE, 1/4 NPT	1
4	200771	STREET ELBOW, 1/4 NPT. X 90	*	13	200786	TEE, 1/4 NPT.	1
5	500160	PRESSURE GAUGE, 0 TO 160	1	14	200714	CLOSE NIPPLE, 1/2 NPT.	1
6	200826	PLUG, 1/4 NPT.	*	15	47008035	MANIFOLD, (4) PORT	1
7	100859	HOSEBARB, 1/4 NPT. X 1/2	*	16	200810	RED. BUSHING, 1/2 X 1/4 NPT.	1
8	500192	ADAPTER, NOZZLE BODY {LO-PRESSURE} *	*	17	200348	HOSEBARB ELBOW, 1/4 NPT. X 1/2 (POLY)	1
9	ORIFICE	REFER TO ORIFICE CHART { ONLY }	*				

# MANIFOLD ASSEMBLY ILLUSTRATION

WITH NYLON MANIFOLD  
USED ON 6000 AND 6200  
SERIES APPLICATORS

FOR QUANTITIES ON ITEMS MARKED \*  
REFER TO THE ILLUSTRATION THAT  
SHOWS YOUR MANIFOLD ARRANGEMENT

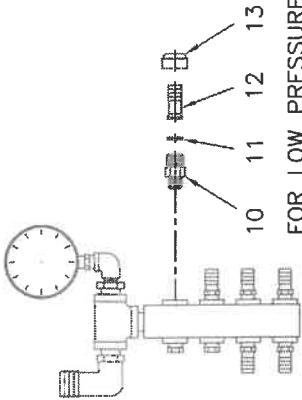

FOR LOW PRESSURE SYSTEM  
REPLACE ITEM 9 WITH AN ASSEMBLY  
OF ITEMS 10, 11, 12 AND 13

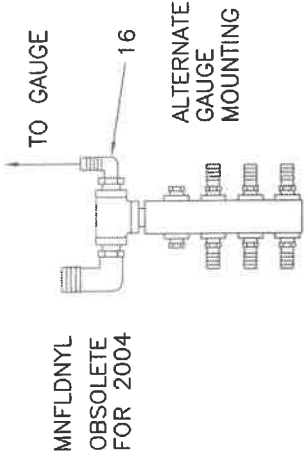

MNFDNYL  
OBSOLETE  
FOR 2004

ALTERNATE  
GAUGE  
MOUNTING

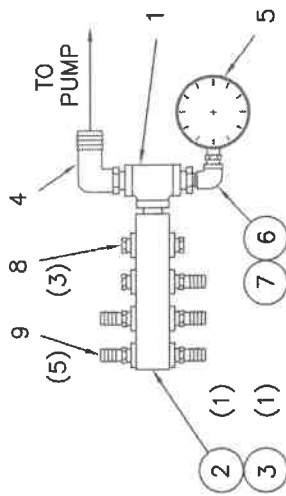

WITH 5 SHANKS

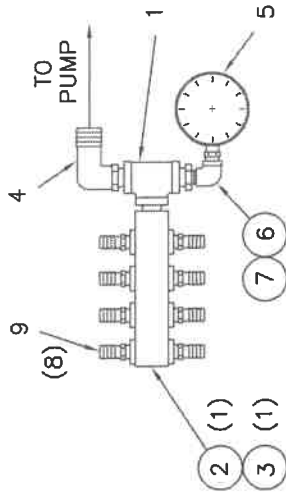

WITH 8 SHANKS

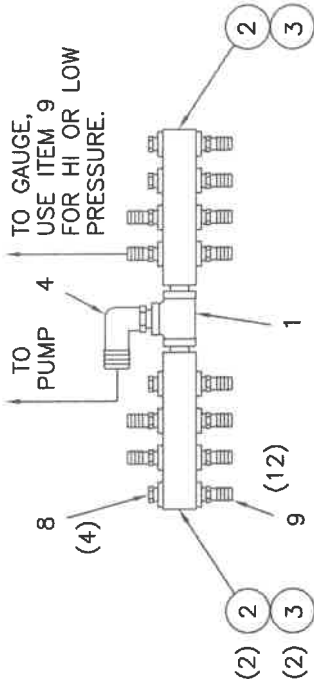

WITH 11 SHANKS

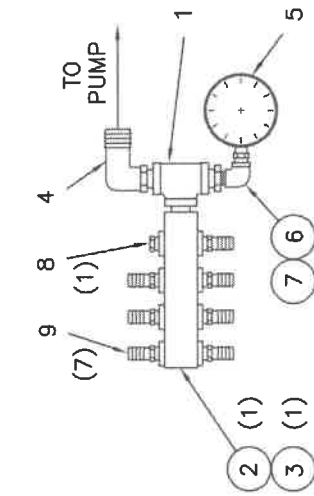

WITH 7 SHANKS

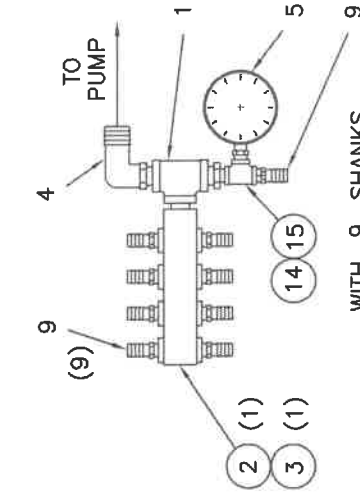

WITH 9 SHANKS

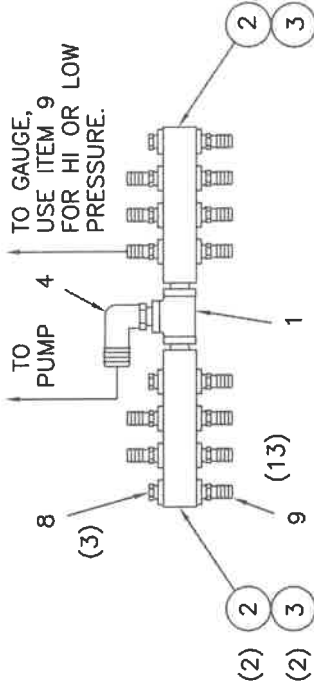

WITH 12 SHANKS

ITEM	PART NO.	DESCRIPTION	QTY	PART NO.	DESCRIPTION	QTY
1	47002631	MANIFOLD STAND, STANDARD	1	9	HOSEBARB, 1/4 NPT. X 1/2	*
2	47008060	MANIFOLD STAND, WITH S.S. TEE	OPT.	10	ADAPTER, NOZZLE BODY	*
3	200458	MANIFOLD, 8 OUTLET	*	11	REFER TO ORIFICE CHART	*
4	200714	CLOSE NIPPLE, 1/2 NPT. S.S.	*	12	HOSEBARB INSERT, 1/2" ONLY	*
5	200367	HOSEBARB ELBOW, 1/2 NPT. X 1	1	13	CAP. HOSEBARB INSERT	*
6	100347	PRESSURE GAUGE, 0 TO 160	1	14	REDUCING NIPPLE, 1/2 X 1/4 NPT	1
7	200540	STREET ELBOW, 1/4 NPT. X 90	1	15	TEE, 1/4 NPT.	1
8	2050025	RED. BUSHING, 1/2 X 1/4 NPT.	*	16	HOSEBARB ELBOW, 1/2 NPT. X 1/2	1 OPT
	200480	PLUG, 1/4 NPT.	*			

# 6000 SERIES FERTILIZER SUSPENSION APPLICATION PLUMBING

AVAILABLE TANKS (ITEM 13)

- 1004337 LEG TANK, 715 GAL (SNYDER)
- 7541137 LEG TANK, 1000 GAL (SNYDER)

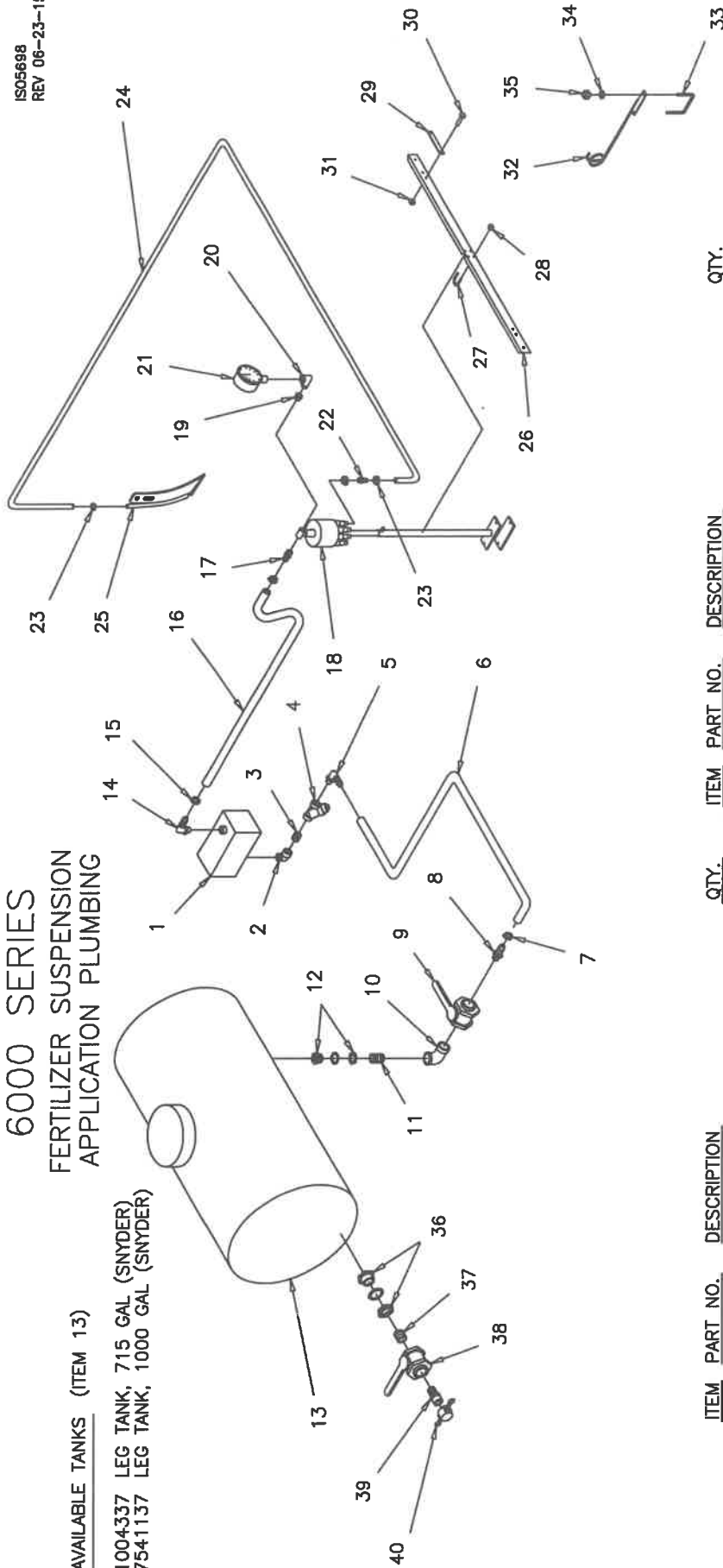

ITEM	PART NO.	DESCRIPTION	QTY.	ITEM	PART NO.	DESCRIPTION	QTY.
1	20024405	PUMP ASSEMBLY, LO-PRESSURE	1	21	500160	PRESSURE GAUGE, 0 TO 160 PSI	1
2	200888	STREET ELBOW, 1 1/2 NPT X 90	1	22	200504	HOSEBARB JOINER, 3/4 X 3/4	8
3	200556	CLOSE NIPPLE, 1 1/2 NPT.	1	23	NOTE: QTY. REQ'D. EQUALS 1 X NO. OF OUTLETS		24
4	200056	LINE STRAINER, 1 1/2 X 1 1/2 NPT.	1	24	NOTE: QTY. REQ'D. EQUALS 3 X NO. OF OUTLETS		1
5	200386	HOSEBARB ELBOW, 1 1/2 X 1 1/2	1	25	100806	HOSE, BRAIDED EVA, (3/4" X 100 FT.)	1
6	12012705	SOLUTION HOSE, 1 1/2 X 72"	1	26	AS SPECIFIED		1
7	200256	HOSE CLAMP, 1 5/16 TO 2 1/4	2	27	47008063	SUPPORT BAR, (HOSES)	1
8	200334	HOSEBARB, 1 1/2 X 1 1/2	1	28	47008065	U-BOLT, 5/16-18NC.	2
9	201150	BALL VALVE, 1 1/2 NPT.	1	29	18496400	5/16-18NC. FLANGE-NUT	4
10	200888	STREET ELBOW, 1 1/2 NPT.	1	30	47008064	CLAMP STRAP	2
11	200556	CLOSE NIPPLE, 1 1/2 NPT.	1	31	18056430	5/16-18NC. X 2 BOLT	4
12	501591	TANK BUNG ASSEMBLY, 1 1/2 NPT.	1	32	47008066	5/16-18NC. SELF-LOCKING NUT	4
13	200380	AS SPECIFIED, SEE LIST ABOVE	1	33	47001028	HOSE SUPPORT PIGTAIL	2
14	200380	HOSEBARB ELBOW, 1 X 1	1	34	18891200	U-BOLT, 3/8-16NC.	2
15	200248	HOSE CLAMP, 1 1/16 TO 1 1/2	2	35	18436800	3/8 LOCKWASHER	4
16	10040000	SUCTION HOSE, 1" X 18 FT.	1	36	21280	FORCE-FILL PACKAGE (ITEMS 36 TO 40) OPT.	4
17	200325	HOSEBARB, 3/4 NPT. X 1	1	37	20020019	TANK BUNG, 2"	1
18	504018	DISTRIBUTION POT, 8 OUTLET	1	38	200557	CLOSE NIPPLE, 2 NPT.	1
19	504025	DISTRIBUTION POT, 5 OUTLET	OPT.	39	200014	BALL VALVE, 2 NPT.	1
20	504016	DISTRIBUTION POT, 6 OUTLET	OPT.	40	200170	MALE ADAPTER, 2 NPT.	1
	504037	DISTRIBUTION POT, 7 OUTLET	OPT.		200172	CAP, 2 NPT.	1
	504019	DISTRIBUTION POT, 9 OUTLET	OPT.				
	275025	REDUCING BUSHING, 3/4 X 1/4 NPT S.S.)	1				
	200771	STREET ELBOW, 1/4 NPT. X 90	1				



6000CYL06  
rev 05/16/18

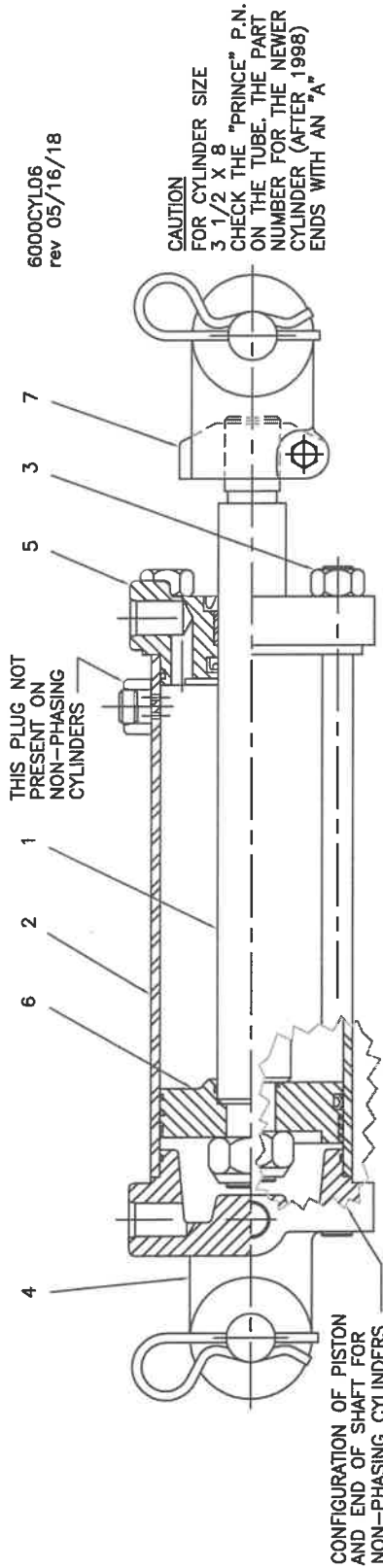

CONFIGURATION OF PISTON AND END OF SHAFT FOR NON-PHASING CYLINDERS

ITEM NO.	REPAIR PART DESCRIPTION	CYL 1 1/2 X 4	CYL 3 1/2 X 8	CYLINDER 4 X 8	CYLINDER 3 X 24	CYLINDER 3 X 14	QTY.
1	PISTON ROD	47005437 (AK-284)	A350080BBA07A	A400080BBA07A	E300240BBA07F	B300140BBA070A	1
2	TUBE	010300124	010700682	011015438A	010729750A	010719750A	1
3	TIE ROD ASSEMBLY	060800136	051710063A	051910563A	051526063A	051526063A	1
4	BUTT		170201123	170301134	170201282	170201282	4
5	GLAND ASSEMBLY		14170055F	14190055F	14150055F	14150055F	1
6	PISTON		080800083	081788G5F	081988NSF	081588G5F	1
7	CLEVIS ASSEMBLY REPAIR KIT		071700174	071900260	071500244	071500244	1
			100000444	100000326	100000423	100000423	1
			470AK284 (PRE 2018)	47033500	47033000	47033000	1
			(CAST CLEVIS)				
			20214 (POST 2018)				
			(WELDED CLEVIS)				

Repair kit items not available individually.

TIE ROD DISASSEMBLY--ASSEMBLY PROCEDURE

With the cylinder removed from the machine, cleaned, drained of oil and fully retracted, proceed as follows.

DISASSEMBLY

1. Secure the cylinder in a vice or other method to prevent rotation. Clean the immediate area so the parts can be laid out.
2. Remove the tie rod nuts. Pull the shaft assembly from the cylinder. Remove the tube item (2).
3. Loosen the clevis nut and remove the clevis item (7) from the shaft assembly.
4. Place the shaft assembly in a vice with brass or copper jaws so as not to damage the shaft.
5. Remove all seals from the butt, (item 4) gland assembly, (item 5) and piston (item 6) for replacement. Clean and inspect all parts for damage, (nicks, scratches, cracks etc.). Replace as necessary. If you have any question please contact Prince Engineering (712-277-4061)

REASSEMBLY

1. Replace all the seals on items (4), (5), and (6) except, for non-phasing cylinders do not replace the small o-ring on the ID of the piston item (6) until you are ready to attach the shaft item (1).
2. For non-phasing cylinders, place the small o-ring seal for the piston over the shaft turnaround. Apply a light coat of grease to the seal. Slip the piston item (6) onto the turnaround with the o-ring counterbore towards the shaft shoulder. Take care not to pinch the o-ring between the piston and the shoulder.
3. Replace the shaft end nut and secure.
4. Apply a light coat of grease to the seals on the gland item (5) and slip the gland over the shaft end. Be very careful not to damage the seals.
5. Slip the entire assembly into the lightly oiled tube, item (2) with the piston first making sure the tube slips over the OD seals of the gland.
6. Take the entire assembly from step 4 and slip the tube over the butt item (4). Align the ports in the butt and the gland and assemble the nuts to the tie rods and torque uniformly.
7. Test the reassembled cylinder for leaks and install in your machine. If you have any problems please contact Prince Engineering (712-277-4061)

# HUB ASSEMBLIES

6000HUB  
03-18-15

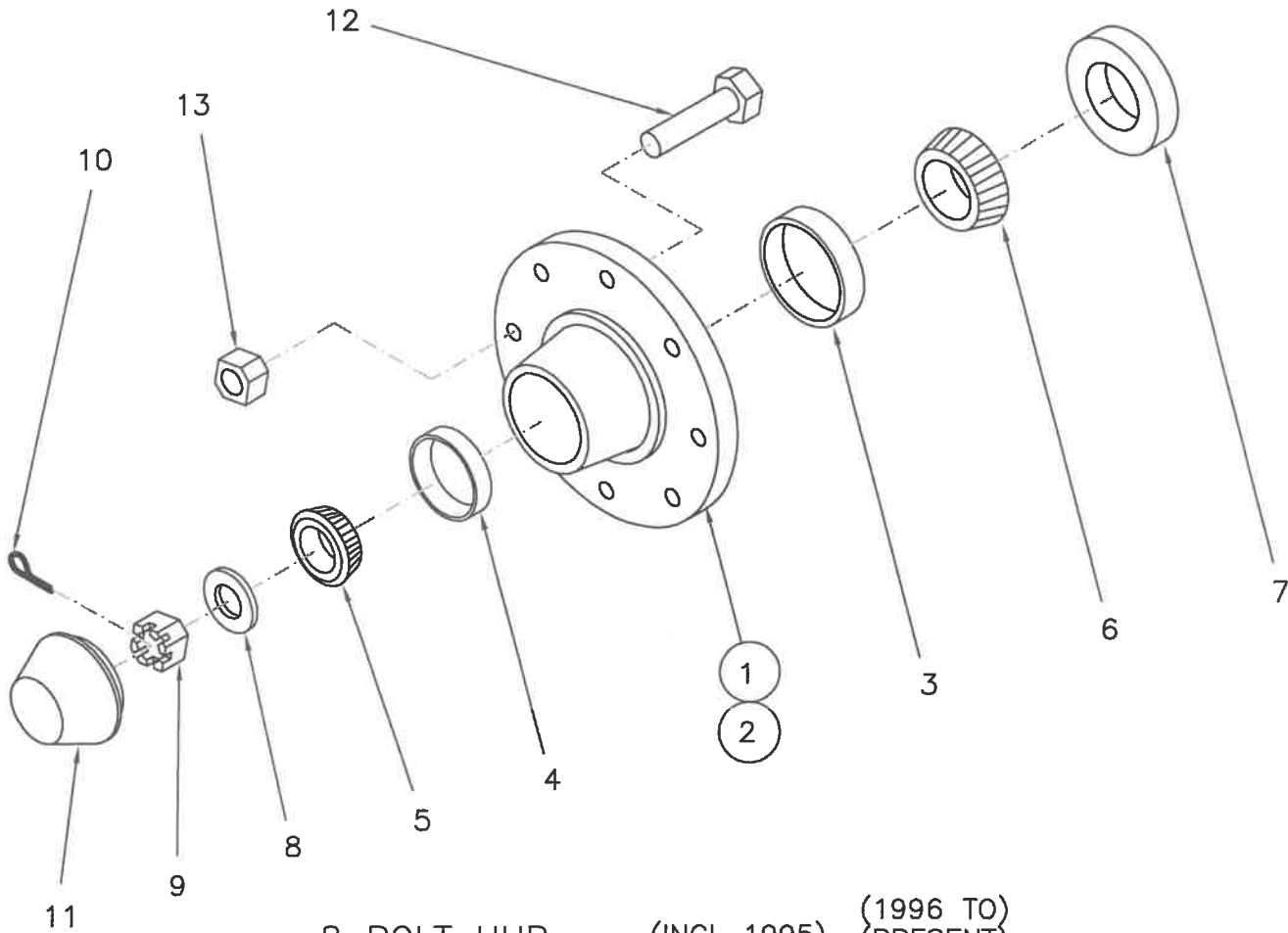

## 8 BOLT HUB

(INCL 1995) (1996 TO)  
6000 lb. (PRESENT)  
CAPACITY 6000 lb.  
CAPACITY

<u>ITEM</u>	<u>DESCRIPTION</u>	<u>PART NO.</u>	<u>PART NO.</u>	<u>QTY.</u>
1	HUB COMPLETE MFR. PART NUMBER INCLUDES ITEMS 2 THRU 7 AND ITEMS 11 THRU 13 ONLY	47009712 HD812-5	47008712 HD812-1	1
2	HUB WITH RACES	47005712	47004712	1
3	INNER BEARING RACE	47005372	47005372	1
4	OUTER BEARING RACE	47005272	47005272	1
5	OUTER BEARING CONE	47005279	47005279	1
6	INNER BEARING CONE	47005378	47005378	1
7	GREASE SEAL (SE17)	47005017	47005017	1
8	SPINDLE WASHER, 1" SC	18000017	18000017	1
9	SPINDLE NUT, 1NF SC	18489100	18489100	1
10	COTTER PIN, 3/16 X 2ZC	18560830	18560830	1
11	DUST CAP DC17	47005917	47005917	1
12	LUG BOLT 9/16 X 2 1/4	47005041	47005041	8
13	LUG NUT, 9/16-18UNF	47005040	47005040	8

# STANDARD UNIVERSAL MOUNT

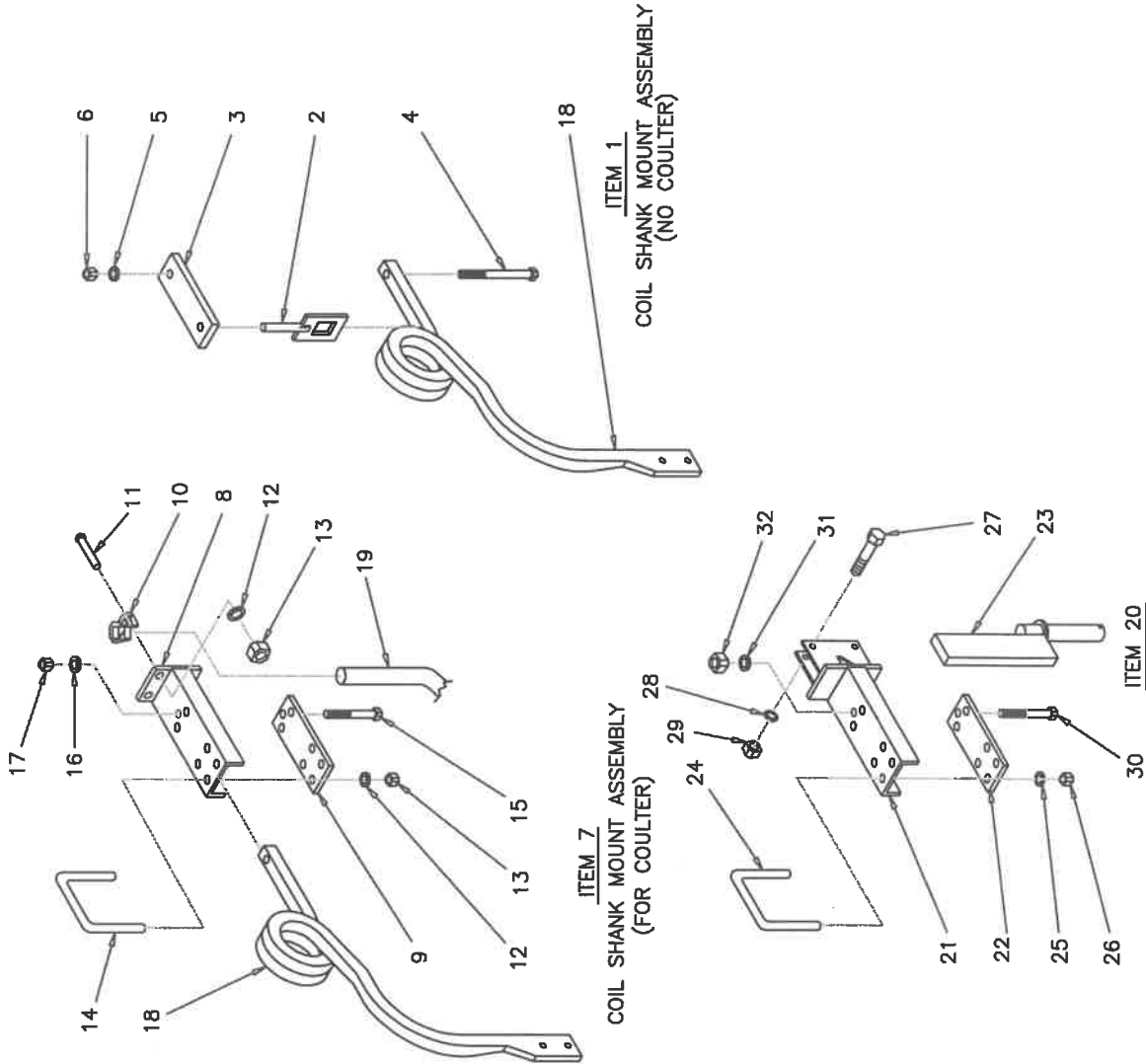

SHANK MOUNT ASSEMBLY for 1 X 2 FLAT KNIFE SHANK AND COULTER MOUNTED WITH 1 X 3 FLAT BAR COULTER SHANK

## COIL SHANK MOUNTING

ITEM	PART NO.	DESCRIPTION	QTY.
1	40511000 40512000	SHANK CLAMP SET, (6 X 4 BAR) SHANK CLAMP SET, (4 X 4 BAR) INCLUDES ITEMS 2 TO 6	1 OPT.
2	44009306 602083	LOLLIPOP, FOR SQUARE SHANK LOLLIPOP, FOR 1 X 2 SHANK WITH LOCKWASHER & NUT	1 OPT.
3	44006685	TOP PLATE, (6 X 4 BAR)	1
4	44006685	TOP PLATE, (4 X 4 BAR)	1
5	18058470	BOLT, 3/4-10NC. X 7	2
6	18891800	LOCKWASHER, 3/4	2
	18418400	HEX. NUT, 3/4-10NC.	2
7	47309184	SHANK MOUNT ASS'Y. (SQUARE SHANK) INCLUDES ITEMS 8 TO 14	1
	47309177	SHANK MOUNT ASS'Y. (1 X 2 SHANK) ON 6 X 4 BAR	OPT.
	47308184	SHANK MOUNT ASS'Y. (1 X 2 SHANK) ON 4 X 4 BAR INCLUDES ITEMS 8 TO 14	OPT.
8	47309406	SHANK HOLDER, (SQUARE SHANK)	1
	47302890	SHANK HOLDER, (1 X 2 SHANK)	OPT.
9	47306005	CLAMP PLATE, (SQUARE SHANK)	1
	47006832	CLAMP PLATE, (1 X 2 SHANK)	OPT.
10	47301538	CLAMP, COULTER SHANK	2
11	18057940	BOLT, 5/8-11NC. X 3 1/2	4
12	18891600	LOCKWASHER, 5/8	8
13	18417900	HEX. NUT, 5/8-11NC.	8
14	47006950	U-BOLT, 5/8-11NC. (6 X 4 BAR)	2
	47006951	U-BOLT, 5/8-11NC. (4 X 4 BAR)	OPT.
15	18057938	BOLT, 5/8-11NC. X 3	1
16	18891600	LOCKWASHER, 5/8	1
17	18417900	HEX. NUT, 5/8-11NC.	1
18	80310	COIL SHANK (OR AS SPECIFIED)	1
19	4036000	COULTER ASSEMBLY, AG36 W/STRAIGHT OR BENT COULTER SHANK AS SPEC'FD.	1
20	47999370	SHANK MOUNT ASSEMBLY COMPLETE INCLUDES ITEMS 21 TO 29	1
21	47309370	SHANK HOLDER, (1 X 2 SHANK)	1
22	47006832	CLAMP PLATE, (1 X 2 SHANK)	1
23	47303811	FLAT BAR COULTER SHANK, 18"	1
	47309811	FLAT BAR COULTER SHANK, 12"	OPT.
24	47006950	U-BOLT, 5/8-11NC. (6 X 4 BAR)	2
	47006951	U-BOLT, 5/8-11NC. (4 X 4 BAR)	OPT.
25	18891600	LOCKWASHER, 5/8	4
26	18417900	HEX. NUT, 5/8-11NC.	4
27	18057434	BOLT, 1/2-13NC. X 2 1/2	2
28	18891400	LOCKWASHER, 1/2	2
29	18417400	HEX. NUT, 1/2-13NC.	2
30	18057938	BOLT, 5/8-11NC. X 3	1
31	18891600	LOCKWASHER, 5/8	1
32	18417900	HEX. NUT, 5/8-11NC.	1

# SPRING BUNDLE ASSEMBLY

FOR 6 X 4 BAR YEAR 2000 TO PRESENT  
AND 6 X 6 BAR

SPECIFY U-BOLT SIZE (ITEM 15)

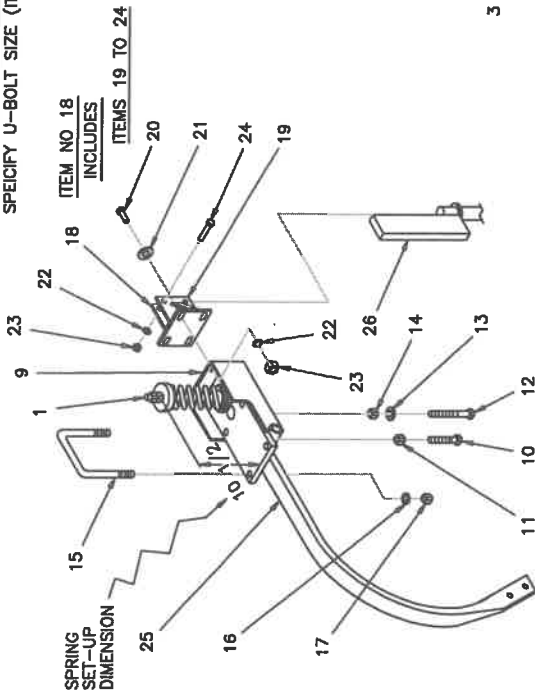

ITEM NO. 1  
INCLUDES ITEMS 2 TO 8

ITEM NO. 9  
INCLUDES ITEM 1  
AND 10 TO 17

ITEM	PART NO.	DESCRIPTION	QTY
1	47010082	SPRING SHANK MOUNT ASSEMBLY	1
		INCLUDES ITEMS 2 TO 8	
2	47010189	SHANK MOUNTING BASE	1
3	18801805	GREASE ZERK	2
4	47007766	BOLT, 3/4-10NC. X 15	1
5	18851800	FLATWASHER, 3/4	2
6	47007085	END COLLAR	2
7	47007565	COMPRESSION SPRING	1
8	18446890	HEX. NUT, 3/4-10NC. GR. 5	2
9	47020082	SPRING LOADED SHANK MOUNT COMPLETE (NO COULTER)	1
		INCLUDES ITEMS 1 AND 10 TO 17	
		(SHIPPING INFO) HARDWARE PACKAGE	
	47990082	INCLUDES ITEMS 10 TO 17	
10	18056429	BOLT, 3/4-10NC. X 1 3/4	1
11	18449003	HEX. JAM NUT, 3/4-10NC.	1
12	18056436	BOLT, 3/4-10NC. X 3	1
13	18891800	LOCKWASHER, 3/4	1
14	18416400	HEX. NUT, 3/4-10NC.	1
15	47007083	U-BOLT, 5/8-11NC. (4 X 6 BAR)	2
	47009847	U-BOLT, 5/8-11NC. (6 X 6 BAR)	OR
16	18891600	LOCKWASHER, 5/8	4
17	18417900	HEX. NUT, 5/8-11NC.	4

P.N. 47039417

SPRING BUNDLE ASSEMBLY COMPLETE  
INCLUDES AT ITEMS (1 TO 25)  
DOES NOT INCLUDE THE SHANK OR COULTER

ITEM	PART NO.	DESCRIPTION	QTY
1	47029413	SPRING SHANK MOUNT ASSEMBLY	1
		INCLUDES ITEMS 2 TO 8	
2	47019413	SHANK MOUNTING BASE	1
3	18801805	GREASE ZERK	2
4	47007766	BOLT, 3/4-10NC. X 15	1
5	18811800	FLATWASHER, 3/4	2
6	47007085	END COLLAR	2
7	47007565	COMPRESSION SPRING	1
8	18446890	HEX. NUT, 3/4-10NC. GR. 5	2
9	47039413	SPRING LOADED SHANK MOUNT COMPLETE (NO COULTER)	1
		INCLUDES ITEMS 1 AND 10 TO 17	
10	18056429	BOLT, 3/4-10NC. X 1 3/4	1
11	18449003	HEX. JAM NUT, 3/4-10NC.	1
12	18056436	BOLT, 3/4-10NC. X 3	1
13	18891800	LOCKWASHER, 3/4	1
14	18416400	HEX. NUT, 3/4-10NC.	1
15	47007083	U-BOLT, 5/8-11NC. (4 X 6 BAR)	2
	47009847	U-BOLT, 5/8-11NC. (6 X 6 BAR)	OR
16	18891600	LOCKWASHER, 5/8	4
17	18417900	HEX. NUT, 5/8-11NC.	4
18	47029417	COULTER MOUNTING BRACKET ASSEMBLY	1
		INCLUDES ITEM 19 TO 24	
19	47019417	COULTER MOUNTING BRACKET	1
20	18057426	BOLT, 1/2-13NC. X 1 1/2	4
21	18811400	FLATWASHER, 1/2	4
22	18891400	LOCKWASHER, 1/2	6
23	18417400	HEX. NUT, 1/2-13NC.	6
24	18057434	BOLT, 1/2-13NC. X 2 1/2	2
25	103471	SPRING SHANK (OR AS SPECIFIED)	1
26		COULTER ASSEMBLY COMPLETE	1

REFER TO COULTER ILLUSTRATIONS (AG36 OR AG38)  
FOR ITEM PART NUMBERS AND SPECIFY  
BLADE ASSEMBLY NUMBER  
AND SWIVEL BAR NUMBER.

# SPRING LOADED SHANK MOUNTING

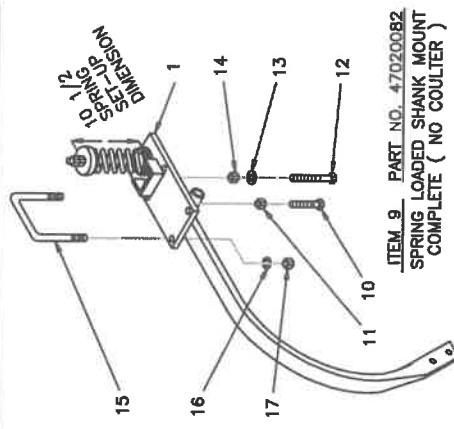

ITEM NO. 9  
PART NO. 47020082  
SPRING LOADED SHANK MOUNT COMPLETE (NO COULTER)

ITEM 1 (REPAIR PARTS)  
SPRING SHANK MOUNT ASSEMBLY  
INCLUDES ITEMS 2 TO 8

26A

AG37 COULTER ASSEMBLY  
 (GENERATION II)  
 MAINTENANCE-FREE HUB  
 FROM 2001 TO PRESENT

AG37GN2  
 REV/10-22-09

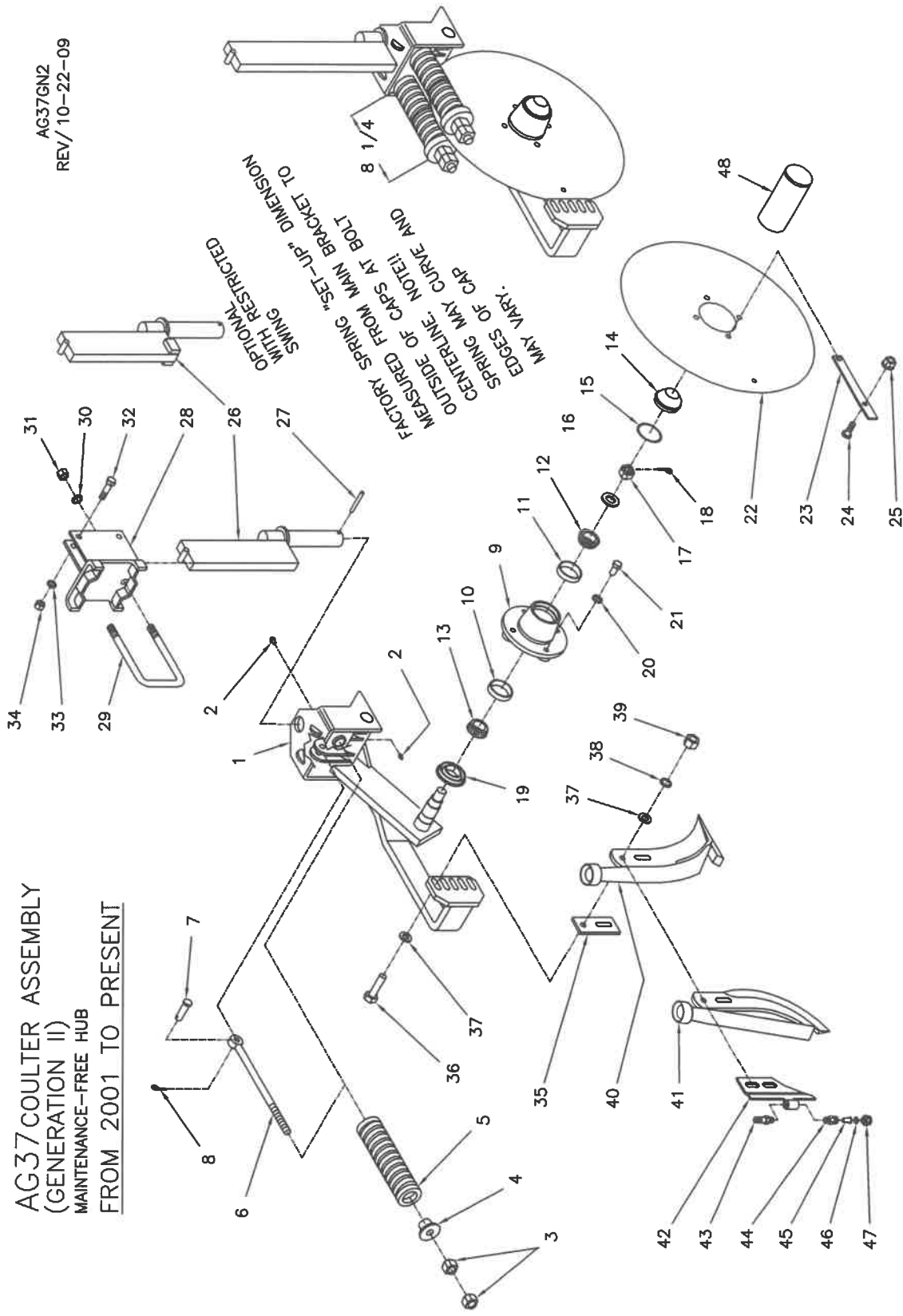

# AG37 COULTER ASSEMBLY (GENERATION II)

## with MAINTENANCE-FREE HUB MOUNTING INSTRUCTIONS AND PARTS LIST

AG37GN2LS  
REV.01/28/72

1. Your AG37 main bracket and hub are pre-assembled at the factory and the trip springs are pre-loaded to provide 525 pounds blade pressure. This should be adequate for normal field conditions. The coultter arm should trip up only when hitting a solid obstruction. During your field operation check to make sure the coultter arm is staying rigid most of the time. Excessive flexing will cause premature spring failure. If repeated tripping is occurring, tighten the spring tension till rigid normal operation is achieved.
2. Assemble the blade (item 22) to the hub, and (if used) the scraper (item 23) to the blade with the hardware (item 24 and item 25).
3. Assemble the swivel bar (item 26) to the main bracket (item 1). Be sure the 1 x 3 bar is positioned between the half moon stops on top of the main bracket. Install the roll pin (item 27).
4. Position the mounting brackets (item 28) at the desired spacing and fasten with the U-bolts (item 29) and hardware (items 30 and 31).
5. Install the coultter assemblies to the mounting brackets (item 28) and fasten with the bolts (item 32) and hardware (items 33 and 34). Assemble the hardware snug only.
6. Adjust the coultter blade to the desired depth and tighten the hardware securely.
7. Assemble the knife (item 40 or 41) to the coultter assembly with the shims (item 35), bolts (item 36) and hardware (items 37, 38 and 39). Select and install the shims in a manner so that as you rotate the blade a complete revolution you observe that the point of the knife and the lower area of the knife is behind the blade at all times. The knife should also be set at zero clearance (see step 7). This will maintain the blade's trash cutting ability. The top of the knife should be away from the blade far enough so that the scraper can pass the top, thick part of the knife without rubbing the knife. NOTE: The bolt head should be located next to the bracket (see illustration) and any shims not needed should be placed between the backside of the bracket and the flatwasher next to the head of the bolt.
8. Adjust the knife position relative to the blade edge. The backswept knife (item 41) should be positioned to obtain maximum backsweep. Locate the upper bolt to the front of the slot and the lower bolt to the back of the slot. The forward swept knife (item 40) should be positioned as close to the blade edge as possible. Rotate the coultter blade to determine the point of maximum eccentric runout of the circumference and adjust the knife to zero clearance at this point. NOTE: The knife will have to be re-adjusted regularly.
9. Make sure all hardware is tightened securely.

10. During field operation grease the swivel bar journals weekly. And grease for end-of-season storage. Inspect the coultter blade and knife clearance daily. Adjust per step 8 if required. The coultter hub is greased-for-life and should need no regular maintenance. Check for damage to the dust cap and grease seal daily.

ITEM	PART NO.	DESCRIPTION	QTY	ITEM	PART NO.	DESCRIPTION	QTY	ITEM	PART NO.	DESCRIPTION	QTY
1	47309570	MAIN BRKT. & BLADE ASSEMBLY, L.H.	1	23	47306921	SCRAPER	1	30	18891600	LOCKWASHER, 5/8	2
2	47309568	MAIN BRKT. & BLADE ASSEMBLY, R.H.	1	24	18033810	BOLT, 3/8-16NC. X 1, TRUSS HEAD	1	31	18417900	HEX. NUT, 5/8-11NC.	2
3	18407900	INCLUDES ITEMS 1 TO 22	2	25	18496800	HEX. NUT, 3/8-16NC. FLANGED	1	32	18057434	BOLT, 1/2-13NC. X 2 1/2	2
4	47301530	MAIN BRKT W/HUB ASSEMBLY, L.H.	1	26	47303811	COULTER SWIVEL BAR, 18" (INCL. ITEM 27)	1	33	18891400	LOCKWASHER, 1/2	2
5	47301524	MAIN BRKT W/HUB ASSEMBLY, R.H.	1	27	47309811	COULTER SWIVEL BAR, 12" (INCL. ITEM 27) OPT.	1	34	18417400	HEX. NUT, 1/2-13NC.	2
6	47301547	INCLUDES ITEMS 1 TO 21 (W/O BLADE)	1	28	OPTIONAL	COULTER BAR W/RESTRICTED SWING	1	35	47306681	SHIM, 1/4	1
7	18541428	MAIN BRACKET, L.H. (W/O HUB OR BLADE)	1	29	47005147	10 DEG. AND 15 DEG. AVAILABLE	1	36	47306682	SHIM, 1/8	1
8	47300350	MAIN BRACKET, R.H. (W/O HUB OR BLADE) OPT.	1	30	47005147	18" BAR 10' RESTR. SWING (BOTH WAYS)	1	37	47306683	SHIM, 1/16	1
9	47300351	INCLUDES ITEMS 9 TO 15	1	31	47005147R	18" BAR 10' RESTR. SWING (LH ONLY)	1	38	18057432	BOLT, 1/2-13NC. X 2 1/4	2
10	47005510	HUB WITH CUPS ITEMS 10 & 11	1	32	47005147R	18" BAR 10' RESTR. SWING (RH ONLY)	1	39	18891400	LOCKWASHER, 1/2	2
11	47005010	BEARING CUP, INNER	1	33	47005149	18" BAR 15' RESTR. SWING (BOTH WAYS)	1	40	18417400	HEX. NUT, 1/2-13NC.	2
12	47005048	BEARING CUP, OUTER	1	34	47005149L	18" BAR 15' RESTR. SWING (LH ONLY)	1	41	47309735	DRY KNIFE, W/ BUSHING, (FORWARD)	1
13	47005548	BEARING CONE, OUTER	1	35	47005149R	18" BAR 15' RESTR. SWING (RH ONLY)	1	42	47309734	DRY KNIFE, W/O BUSHING, (FORWARD)	1
14	47005513	BEARING CONE, INNER	1	36	47005147	CALL AG SYSTEMS FOR INFO.	1	43	47309742	LIQUID KNIFE, (FORWARD)	1
15	47990351	O-RING DUST SEAL	1	37	18511032	ROLL PIN, 1/4 X 2 1/4	1	44	47007468	LIQUID KNIFE, (FORWARD)	1
16	47300352	SPINDLE WASHER	1	38	47309893	MOUNTING BRACKET, (4" VERTICAL) STD.	1	45	47309748	LIQUID KNIFE, (FORWARD)	1
17	47300353	SLOTTED NUT, 7/8-14UNF	1	39	47006951	U-BOLT, 5/8-11NC. (4" V X 6" H BAR)	1	46	47309759	DRY KNIFE, W/ BUSHING, (BACKSWEEP)	1
18	18560726	COTTER PIN, 5/32 X 1 1/2	1	40	44001616	U-BOLT, 5/8-11NC. (4" V X 4" H BAR)	1	47	47309750	LIQUID KNIFE, (BACKSWEEP)	1
19	40030326	GREASE SEAL	1	41	OTHER	MOUNTING BRACKET OPTIONS	1	48	47309038	NOZZLE BRACKET	1
20	18891400	LOCK WASHER, 1/2 I.D.	4	42	47309887	MOUNTING BRKT., (2 1/2" VERTICAL)	1		100859	HOSEBARB, S.S. 1/4 NPT. X 1/2 TUBE	1
21	18057522	WHEEL BOLT, 1/2-20NF X 1	4	43	47006659	U-BOLT, 5/8-11NC. (2 1/2" VERTICAL)	1		500192	ADAPTER	1
22	47305027	COULTER BLADE, 20" RIPPLED	1	44	47309732	MOUNTING BRACKET, (3" VERTICAL)	1		500192	STREAM STABILIZER	1
				45	47309732	MOUNTING BRKT., (3" VERT., EXT.)	1		504015	SELECT FROM ORIFICE CHART	1
				46	47309807	MOUNTING BRKT., (3" VERTICAL)	1		503127	CAP	1
				47	47309888	MOUNTING BRKT., (6" VERTICAL)	1				
				48	47010154	U-BOLT, 5/8-11NC. (6" V X 4" H BAR)	1				
				49	47009847	U-BOLT, 5/8-11NC. (6" V X 6" H BAR)	1				
				50	47309736	MOUNTING BRKT., (7" VERTICAL)	1				
				51	47302730	U-BOLT, 1/2-13NC. (7" VERTICAL)	1				
				52	NOTE for 7" U-BOLT USE 1/2-13NC. HEX. NUTS						

REF 47300300 SPINDLE ONLY

**AG37 COULTER ASSEMBLY**  
 (GENERATION III)  
 MAINTENANCE-FREE HUB AND JOURNALS  
 FROM 2003 TO PRESENT

AG37GN3  
 REV. 12-15-11

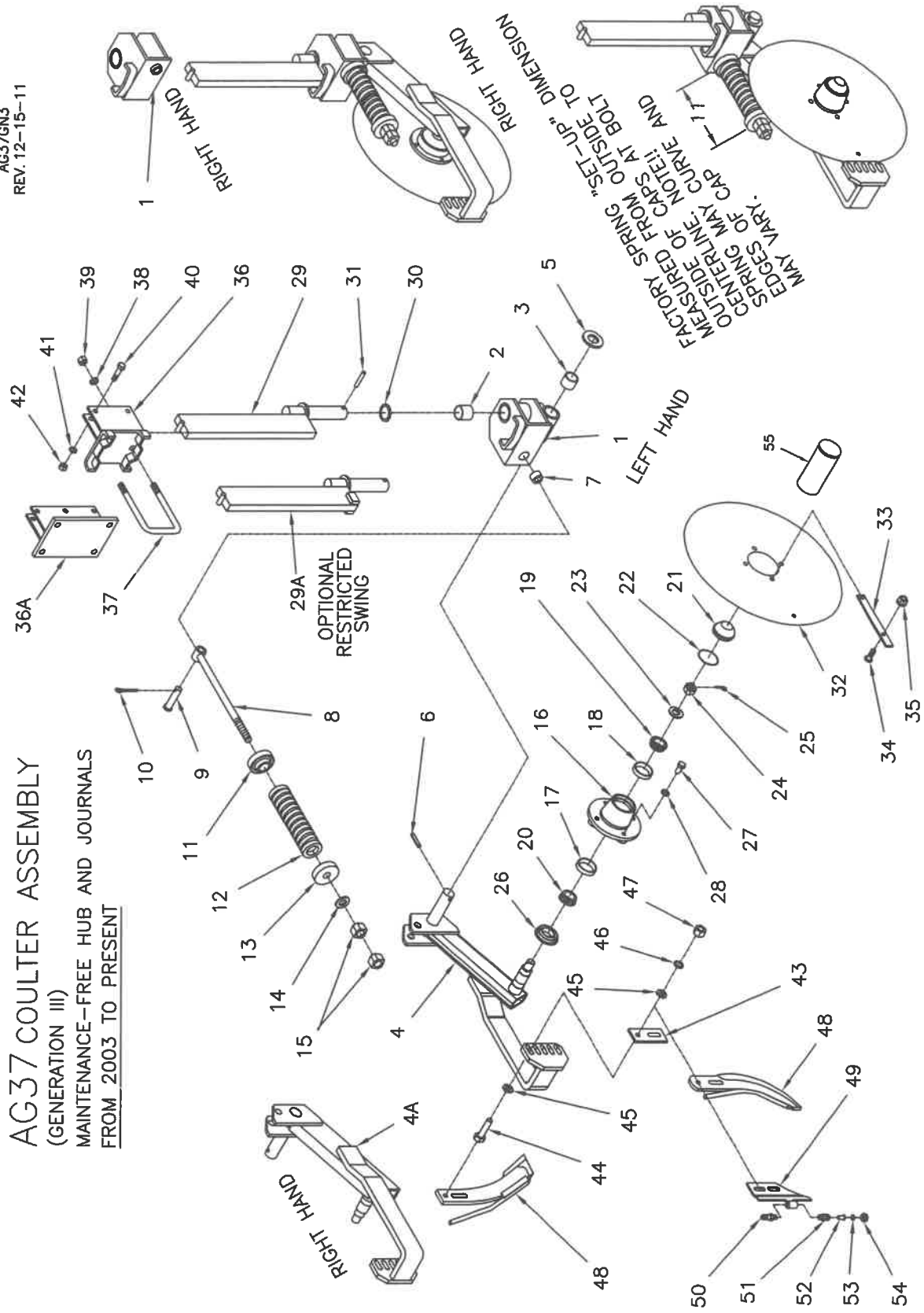



# AG37 COULTER ASSEMBLY (GENERATION III)

AG37GN3LS  
REV. 01/28/22

## MAINTENANCE-FREE HUB AND JOURNALS MOUNTING INSTRUCTIONS AND PARTS LIST

1. Your AG37 Gen III main bracket and hub are pre-assembled at the factory and the trip spring is preloaded to provide 600 pounds blade pressure. This should be adequate for normal field conditions. The coulters arm should trip up only when hitting a solid obstruction. During your field operation check to make sure the coulters arm is staying rigid most of the time. Excessive flexing will cause premature spring failure. If repeated tripping is occurring, tighten the spring tension till rigid normal operation is achieved.

2. Assemble the blade (item 32) to the hub, and (if used) the scraper (item 33) to the blade with the hardware (items 34 & 35).

3. Assemble the swivel bar (item 29) to the bracket assembly. Be sure the swivel bar is positioned between the swivel control lugs on top of the main bracket. Install the washer (item 30) and pin (item 31).

4. Position the mounting bracket (item 36) at the desired spacing and fasten with the u-bolt (item 37) and hardware (items 38 and 39).

5. Install the coulters assemblies in the mounting brackets (item 36) and fasten with the bolts (item 40) and hardware (items 41 and 42). Assemble the hardware snug only.

6. Adjust the coulters blade to the desired depth and tighten the hardware securely.

7. Assemble the knife (item 48) to the coulters assembly with the shims (item 43), bolts (item 44) and hardware (items 45, 46 and 47). Select and install the shims in a manner so that as you rotate the blade a complete revolution you see that the point of the knife and the lower area of the knife is behind the blade at all times. The backstop knife should be positioned to obtain maximum backswEEP. Locate the upper bolt to the front of the slot and the lower bolt to the back of the slot. Note, the bolt head should be located next to the bracket (see illustration) and any shims not needed should be placed between the back side of the bracket and the flat washer next to the head of the bolt.

8. The front swept knife should be positioned as close to the blade edge as possible. Zero clearance. This will maintain the blade's trash cutting ability. Rotate the coulters blade to determine the point of maximum eccentric runout of the circumference and adjust the knife to zero clearance at this point. The top of the knife should be away from the blade far enough so that the scraper can pass the top, thick part, of the knife without rubbing the knife. NOTE, The knife position should be inspected frequently and re-adjusted regularly.

9. Make sure all hardware is tightened securely.

10. No field operation lubricating is required. The hubs are sealed and greased for life. The swivel journals are assembled with grease-less bushings. For repair procedure, see separate sheet titled PROCEDURE TO SERVICE A COULTER HUB.

REF 47300300 SPINDLE ONLY

ITEM	PART NO.	DESCRIPTION	QTY	ITEM	PART NO.	DESCRIPTION	QTY	ITEM	PART NO.	DESCRIPTION	QTY
1	47004500	MAIN BRKT. & BLADE, L.H. (STANDARD)	1	20	47005548	BEARING CONE, INNER	1	37	47010154	U-BOLT, 5/8-11NC. (6" V X 4" H BAR)	1
2	47014500	MAIN BRKT. & BLADE, R.H. (STANDARD)	1	21	47005513	DUST CAP	1	37	47009847	U-BOLT, 5/8-11NC. (6" V X 6" H BAR)	1
3	47009954	HOUSING W/BUSHINGS, L.H. (STD)	1	22	47990351	O-RING DUST SEAL	1	36A	47309736	MOUNTING BRACKET, (7" VERTICAL)	1
4	47004507	HOUSING W/BUSHINGS, R.H. (STD)	1	23	47300352	SPINDLE WASHER	1	37	47302730	U-BOLT, 1/2-13NC. (7" V X 7" H BAR)	2
4A	47014507	HOUSING W/BUSHINGS, L.H. (STD)	1	24	47300353	SLOTTED NUT, 7/8-14UNF	1	38	18891400	LOCKWASHER, 1/2	4
5	18300326	RETAINING WASHER, 1 3/8 I.D.	1	25	18560726	COTTER PIN, 5/32 X 1 1/2	1	39	18417400	HEX. NUT, 1/2-13NC	4
6	18511035	EXPANSION PIN, 3/8 X 2	1	26	40030326	GREASE SEAL	1	38	18891600	LOCKWASHER, 5/8	2
7	2-6668	EYE BOLT GUIDE	1	27	18057522	WHEEL BOLT, 1/2-20NF X 1	4	39	18417900	HEX. NUT, 5/8-11NC.	2
8	47004518	EYE BOLT SPRING RETAINER	1	28	18891400	LOCK WASHER, 1/2 I.D.	4	40	18057434	BOLT, 1/2-13NC. X 2 1/2	2
9	18541835	CLEVIS PIN, 3/4 X 2 1/2	1	29	47304522	COULTER SWIVEL BAR, 18" STANDARD	1	41	18891400	LOCKWASHER, 1/2	2
10	18560726	COTTER PIN, 5/32 X 1 1/2	1	29A	OPTIONAL	10 DEG. AND 15 DEG. AVAILABLE	1	42	18417400	HEX. NUT, 1/2-13NC.	2
11	47004521	SPRING CAP, WITH COUNTER-BORE	1	30	18300323	RETAINING WASHER, 1 1/2 I.D.	1	43	ITEMS 40, 41 & 42 (3) REQ'D. W 6 X 6 OR 7 X 7 TUBE	1	
12	47007565	COMPRESSION SPRING	1	31	47005144	18" BAR 10" RESTR. SWING LH ONLY	1	44	47306661	SHIM, 1/4	1
13	47007085	SPRING CAP, STANDARD CASTING	1	32	47005144R	18" BAR 10" RESTR. SWING RH ONLY	1	45	47306662	SHIM, 1/8	1
14	18851800	FLAT WASHER, 3/4	1	33	47005145	18" BAR 15" RESTR. SWING (BOTH WAYS)	1	46	18057432	BOLT, 1/2-13NC. X 2 1/4	2
15	18446890	HEX. NUT, 3/4-10NC	2	34	47005145R	18" BAR 15" RESTR. SWING LH ONLY	1	47	18891400	LOCKWASHER, 1/2	2
16	47300350	HUB COMPLETE (W/O SEAL & BOLTS)	1	35	CALL AG SYSTEMS FOR INFO.	CALL AG SYSTEMS FOR INFO.	1	48	18891400	LOCKWASHER, 1/2	2
17	47300351	HUB WITH CUPS ITEMS 17 & 18	1	36	18300323	RETAINING WASHER, 1 1/2 I.D.	1	49	47309038	NOZZLE BRACKET (L.H) (STANDARD)	1
18	47005010	BEARING CUP, INNER	1	37	18511036	EXPANSION PIN, 3/8 X 2 1/4	1	49A	47997038	NOZZLE BRACKET (R.H.)	1
19	47005048	BEARING CUP, OUTER	1	38	47305027	COULTER BLADE, 20" RIPPLED	1	50	100859	HOSEBARB, S.S. 1/4 NPT. X 1/2 TUBE	1
				39	ITEMS 33 TO 35	OPT. USE W/FRONT SWEPT KNIFE ONLY	1	51	500415	STREAM STABILIZER	1
				40	47306921	SCRAPER	1	52	504015	SELECT FROM ORIFICE CHART	1
				41	18033810	BOLT, 3/8-16NC. X 1, TRUSS HEAD	1	54	503127	CAP	1
				42	18496800	HEX. NUT, 3/8-16NC. X 1, FLANGED	1	55	47005500	DUST CAP INSTALLATION TOOL (OPTIONAL)	1
				43	47309893	MOUNTING BRACKET, (4" VERTICAL) STD.	1				
				44	47006951	U-BOLT, 5/8-11NC. (4" V X 6" H BAR)	1				
				45	44001616	U-BOLT, 5/8-11NC. (4" V X 4" H BAR)	1				
				46	47309888	MOUNTING BRACKET, (6" VERTICAL)	1				

**PROCEDURE TO SERVICE A COULTER HUB  
“MAINTENANCE-FREE” HUB**

The factory procedure to assemble the coultter hub has been developed to obtain maximum life and to eliminate damage to the components. IT IS IMPORTANT to understand and follow this procedure when servicing the coultter hub. If possible, obtain an illustration of the coultter before proceeding.

ASSEMBLE THE COULTER HUB AS FOLLOWS.

- 1: Pre-pack the inner bearing cone with grease and insert it into the back of the hub.
- 2: Add grease to cover the back of the bearing and cup. CAUTION – CAUTION : Do not “fill” the back of the hub with grease. Do not get any grease on the sealing seat for the grease seal. The seal is treated with a sealing agent and grease or oil on the sealing surface will destroy the effectiveness of the seal. If there is any grease on the sealing surface in the hub wipe it with a degreasing agent.
- 3: Carefully insert the grease seal. Do not get any grease on the outer sealing surface of the seal. Tap or press the seal in place. Make sure the seal is entering and seating squarely.
- 4: Turn the hub over and fill the center cavity with grease. Pre-pack the outer bearing with grease and insert it into the hub.
- 5: Position the hub on the spindle and install the spindle washer and the slotted nut.
- 6: Rotate the hub by hand while tightening the slotted nut until the hub locks-up. This will align and seat the bearing rollers. Back off the nut until you can freely rotate the hub by hand and install the cotter pin.
- 7: Completely fill the front cavity of the hub with grease.
- 8: Inspect the hub to make sure it is properly assembled and then install the dust cap.  
CAUTION: Once the dust cap is installed it cannot be removed with out destroying it. Take care to be sure the dust cap is square to the bore when starting and seating it. An old dust cap or a piece of tubing with the right I. D. and O. D. may be helpful.
- 9: You may now assemble the coultter blade. During field operation check the coultter blade periodically for wobble. This could be a result of hitting rocks and/or normal wear. Re-adjust the bearing tension (see step 6). Wobble in the hub could damage the seal and cause bearing failure. Note that you will need to install a new dust cap after a bearing adjustment. REVIEW step 8.

SRVCLTRHUB

# OFFSET ASSEMBLY

## FOR CENTER SHANK

ISO36

ITEM	PART NO.	DESCRIPTION	QTY
1	47006050	OFFSET ASSEMBLY COMPLETE INCLUDES ITEMS 1 TO 8	1
2	47002841	STAGGER BRACKET, SHORT	2
3	18058460	3/4-10 NC. X 6 1/2 BOLT	2
4	18891800	3/4 LOCKWASHER	2
5	18418400	3/4-10 NC. HEX. NUT	2
6	47006545	U-BOLT, 1/2-13 NC.	1
7	47007400	BRACKET, PIVOT CONTROL	4
8	18891400	1/2 LOCKWASHER	4
	18417400	1/2-13 NC. HEX. NUT	4

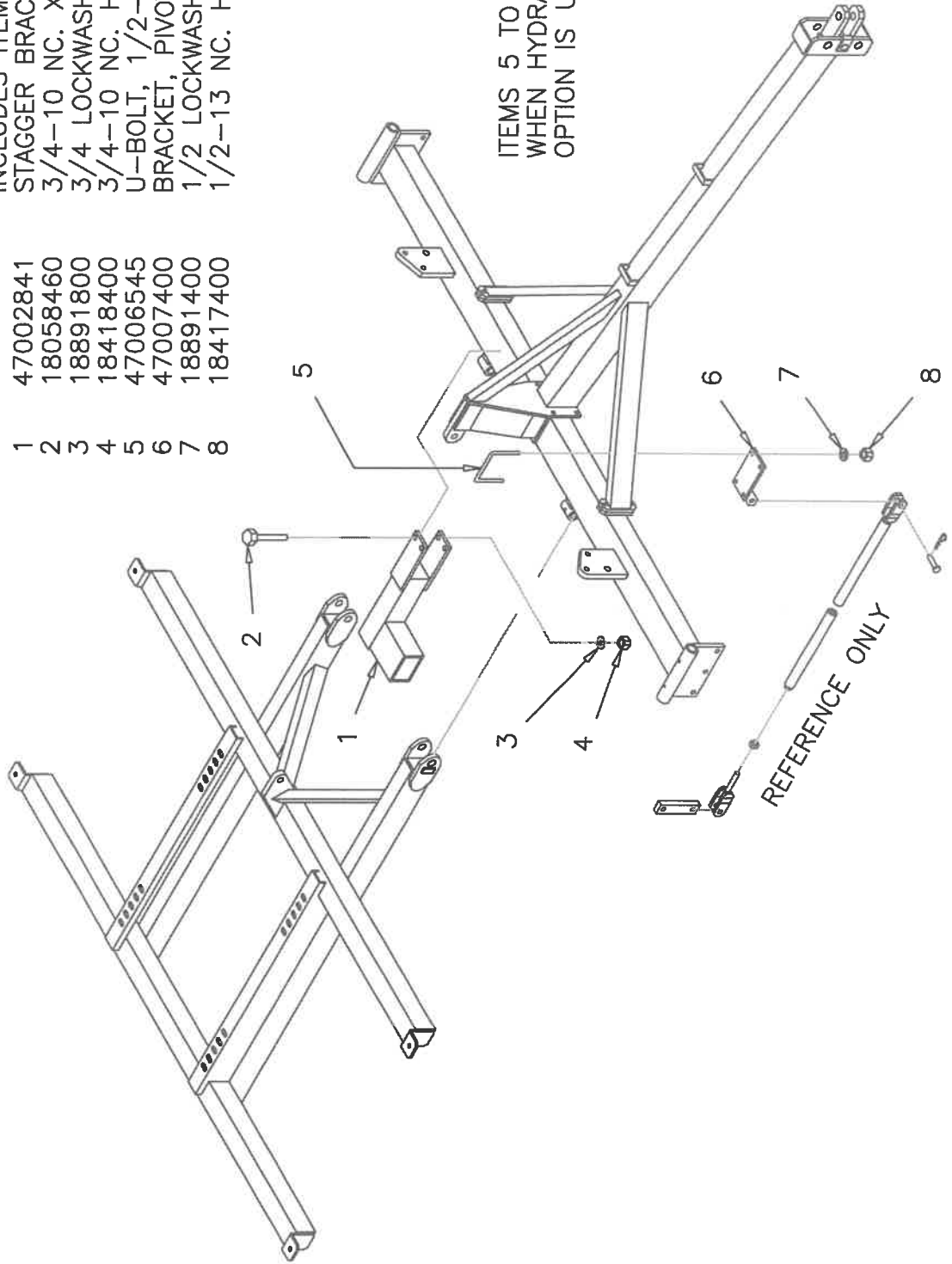

# HYDRAULIC PLUMBING SCHEMATIC FOR 6000 SERIES TOOLBAR WITH SELECTOR VALVE

60PMB97B

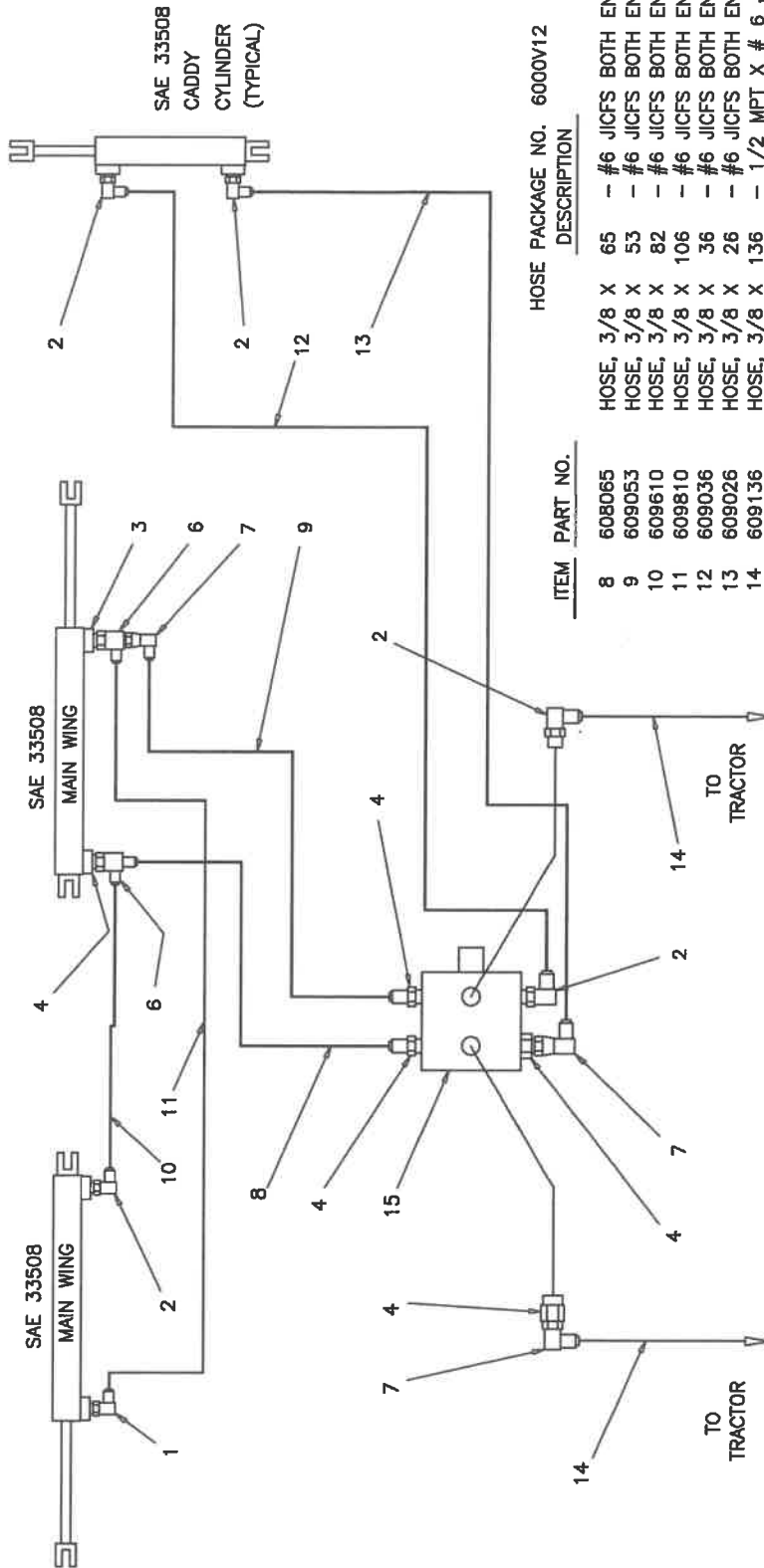

HOSE PACKAGE NO. 6000V12

ITEM	PART NO.	DESCRIPTION	QTY
8	608065	HOSE, 3/8 X 65 - #6 JICFS BOTH ENDS	1
9	609053	HOSE, 3/8 X 53 - #6 JICFS BOTH ENDS	1
10	609610	HOSE, 3/8 X 82 - #6 JICFS BOTH ENDS	1
11	609810	HOSE, 3/8 X 106 - #6 JICFS BOTH ENDS	1
12	609036	HOSE, 3/8 X 36 - #6 JICFS BOTH ENDS	1
13	609026	HOSE, 3/8 X 26 - #6 JICFS BOTH ENDS	1
14	609136	HOSE, 3/8 X 136 - 1/2 MPT X # 6 JICFS	2

FITTING PACKAGE NO. 620V32

ITEM	PART NO.	DESCRIPTION	QTY
1	6801-6-8R	ADAPTER ELBOW #6 MJIC X #8 M O-RING WITH .045 ORIFICE (BLACK FINISH)	1
2	6801-6-8	ADAPTER ELBOW #6 MJIC X #8 M O-RING	5
3	6400-6-8R	CONNECTOR, #6 MJIC X #8 M O-RING WITH .045 ORIFICE (BLACK FINISH)	1
4	6400-6-8	CONNECTOR, #6 MJIC X #8 M O-RING	5
5	6602-6	RUN TEE, #6 MJIC X #6 FJIC SWIVEL	2
7	6500-6	ELBOW #6 MJIC X #6 FJIC SWIVEL	3
15	100902	SELECTOR VALVE ASSEMBLY	1

## OTHER OPTIONS

### Tank, Skids and Saddles

- 770750 750 Gallon Crown/Snyder Drainable Poly Leg Tank
- 47018070 Skid and Band Pkg with Hardware  
for 750 Gallon Crown/Snyder Tank
- 47018018 Skid and Hoop Pkg with Hardware  
Fits 725 Gallon Norwesco Tank
- 40730000 Tank/Saddle Complete Assembly  
for 500 Gallon (Solar) Round Tank

### 21 Foot Toolbar

Use 47009642 (1) Pc. Wings to replace  
the 47007156 and 47007159 (2) Pc. Wings

### 28 1/2 Foot Toolbar

Use 47007488 Center Section (1/2 Wall Tube) to replace  
the 47007235 Center Section (3/8) Wall Tube)

Use 47009645 (1) Pc. Wings to replace  
the 47007156 and 47007159 (2) Pc Wings



# SAFETY LIGHT KIT FOR TOOLBARS

P/N: 47999316

(6200 TOOL BAR SHOWN)

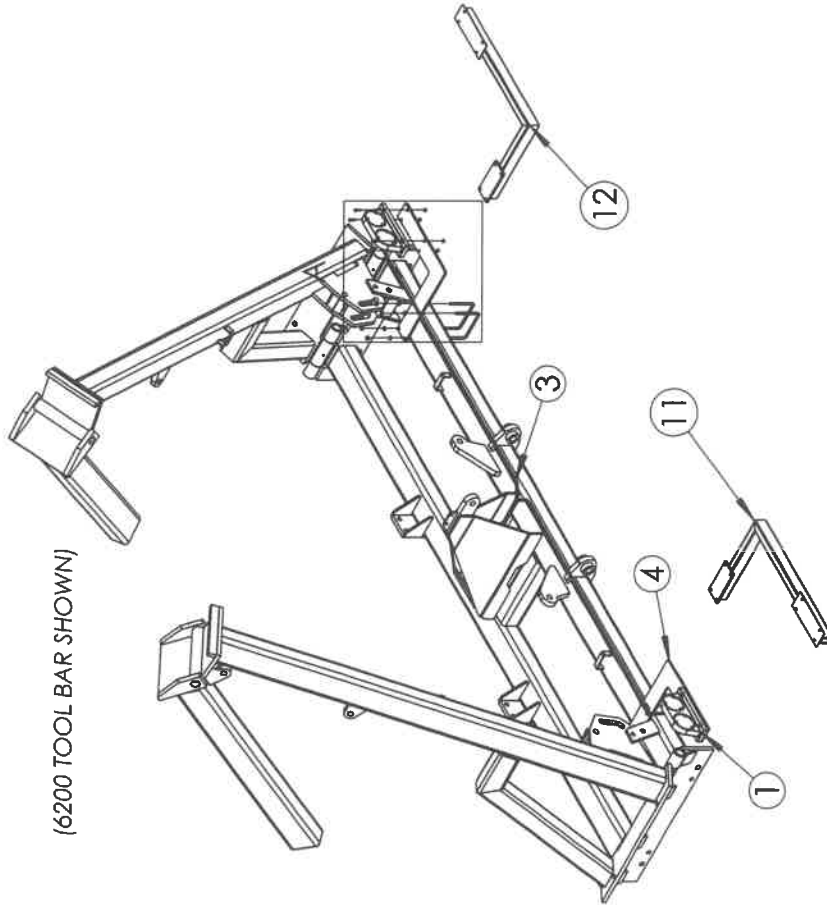

ITEMS 11 AND 12 ARE OPTIONAL

ITEM NO.	PART NUMBER	DESCRIPTION	QTY.
11	47009789	LITE BRACKET, LH	1
12	47009790	LITE BRACKET, RH	1

ITEM NO.	PART NUMBER	DESCRIPTION	QTY.
1	54209-008	DUAL LAMP ASSY, LH	1
2	54209-022	DUAL LAMP ASSY, RH	1
3	71675	35' HD CABLE WITH 7 PIN PLUG	1
4	47009316	LIGHT MOUNTING BRACKET	2
5	47001028	U-BOLT, 3/8-16NC.	4
6	18891200	LOCKWASHER, 3/8 ZC	8
7	18436800	NUT 3/8 NCZC	8
8	18055724	BOLT HX CAP G5 NCZC 1/4 X 1 1/4	8
9	18495700	NUT HX SER FLG 1/4 NC ZC	8
10	504560	NYLON TIE STRAP	5

DETAIL A  
SCALE 1:10

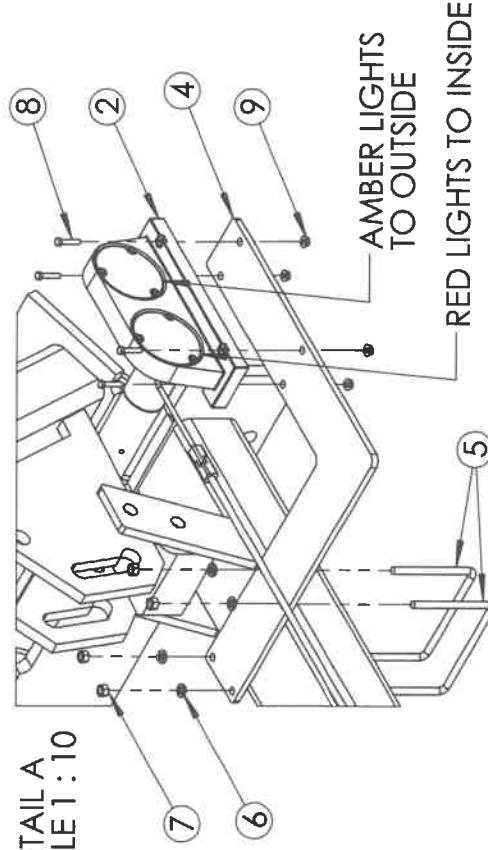

AMBER LIGHTS  
TO OUTSIDE

RED LIGHTS TO INSIDE

AMBER REPLACEMENT LENS PN 802650  
RED REPLACEMENT LENS PN 802651





6000LO11X22  
PROP 06-19-09

# 6000 TOOLBAR (23 FT TOOLBAR)

FOR (11) 22" ROWS  
AG37 COULTERS ONLY

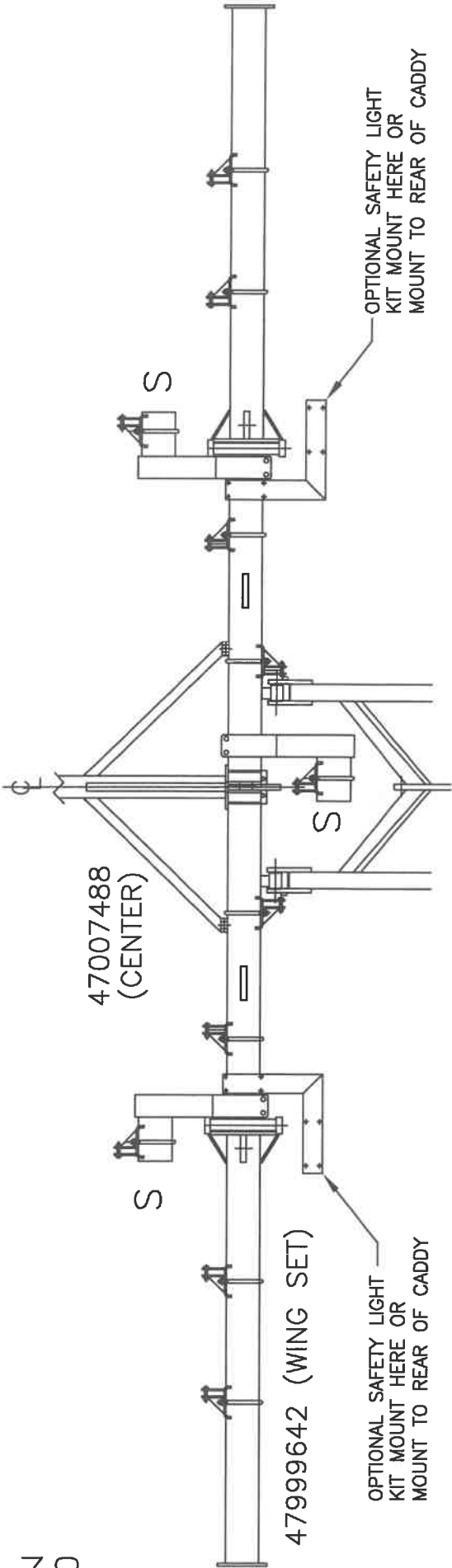

SHOWN WITH WINGS AND STAGGER BRACKETS



# RINSE TANK ASSEMBLY

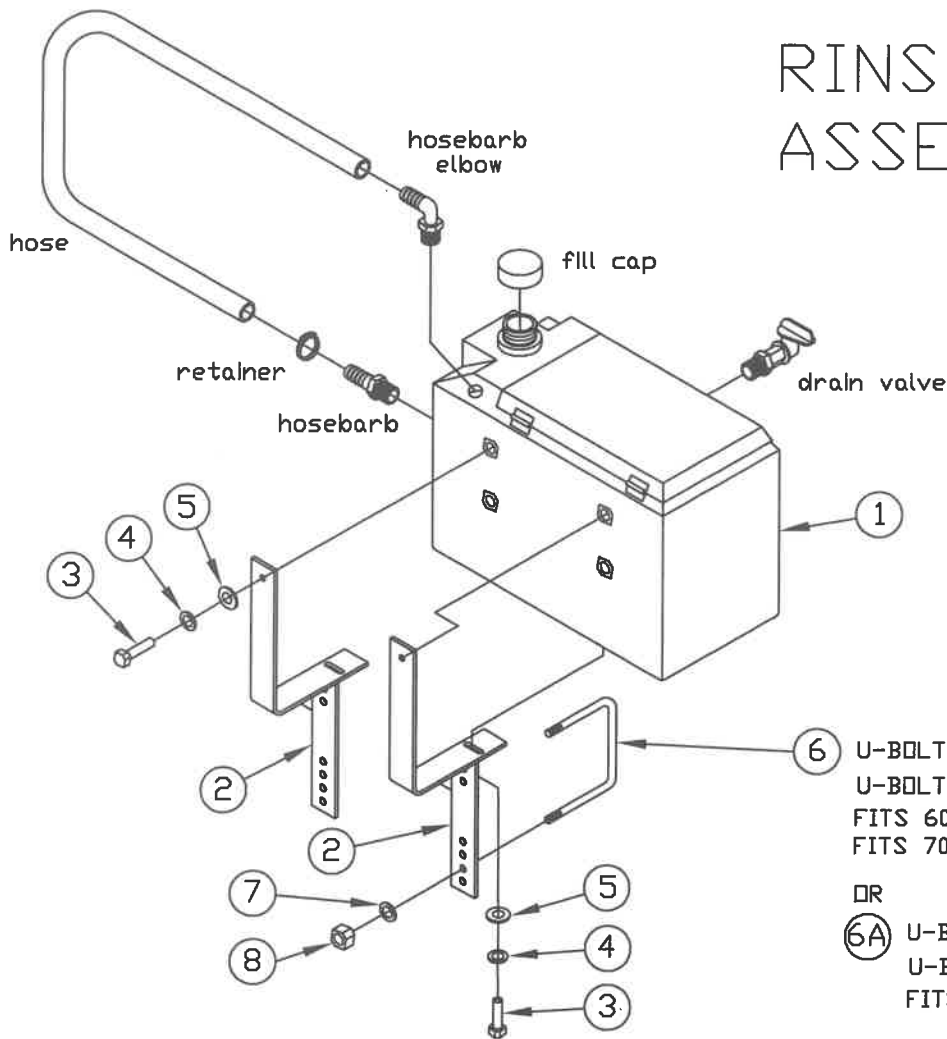

- 6 U-BOLT, FITS 4 X 6 TUBE  
 U-BOLT (4 X 6 TUBE)  
 FITS 6000, 6300, 6400, 6500, 6600  
 FITS 7000, 7200, 7300, 8000, 8500  
 OR  
 6A U-BOLT, FITS 3 X 5 TUBE  
 U-BOLT (3 X 5 TUBE)  
 FITS 6200 ONLY

ITEM	QTY	PARTNUMBER	DESCRIPTION
		601547	COMPLETE RINSE TANK KIT KIT INCLUDES ALL ITEMS 1 THRU 8
		47005781	RINSE TANK MOUNTING KIT INCLUDES ITEMS 2 THRU 8 ONLY
1	1	CRM6000-30	RINSE TANK ASSEMBLY INCLUDES HOSE, VALVE, CAP, AND FITTINGS
2	2	47005780	RINSE TANK BRACKET
3	4	18026422	BOLT, HEX 5/16 X 1/2SS
4	4	18991110	LOCKWASHER, 5/16 SS
5	4	18991100	FLATWASHER, 5/16 SS
6	2	47006545	U-BOLT (4 X 6 TUBE)
6A	2		U-BOLT (4 X 5 TUBE)
7	4	18891400	LOCKWASHER, 1/2 ZP
8	4	18417400	NUT, HEX, 1/2-13 ZP

MOUNTING INSTRUCTIONS  
 MOUNT TO THE LH HITCH POLE  
 WITH BRACKETS ON THE INSIDE  
 OF THE HITCH POLE. DRAIN  
 VALVE ON TANK TO THE  
 OUTSIDE. MOUNT FOR MAXIMUM  
 DRAINAGE THRU SPIGOT USING  
 ADJUSTMENT HOLES.

5781-MANUAL  
 12-03-12

