



Heartland
AG SYSTEMS

Heartland Agriculture, LLC

PRESENTS

MT10
SERIES
TENDER

OPERATOR'S MANUAL
AND PARTS LIST
OM-MT10

HEARTLAND AG SYSTEMS
1180 STATE HWY 7 EAST
HUTCHINSON, MN. 55350
(320) 587-4030

ISSUE
SEPTEMBER 2021

WARRANTY REGISTRATION

TO THE DEALER:

Inspect the implement thoroughly after assembly to be certain it is functioning properly before delivering it to the customer. Check off each item as it is found satisfactory or after proper adjust is made.

PRE -DELIVERY CHECKLIST

- _____ 1. All hardware properly tightened.
- _____ 2. Lubrication of grease fittings.
- _____ 3. All decals properly located and readable.
- _____ 4. Other adjustments, "level operation", "drawbar height", etc.
- _____ 5. Proper tongue weight after all options are mounted. Adjustments made if required.
- _____ 6. Overall condition. Touch-up paint any scratches. Clean and polish
- _____ 7. Operator's manual.

Seller Information	
Date set-up	_____
Signature	_____
Dealer name	_____
Address	_____
City, state, zip	_____
Phone	_____

Review the operator's manual with the customer. Explain the following:

- _____ 1. Safe operation and service
- _____ 2. Correct machine installation and operation.
- _____ 3. Correct and periodic lubrication and maintenance.
- _____ 4. Daily and periodic inspection.
- _____ 5. Troubleshooting.
- _____ 6. Storing machine.
- _____ 7. Heartland AG Systems parts and service
- _____ 8. Have the customer write the machine model and serial number in the space provided in the manual introduction
- _____ 9. Give the customer the operator's manual and encourage the customer to read the manual carefully.

Customer Information	
Date delivered	_____
Customer name	_____
Customer address	_____
Signature	_____
Model number	_____
Serial number	_____

PLEASE FILL OUT THIS SHEET AND RETURN TO HEARTLAND AG SYSTEMS

1180 State Highway 7 East Hutchinson, MN 55350

www.heartlandag.com | Heartland Agriculture, LLC dba Heartland AG Systems

CONTENTS

(MT10 TENDER)

ISSUE MT10CNTS
11-9-20

To The Owner	2
Warranty	W1-8
Safety Decals (DANGER, WARNING, CAUTION)	5
Safety Instructions	6 to 13
Decals and Decal Locations	14 -17
Operating and Transporting The Tender	18
Maintenance and Servicing	19 & 20
Dimensional Specifications	21
MT10 (Mounted On Truck Chassis)	22
Body & Frame Parts (LH side and Rear)	23 & 24
Fender, Brace, & Mudflap Parts Illustration	25 & 26
Engine Drive Option Parts Illustration	27 & 28
Rear Discharge Auger Parts Illustration	29 & 30
Rear Discharge Auger (Top end Assy)	31
Hydraulic Plumbing, w Auger Lift & Shutoff	32 & 33
Hydraulic Plumbing, Engine Drive Option	34 & 35
Hydraulic Lift Cylinder Parts Illustration	36
Wiring Diagram (Light Kit Parts Illustration)	37
Roll Top Parts Illustration & List (Shur-Lok)	38
Roll Top Installation (Shur-Lok)	39

TO THE OWNER

This manual has been prepared to assist you in the assembly of your new equipment and contains information pertaining to safety, operating information and all its parts.

Our personnel in sales and service are always available to assist you when questions arise concerning the assembly and operation of your machine.

When ordering parts, please refer to part numbers and descriptions as listed throughout this book. All parts and whole goods will be shipped FOB Hutchinson, Minnesota. Always check merchandise immediately upon receipt for damage or shortage. Note any discrepancy on the carrier's bill of lading and notify Heartland AG Systems within 10 days.

Any returned goods will be subject to a 20 percent restocking charge.

Heartland AG Systems reserves the right to make improvements and modifications on equipment without obligation to change previously built equipment. All prices are subject to change without notice.

Warranty Policies and Terms

The Heartland Agriculture, LLC warranty is a limited warranty that is provided to the retail purchaser in return for consideration paid as part of the purchase price for a product. The selling dealer must review the warranty coverage with the retail purchaser and obtain a signature on the Operators Manual for warranty verification.

The warranty described here is for Heartland Agriculture, LLC doing business as Heartland AG Systems and its product line Heartland AG Systems Equipment sold and registered in the United States and Canada and normally operated in the United States and Canada.

Warranty Period

The warranty period for all coverage begins at the time that any person, dealer or agent first places the unit into service. At the latest, a unit is placed into service when purchased or delivered to a purchaser.

What's Covered

If a defect in material or workmanship is found in a unit and reported during the Warranty period, Heartland AG Systems will pay parts and labor costs to repair the defects if the services are performed by an authorized Heartland AG Systems dealer. If parts are needed during the repair, Heartland AG Systems will, at its option, use genuine Heartland AG Systems, or remanufactured parts.

Heartland AG Systems provides no warranty, express or implied, for a component or other item that is separately warranted to the purchaser by its manufacturer, such as tires. Check with your local dealer for these details.

Exclusive Remedy

The remedy of repairing a defect in material or workmanship at a Heartland AG Systems dealership under the terms of this warranty is the purchaser's exclusive remedy and is in lieu of any other remedy otherwise available.

No Modification or Extension of Warranty

The Heartland AG Systems Warranty is limited to the written terms in the warranty statement. Heartland AG Systems does not authorize any person, dealer, or agent to change or extend the terms of this warranty in any manner. Any assistance to the purchaser in the repair or operation of any Heartland AG Systems product outside the terms or limitations or exclusions of this warranty will not constitute a waiver of the terms, limitations or exclusions of this warranty, nor will such assistance extend or re-establish the warranty.

The warranty is void if the unit is used in an application for which it is not designed or the unit has been scrapped, salvaged, stolen, junked or totaled.

Limitations and Exclusions

The Heartland AG Systems warranty gives you specific legal rights and you may also have other rights, which vary from state to state. This section contains the entire Heartland AG Systems warranty. Heartland AG Systems makes no other representations or warranties, expressed or implied, and specifically excludes the implied warranties of merchantability and fitness for particular purpose. Heartland AG Systems will not be liable for incidental or consequential damages resulting from a breach of the written warranty or any implied warranty.

- These limitations and exclusions may not be allowed by some states or provinces and shall not apply to the extent such limitations or exclusions are not allowed by applicable state/provincial law.

Owner's Responsibility

The Heartland AG Systems Warranty remains in effect during the warranty period if the owner performs the required maintenance at the recommended intervals outlined in the product's operator's manual and the unit is operated within its rated capacity. Genuine Heartland AG Systems service parts or Heartland AG Systems approved service parts that meet Heartland AG Systems specifications must be used for maintenance and repairs.

What Is Not Covered

- Replacement of non-defective wear items expected to be replaced during the warranty period, including, but not limited to: lights, fuses, belts, drive sprockets and chains, hose, soil engaging tools, spray tips, fertilizer deflectors, spinner blades and accessories or items replaced due to customer demand.
- Normal maintenance parts and service, including, but not limited to lubrication, coolants, and filters.
- All travel costs associated with hauling or towing a customer's machine to and from a repair center related to any warranty repair unless specifically covered by a program or policy.
- Repairs arising from any unauthorized modification to the product.
- Repairs arising from service performed by agents not approved by Heartland AG Systems.
- Repairs arising from storage deterioration, failure to maintain the equipment, improper use of the equipment, collision or other accident, vandalism, or other casualty, or operation beyond the rated capacity or specifications.
- Repairs arising from abuse or neglect including, but not limited to operation without adequate lubricants or coolant, over-speeding, contaminated fluids, improper storage, starting, warm-up, or shutdown practices.
- Failure of the machine, its implements or attachments caused by improper field application or overloading.
- Premiums charged for over-time labor costs.
- Economic loss, including lost profits, crop loss, equipment rental or other expenses.
- Cost associated with cleaning of machine in preparation for service.
- Loss or damage during shipment.



Heartland Agriculture, LLC



- Cost of initial setup or installation of any optional equipment or attachments to a unit.
- Items used for repairs include, but are not limited to: solvents, cleaners, anti-seize lubricants, oil-dry, shop towels, shop supplies, special tools, etc.
- Included, but not limited to are checkups, adjustments, and shimming, tune-ups, spread pattern checks, etc.
- Unauthorized modification or field fixes.
- All costs of special tools or shop supplies incurred with repairs.
- Claims for stolen equipment or parts.
- Claims for replacing a complete assembly when the repair is less than the replacement.
- Claims involving the inspection or reconditioning of units.
- Shop comebacks: any duplicate, repeat, or comeback repair resulting from improper diagnosis, testing, or poor service work.
- Cost of removing or installing Non-Heartland AG Systems optional equipment or attachments.

Base Warranty Coverage

- Base Warranty is the factory warranty provided to the customer at no additional cost for a specific period covering the complete machine.

- Liquid Applicators, except tires 1 Year
- Spreaders and Tenders, except tires 1 Year
- Nh3 Wagons, except tires 1 Year
- Bumper Hitches 1 Year
- Disc Covers 1 Year
- Parts 90 Days
- Tandem Wagons (except tires and main frame) 1 year
 - o Tandem Wagon main frame 5 Years
- Nitromaster Toolbars shall carry the following pro-rated warranty:
 - o Year one, all components except tires 100%
 - o Year two, center section and wings 80%
 - o Year three, center section and wings 50%
 - o Year four, center section and wings 25%
 - o Year five, center section and wings 10%

Tires

Tires installed on all Heartland AG Systems Equipment are warranted and serviced by their manufacturer's service outlets. Some manufacturers have separate service outlets for off road agricultural and construction equipment. Service is available by contacting the tire manufacturer's local representative.

Warranty Registration

All machinery items, which are invoiced by Heartland AG Systems on separate receivables, must be registered for warranty. The warranty period for all coverage begins at the time that any person, dealer, or agent first places the unit into service. New machine warranty coverage begins when the machine is registered. Registration is accomplished when a properly completed Warranty Registration is received and processed by Heartland AG Systems.

Operator's Manual/Warranty Receipt Verification

The Heartland AG Systems New Equipment Limited Warranty for Agricultural Equipment statement must be filled out and signed by the customer indicating receipt and an understanding of the operator's manual and the warranty statement,

- The original form must be mailed to the address on the form.
- Make one copy for the Dealer. This copy must be retained by your dealership the same as any other legal document.
- Make a second copy for the customer.

Heartland AG Systems Responsibility

If a defect in material or workmanship is found in a product during its warranty period, Heartland AG Systems will pay parts and labor costs to repair the defect when the service is performed by an authorized Heartland AG Systems dealer or agent. If parts are needed during the repair, Heartland AG Systems will, at its option, use genuine Heartland AG Systems new or remanufactured parts. These responsibilities include, but are not limited to:

- Costs for repairs that are the result of defects in material and workmanship
- Payment to dealers per policy in a timely manner
- Service information to dealers
- Identify product deficiencies and take corrective action by field campaigns
- Make determination of premature wear
- Provide unit that is free of defects in material & workmanship

Dealer Responsibility

Heartland AG Systems dealers are responsible for providing prompt, courteous, and willing service to all Heartland AG Systems equipment owners. These responsibilities include but are not limited to:

- Equipment set-up and pre-delivery
- Sell the right product for the intended application
- Inspect the unit and initiate recovery action on any shipping damage and or shortages
- Instruct customer on proper use, maintenance, and safety features of machine
- Advise and explain warranty coverage to customer
- Diagnose the problem, repair the unit, and submit claims in accordance with the terms and conditions of the warranty claim policies
- Take responsibility for saying "NO" to customers on non-warranty failures
- Apply failure analysis to questionable repairs
- Complete product update campaigns
- Have properly trained technicians and adequate tools for the job
- Retain proper documentation of failure repaired

Owners Responsibility

The Heartland AG Systems warranty remains in effect during the stated warranty period if the owner performs the required maintenance at the recommended times as outlined in the products operator's manual. Genuine Heartland AG Systems or Heartland AG Systems approved service parts must be used for maintenance. Additionally, the owner will pay for all transportation or travel expenses related to any warranty repair.

These responsibilities include, but are not limited to:

- Perform maintenance as indicated in the operator's manual
- Use the unit in the correct application (non-abusive)
- Notify dealer of failures and have the machine available for repair in a timely manner
- Training operators
- Travel cost, towing charges, and service calls
- Normal wear items
- Machine damage (accidental)
- Adjustments for application
- Machine inspection (daily walk-around)

Warranty Eligibility

The dealer is responsible to determine that any Heartland AG Systems equipment is covered by Heartland AG Systems warranty before performing a repair and that the repair is a warrantable failure. Any dealer who is in doubt of the equipment's warranty eligibility may call Heartland AG Systems for verification.

Warranty Repairs Made by the Customer

If a Heartland AG Systems dealer determines that the customer is capable, and the customer requests permission to perform select(warranty)repairs on his product, the Heartland AG Systems dealer is authorized to grant this customer request. The servicing dealer should provide the parts to the customer upon request, and to assure that customer is properly instructed on how to perform the repairs correctly.

The servicing dealer is responsible and accountable for claim accuracy and validity; specifically, in areas such as the parts replaced date, and assurances that the parts are installed as instructed by Heartland AG Systems. The comments section of the claim should clearly state that the customer installed the parts. The claim reimbursement will be for parts and applicable handling only. No labor is allowed! All replacement parts must be held for possible recall.

Parts Shortages on Whole-Goods

Dealers may submit a claim for parts shortages discovered during pre-delivery or during final assembly at the dealer's location. All claims for shortages must be submitted 5 days from the original ship date from the plant and before the warranty start date.

Warranty Reimbursement Policies

Heartland AG Systems provides for warranty reimbursement due to defects in material or workmanship only. Warranty does not include restoring any machine or portion thereof, which has accumulated hours of operation, to factory new condition. This includes customer owned and used equipment.

Except for only a few items not available through Heartland AG Systems, all Heartland AG Systems manufactured equipment warranty repairs must be performed using only Heartland AG Systems genuine new or remanufactured parts and accessories. Installation of non-Heartland AG Systems parts does not qualify for warranty reimbursement and can void the machine's warranty.

Parts

It is fully expected that all claims be filed using part numbers from the applicable Heartland AG Systems equipment parts book whenever such part number exists. Heartland AG Systems shall reimburse the dealer at the dealer net price (cost) in effect on the parts replaced date.

Labor

Heartland AG Systems shall reimburse the dealer at 80% of the dealer's posted retail shop labor rate. The retail shop labor rate shall be subject to verification by Heartland AG Systems from copies of actual dealer invoices to customers.

Outside Charges

Specialized repair such as that done by a machine shop will be accepted as part of a warranty claim at actual cost. Explain the parts used and the service work performed in the description section of the claim and retain a copy of the receipt. Retain a copy of the invoice with the shop work order to support the claim. Outside repairs that exceed the cost of the same repair, if performed by the dealer, will be reimbursed at a lower rate.

Freight



Heartland AG Systems will pay the freight charges when a warranty recalled part is to be returned to Heartland AG Systems.

Travel

Travel will only be reimbursed when authorized by a field campaign.

Repairing or Replacing Parts and Components

When performing a warranty repair, a complete part or component should not be replaced under warranty if the repair can be accomplished at a lower cost. If the total cost of the repair including the cost of parts, labor, and/or outside labor or materials is less than 75% of the cost of the parts, the part must be repaired.

Filters and Lubricants

Replacement of lubricants and filters do not qualify for warranty reimbursement unless damage caused by a defect in material or workmanship results in contamination or sudden loss of fluid. Lack of maintenance, operator misuse, or neglect will not qualify for warranty reimbursement.

Claim Form Guidelines

Claims Must Have

1. Product identification number (PIN) or serial number. All characters of the PIN must be used on the warranty claim.
 - Claims for parts warranty must use the word "PARTS" for the PIN. An invoice that shows date of sale or date of installation must be supplied for all parts claims.
2. Model Number
3. Date of failure – Claims must be submitted within 30 days or repair.
4. Date of repair
5. Warranty start date. Date the unit warranty starts or date the parts were sold for parts warranty.
6. Description of the problem. Describe all problems pertinent to the claim.
Comments should be as precise as possible, attach a separate sheet if necessary, to describe the problem.
7. Description of the work performed. List each significant action of the repair.
8. Itemize labor. Provide a breakdown of labor for each significant repair action in the "Describe Work Performed" column.
9. Shop order numbers. The shop order number field is used for recording your shop work order number that is related to the claim. The shop order number field can also be used to record the parts invoice number when claiming a parts warranty.
10. Customer information. Customer information includes the customer name, city, state, county, and postal code. It must match the warranty registration.
11. Warranty claim total. The total of all reimbursement costs requested.
12. Dealer signature and date. All claims must be signed and dated by the distributor to be validated.



THIS MESSAGE ALERT SYMBOL INDICATES IMPORTANT SAFETY MESSAGES IN THIS MANUAL. WHEN YOU SEE THIS SYMBOL, CAREFULLY READ THE MESSAGE THAT FOLLOWS AND BE ALERT TO THE POSSIBILITY OF PERSONAL INJURY OR DEATH.

Safety Decals on this machine use the words **Danger, Warning or Caution**, which are defined as follows:

- **DANGER:** Indicates an immediate hazardous situation which, if not avoided, will result in death or serious injury. The color associated with Danger is RED.
- **WARNING:** Indicates a potentially hazardous situation which, if not avoided will result in serious injury. The color associated with Warning is ORANGE.
- **CAUTION:** Indicates a potentially hazardous situation which, if not avoided, may result in minor or moderate injury. It may also be used to alert against unsafe practices. The color associated with Caution is YELLOW.



WARNING

IMPROPER OPERATION OF THIS MACHINE CAN CAUSE INJURY OR DEATH. BEFORE USING THIS MACHINE, MAKE CERTAIN THAT EVERY OPERATOR:

- Is instructed in safe and proper use of the machine.
- Reads and understands the Manual(s) pertaining to the machine.
- Reads and understands ALL Safety Decals on the machine.
- Clears the area of other persons.
- Learns and practices safe use of machine controls in a safe, clear area before operating this machine on a job site.

It is your responsibility to observe pertinent laws and regulations and follow Case Corporation instructions on machine operation and maintenance.

The following chapter covers recommended safety instructions, along with other general recommendations and specific machine safety precautions that should be read thoroughly before operating the machine.

Safety

Read and comply with the operators manual and safety instructions before operating the machine.

Understand that your safety and the safety of other persons is measured by how you service and operate this machine. Know the positions and operation of all controls before you try to operate. **Make sure you check all controls in a safe area before starting your work.**

Read this manual completely and all other manuals provided with this vehicle, plus make sure you understand the controls. All equipment has a limit. Make sure you understand the speed, brakes, steering, stability, and load characteristics of this machine before you start to operate.

The safety information given in this manual does not re place safety codes, insurance needs, federal, state, and local laws. Make sure your machine has the correct equipment required by local laws and regulations.

Case Corporation is continuing to work for your safety by making tenders with better protection and by giving these rules for safe operation.



WARNING: THIS SAFETY ALERT SYMBOL INDICATES IMPORTANT SAFETY MESSAGES IN THIS MANUAL. WHEN YOU SEE THIS SYMBOL, CAREFULLY READ THE MESSAGE THAT FOLLOWS AND BE ALERT TO THE POSSIBILITY OF PERSONAL INJURY OR DEATH.



Personal Safety

Throughout this manual and on the machine's safety decals, you will find precautionary statements: **DANGER,WARNING,** or **CAUTION** followed by specific instructions or ISO two panel safety pictorial symbols. These precautions are intended for your personal safety.

Failure to follow the **DANGER,WARNING,** or **CAUTION** instructions may result in serious bodily injury or death.

- **DANGER:** Indicates an immediate hazardous situation that, if not avoided, will

result in death or serious injury. The color associated with Danger is RED.

- **WARNING:** Indicates a potentially hazardous situation that, if not avoided, could result in death or serious injury. The color associated with Warning is ORANGE.
- **CAUTION:** Indicates a potentially hazardous situation that, if not avoided, could result in minor or moderate injury. It may also be used to alert against unsafe practices. The color associated with Caution is YELLOW.
- ISO two panel **pictorial symbol decals** are defined as follows:
- The first panel indicates the nature of the hazard.
- The second panel indicates the appropriate avoidance of the hazard.
- Background color is YELLOW.
- Prohibition symbols such as   and  if used, are RED.

Safety Rules

- DO NOT operate or service this machine unless you have read and understood the Operators Manual and have been properly trained in the machine's operation.
- Before starting the engine, be sure all operating controls are in neutral or park position. This will eliminate accidental movement of the machine or start up of power driven equipment.
- This machine requires an operator at all times. Never leave the machine running and unattended.
- ALWAYS be sure the work area is clear of persons before operating the machine. NEVER allow anyone in the work area during machine operation. DO NOT allow inexperienced persons to operate this machine.
- Sound horn of tow vehicle before operating the machine.
- **No Riders** - A frequent cause of personal injury or death is persons falling off and being run over. Do not permit others to ride.
- For road travel, use flashing warning lamps unless prohibited by law and keep SMV visible.

- ALWAYS put the controls in neutral, shut the engine off, apply the parking brake, and remove the key BEFORE exiting the tow vehicle.
- Extra weight and bad traction conditions, such as mud or ice, increase your stopping distance. Remember, a loaded machine increases the distance needed to stop.
- DO NOT smoke while servicing the machine.
- DO NOT operate the machine while under the influence of alcohol or drugs.
- Hydraulic oil or diesel fuel are high pressured systems. Make sure all lines and fittings are tight and in good condition. These fluids, escaping under pressure, can have sufficient force to penetrate skin and cause serious injury. Failure can result in serious injury or death.
- Escaping hydraulic fluid under pressure can have sufficient force to penetrate skin, causing serious injury. NEVER check for leaks by using any part of your body to feel for escaping fluid.
- Before servicing the machine, make sure the machine has cooled down. Hydraulic components can get hot enough to cause serious injury.
- After servicing the machine ALWAYS replace guards and shields. NEVER operate your machine with guards and shields removed.
- Be aware of all pinch points on the machine and keep clear.
- Keep bolts tight at all times. Always replace worn or broken parts immediately after they are discovered. Do not use the vehicle if any parts are not functioning properly.
- Do not replace parts with other than genuine factory parts. Doing so could decrease the effectiveness of safety features or the accuracy of the machine.
- This machine is designed for the farming industry. Comply with your local and state laws governing weight, lighting, licensing, overhang, bumpers, maximum width, transportation of chemicals, and any other regulations that might apply.

Safety

- When disconnecting battery terminals, remove the Negative (-) cable first; then remove the Positive (+). When connecting cables, connect the Positive (+) first, then connect the Negative (-).
- Disconnect the battery (both terminals) before welding on any part of the machine.

Failure to do so may cause damage to sensitive electrical components.

- **BATTERY ACID CAUSES SEVERE BURNS.** Batteries contain sulfuric acid. Avoid contact with skin, eyes or clothing. Antidote: **EXTERNAL** - flush with water. **INTERNAL** - drink large quantities of water or milk. Follow with milk of magnesia, beaten egg or vegetable oil. Call physician immediately. **EYES** - flush with water for 15 minutes and get prompt medical attention. **BATTERIES PRODUCE EXPLOSIVE GASES.** Keep sparks, flame and cigarettes away. Ventilate when charging or using in enclosed space. Always shield eyes when working near batteries. **KEEP OUT OF REACH OF CHILDREN.**
- When working around stage batteries, remember that all of the exposed metal parts are "live". Never lay a metal object across the terminals because a spark, short circuit, explosion or personal injury may result.

Electrical Line Safety

- Know the area before operating the machine. Be aware of power lines, electrical boxes, debris and rocks.
- Watch for adequate overhead clearance when operating the machine.

Machine Operation and Roll-Over Safety

- **DO NOT** ride or allow other persons to ride on the machine. Riders can fall or can cause an accident.
- **DO NOT** operate the machine while under the influence of alcohol or drugs.
- Be alert and always know the location of all workers in your area. keep all other persons completely away from your machine. Injury or death can result if you do not follow these instructions

Noise Level Safety

- Exposure to high noise levels may cause hearing loss. Wearing suitable hearing protective devices protects against loud noise.

Hazardous Chemicals

- If you are exposed to or come in contact with hazardous chemicals you can be

seriously injured. The fluids, lubricants, paints, adhesives, coolants, etc., used with your machine can be hazardous.

- Material Safety Data Sheets (MSDS) provide information about the chemical substances within a product, safe handling procedures, first aid measures and procedures to be taken when the product is accidentally spilled or released. MSDS are available from your chemical dealer. It is the operator's responsibility to be familiar with the safe handling of the chemical used.
- Before you service your machine, check the MSDS for each fluid, lubricant, etc., used in this machine. This information indicates what the risks are and how to service the machine safely. Follow this information when servicing the machine.
- Before you service this machine and before you dispose of the old fluids and lubricants, always remember the environment. DO NOT put oil or fluids into the ground or into containers that can leak.
- Check with your local environmental or recycling center or your dealer for correct disposal information.
- Personal Protective Equipment (PPE) is protective gear worn by pesticide handlers as specified in the use directions on a pesticide label.

Maintenance Safety

- Before you service the machine, place a Do Not Operate tag on the machine.
- Always keep safety and informational decals clean and visible. Replace decals that are damaged, lost, painted over or can not be read.
- When assembling, operating or servicing the machine, wear protective clothing and personal safety devices that are necessary for the particular procedure. Some personal safety devices that may be necessary are protective shoes, face and/or eye protection, hard hat, heavy gloves, filter mask and hearing protection.
- DO NOT wear jewelry or loose fitting clothing that may get caught in moving parts. Always wear close fitting clothing. Keep hands, feet, clothing and hair away from moving parts.
- Never attempt to clear obstructions or objects from the machine while the engine is running.
- Always stop the engine and remove the key from the key switch when leaving the operators seat or the machine.
- When servicing the machine, always have the machine on a firm level surface.

- If shield or guards are removed or opened for service, always replace them before operating the machine. Never operate the machine with missing or open shields or guards.
- Keep the area used for servicing the machine clean and dry. Wet or oily floors are slippery. Wet spots can be dangerous when working with electrical equipment. Be sure all electrical outlets and tools are properly grounded.

Tire Inflation

Consult your vehicles operator's manual for proper tire inflation.

First Aid Kit

It is recommended that you have a First Aid Kit on the job site and in your maintenance area.

Read Operators Manual

Decals which display the "Read Operators Manual" symbol are intended to direct the operator to the Operators Manual for further information regarding safety, maintenance, adjustments and/or procedures for specific areas of the machine.

When a decal displays symbol shown, refer to the appropriate page of the Operators Manual. Refer to the Detail Index at the end of this manual for locating specific items about your machine.

Fire Extinguisher

It is recommended that you have a fire extinguisher on your machine. A fire extinguisher is available from your dealer and can be installed on your machine.

This dry chemical fire extinguisher is approved for Class A, B and C type fires. The operating temperature is -54° to 49°C (-65° to 120°F).

Hand Signals

It is recommended that all persons on the job site use hand signals for communications. Before you start, make sure all persons understand the signals that will be used.

Start Engine



Stop Engine



227L95

Come To Me

Move hands forward and rearward - palms in



Move Away from Me

Move hands forward and rearward - palms out



228L95

Go This Far



All Stop and Hold



229L95

Stop

Move one hand back and forth



Emergency Stop

Move both hands rapidly back and forth



222L95

Turn Machine Left

To stop movement, stop moving hand and make a fist

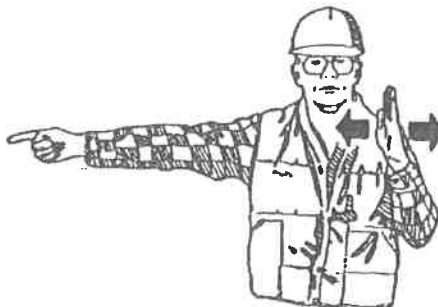

Turn Machine Right

To stop movement, stop moving hand and make a fist



225L95

PICTORIAL OF DECALS
MT8 - MT10



29369



12429A



12181A

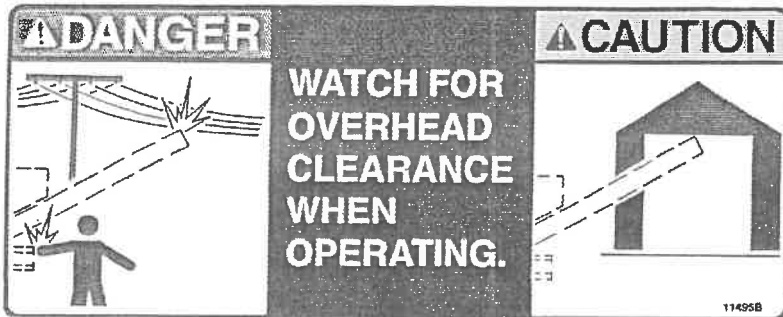

11495A

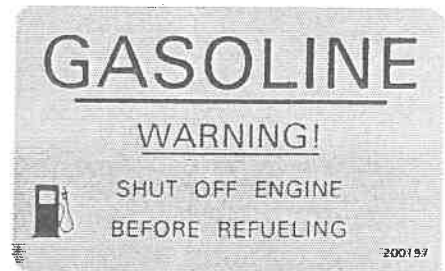

200197

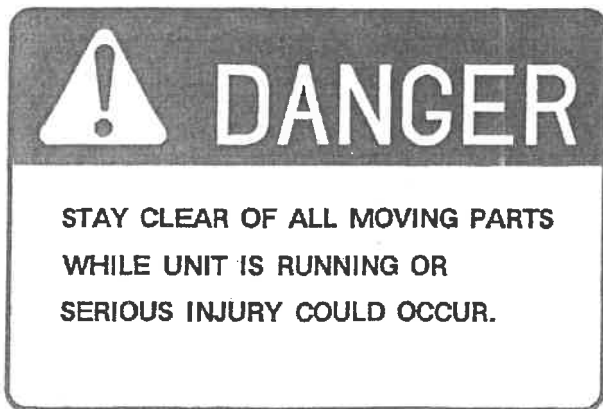

12182B



276534

DECALS

- | | | | |
|--------|---------------------------------------|--------|-----------------------------------|
| 11495A | Decal-Overhead Caution
(see below) | 54130A | Decal-Logo w/Tyler (see below) |
| 12181A | Decal-Guard (see page 9) | 54131 | Decal-Stripe (see below) |
| 12182B | Decal-Safety Alert (see below) | 200197 | Decal-Gasoline (see page 17) |
| 12429A | Decal-Caution (see below) | 276534 | Decal-Hydraulic Oil (see page 16) |
| 29369 | Decal-Made By Tyler | | |
- * Location of serial number plate.

SEE PAGE FOR PICTORIAL OF DECALS

DECAL LOCATION - BODY -

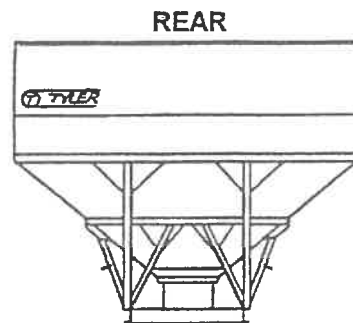
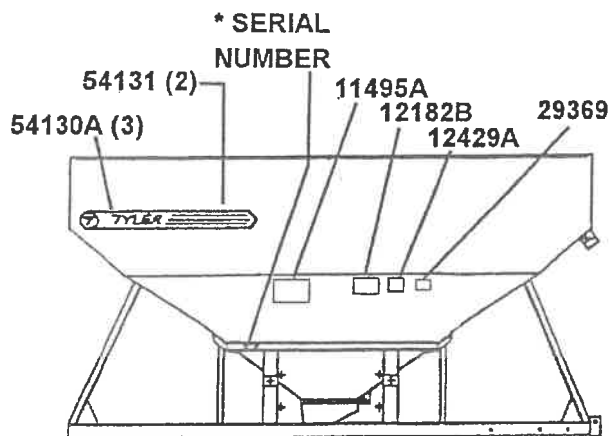

SHOWN W/O FENDERS

DECAL LOCATION

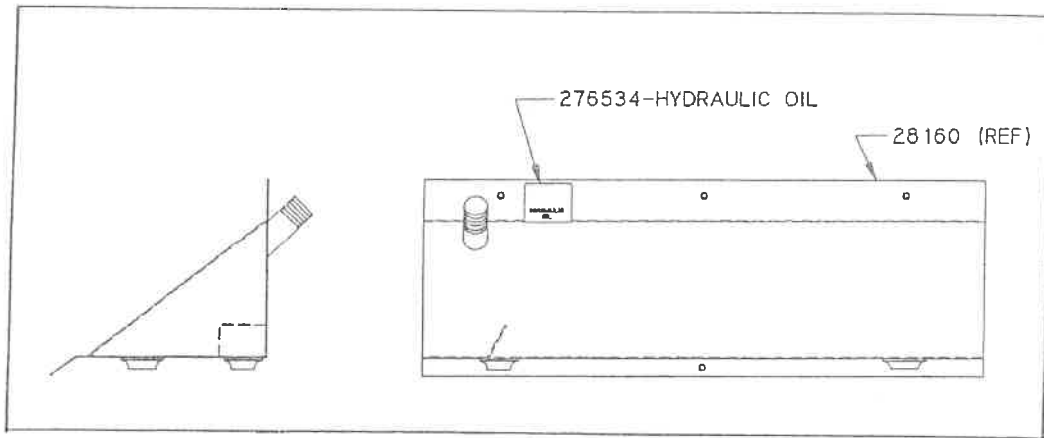

- ON
HYD.
TANK
(BULKHEAD
MOUNTED)

USED WITH ENGINE DRIVE UNITS ONLY

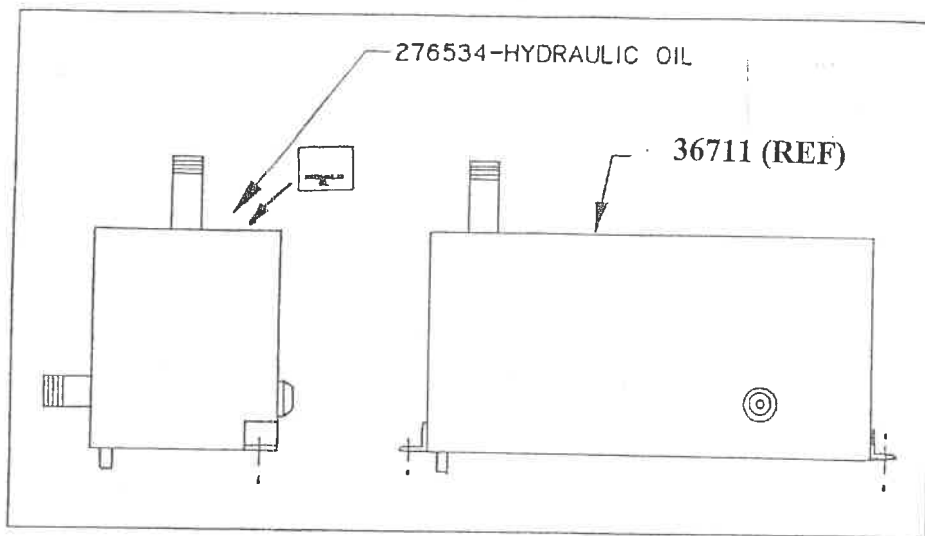

- ON
HYD.
TANK
(FRAME
MOUNTED)

USED WITH FRAME MOUNTED UNITS ONLY

MT10 SERIES TENDER

FUEL TANK DECAL PLACEMENT ILLUSTRATION (RH FRONT SIDE VIEW) (ENG MOUNT UNIT ONLY)

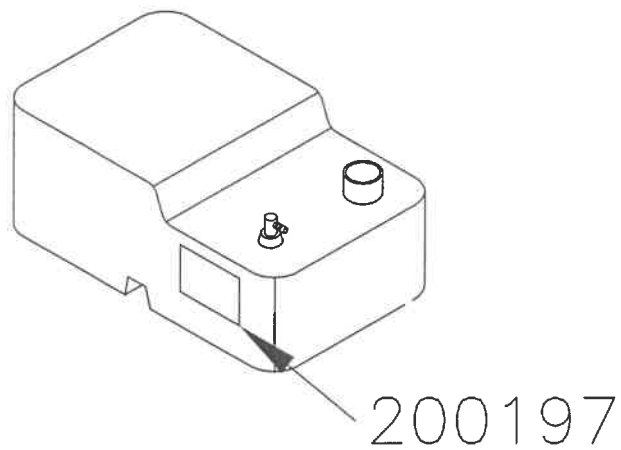

LOCATE APPROXIMATELY AS SHOWN

MT10decal
01-09-08

OPERATING AND SERVICE INSTRUCTIONS

UPON RECEIVING YOUR NEW TENDER

When you receive your new TENDER, be sure that all shipping fasteners are removed prior to operation. Check unit for screws, bolts, fittings and set screws that may have come loose during shipment.

TRANSPORTING THE TENDER

Before transporting the unit, check to make sure it is secured to the truck bed, trailer, etc. Be sure that the tarp and auger are properly secured in place.

OPERATING THE TENDER

See that the cleanout door is shut and properly secured. Always have the auger running before opening the hopper gate. Always shut the gate and empty the auger before shutting the auger off.

TRUCK HYDRAULIC

At engine speed (1750 rpm) the hydraulic pump should be putting out 18 - 20 gpm. (Auger speed on hydraulic unit is approximately 375 rpm.)

ENGINE/HYD.

Follow the manufacturer's recommendations in the maintenance manual. Check to see the engine has proper oil level before starting.

UNIT

Make sure auger is in the down position before transporting. See that the cleanout door is shut and properly secured before loading. Always have the auger running before opening the hopper gate. Always shut the gate and empty the auger before shutting the auger off.

Daily Machine Maintenance

Overnight Storage

Avoid overnight storage of material in machine if at all possible.

Build-up Of Material

Hosing the machine out with water after each day's use will eliminate build-up if this is done before the material has hardened. The auger may be cleaned by unloading dry gravel or similar abrasive materials. Stainless units should be washed regularly, especially 409 stainless because fertilizers containing chlorides will pit and discolor the metal.



Caution: All residue that is washed off the tender must be disposed of in accordance with local, state, and federal EPA regulations.

Tarp

Loosen the tarp or open Flip top (or Roll tarp) so any excess moisture can escape.

Weekly Machine Maintenance

Greasing

Grease all fittings every 75 hours of operation. Use only one (1) pump of a standard grease gun per application. DO NOT USE AN AIR GUN.



Important: Do not over-grease. Over-greasing will break the seals on the bearings and allow fertilizer and dirt into the bearing; thereby, causing bearing failure.

Between Season Maintenance

Hopper Body

Clean all the old fertilizer out of the unit and wash it down thoroughly. Touch up with a rust preventative paint where needed. Clean and lubricate guides for hopper gates.

Auger

Clean auger by running coarse gravel or some other abrasive material through auger until cleaned. Be sure the clean out door is left open.



Caution: All residue that is washed off the tender must be disposed of in accordance with local, state, and federal EPA regulations.

Unit

- Remove the tarp or open and secure Flip top (or Roll tarp) to prevent moisture from being trapped inside the hopper.
- If equipped with engine, remove the battery and store inside.
- If stored outside, cover the engine with a cover or tarp of some kind.

Care Of The Roller Chain

To prevent freezing of the roller chain due to rusting, remove and store submerged in fuel oil between seasons. Do not use regular oil for this purpose.

MT8-MT10 DIMENSIONAL SPECS. (REAR AUGER)

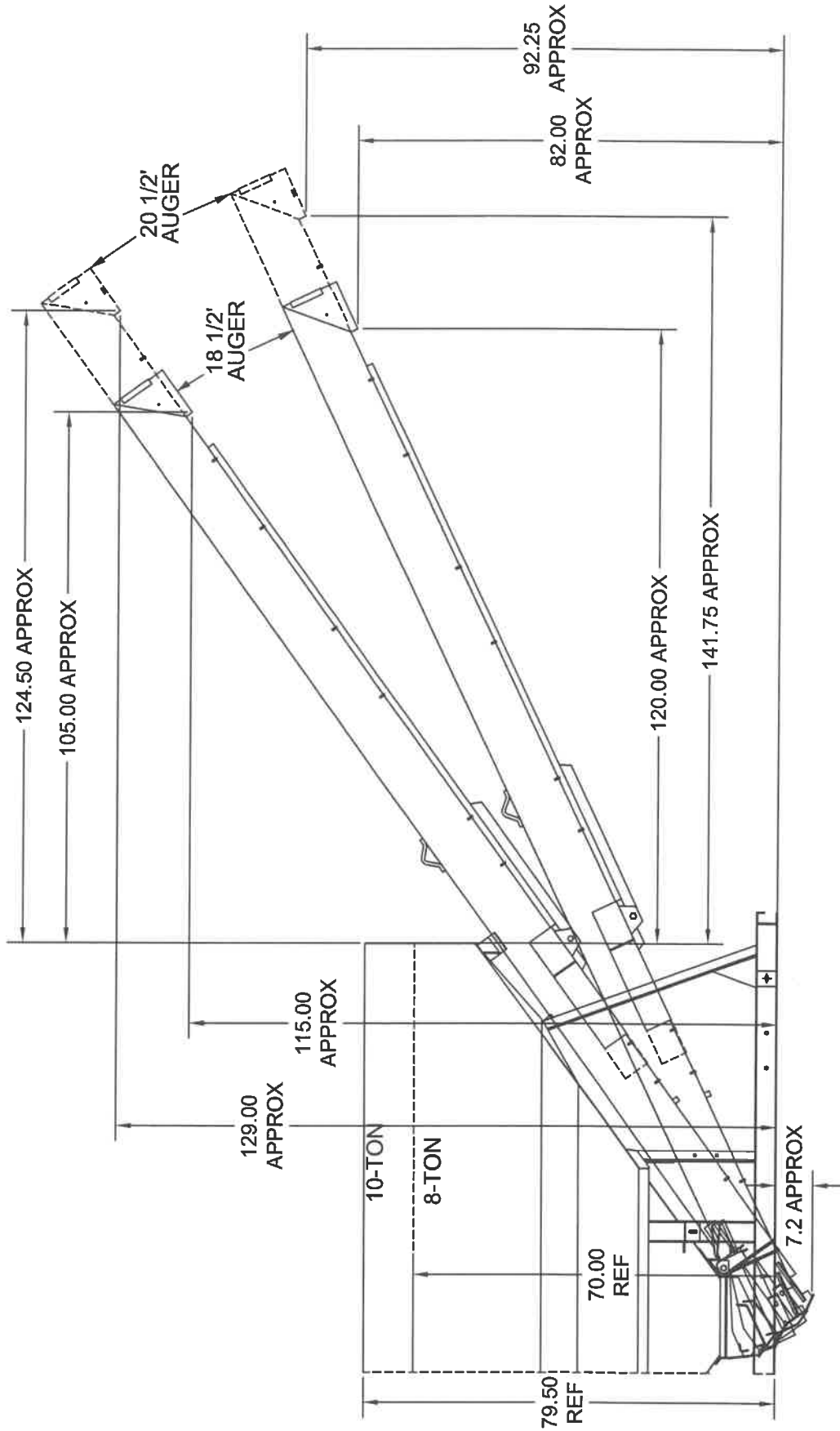

**RECOMMENDED TRUCK CHASSIS
DIMENSION & PLACEMENT**

(Ref. Drwg. 38682)

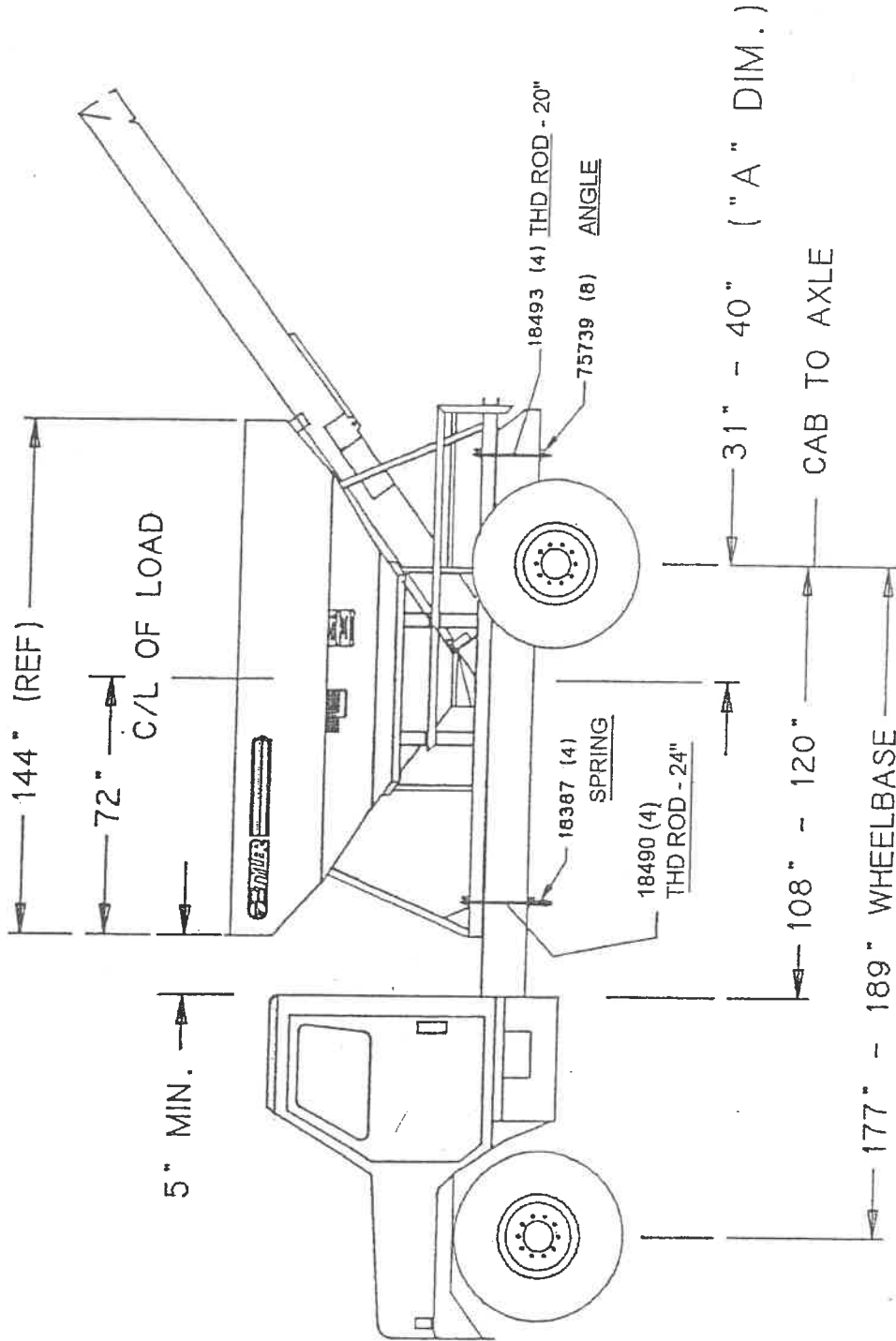

RECOMMENDED TRUCK CHASSIS DIM. & UNIT PLACEMENT

INFO SHOWN
IS FOR
MT8

NOTES:

MT-10 SERIES TENDER
 BODY AND FRAME
 ILLUSTRATION
 LH SIDE VIEW

MT10BODYISO
 05-27-15

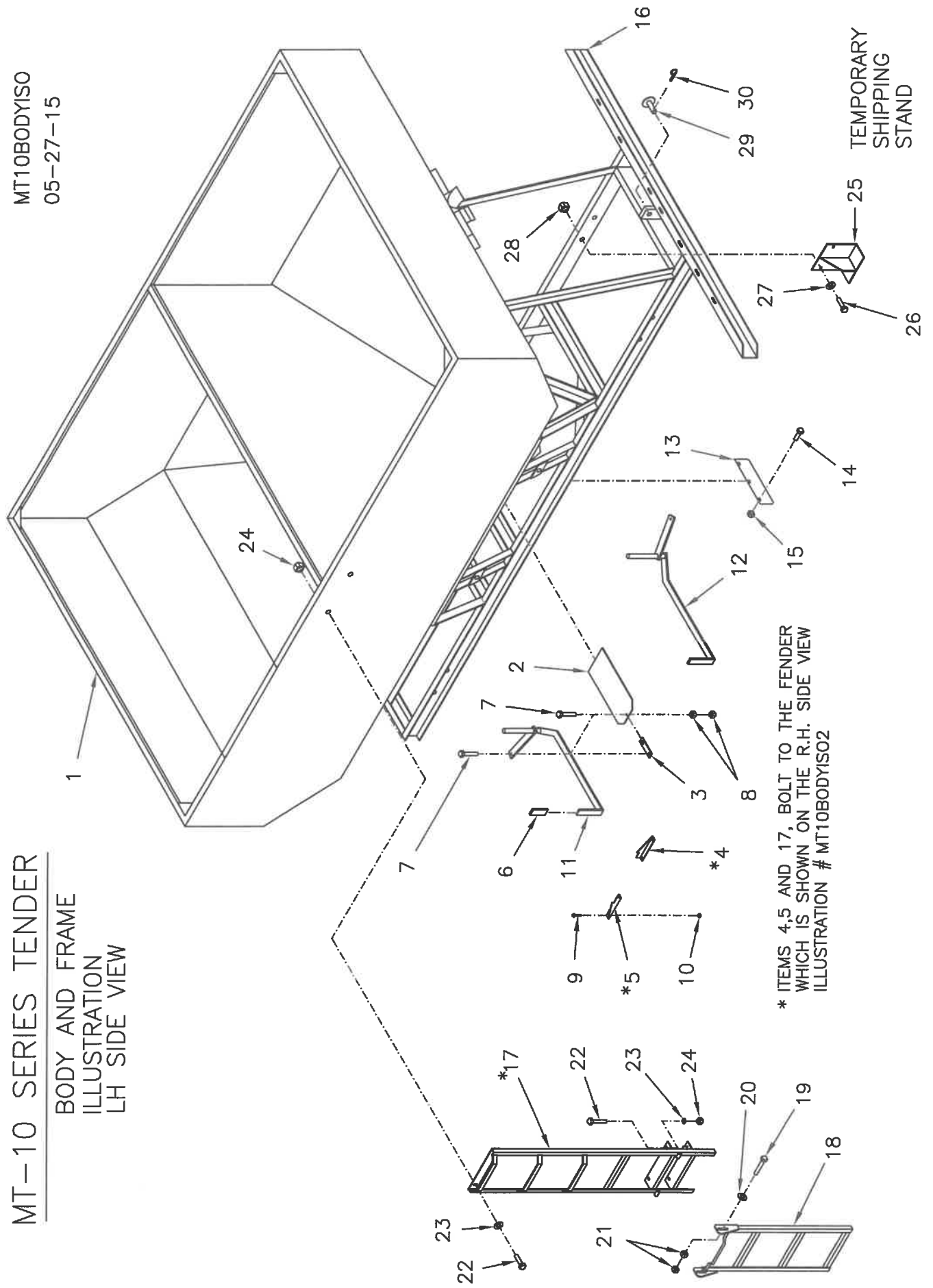

MT-10 SERIES TENDER
 BODY AND FRAME ILLUSTRATION
 LH SIDE PARTS LIST

MT10BODYLST
 05-27-15

ITEM	PART NO.	DESCRIPTION	QTY
1	39296	BODY & FRAME WELDMENT	1
2	18889A	GATE PLATE	2
3	28111A	LINKAGE	2
4	28109	ARM STOP, REAR	1
5	28109	ARM STOP, FRONT	1
6	54143A	VINYL HANDLE GRIP	2
7	18026826	BOLT, 3/8-16NC. X 1 1/2 SS	8
8	18476800	HEX. NUT, 3/8-16NC SS	16
9	18026424	BOLT, 5/16-18NC. X 1 1/4 SS	8
10	18987700	FLANGE NUT, 5/16-18NC SS	8
11	_____	HANDLE, LEFT HAND	1
12	_____	HANDLE, RIGHT HAND	1
ITEMS 11 & 12 ARE WELDED IN PLACE AT ASSY FOR REPAIR PARTS ORDER-			
	28112	SHAFT, 1" DIA. X 10 1/2	
	28113	COMMON ARM	
	28114A	HANDLE, LEFT HAND	
	28115A	HANDLE, RIGHT HAND	
13	28384	SEAL RUBBER FLAP	1
14	18026424	BOLT, 5/16-18NC. X 1 1/4 SS	3
15	18987700	FLANGE NUT, 5/16-18NC SS	3
16	18274C	BUMPER, (WELDED ON)	1
17	28124A	UPPER LADDER WELDMENT	1
18	28125	LOWER LADDER WELDMENT	1
19	18027438	BOLT, 1/2-13NC. X 3 SS	2
20	18824800	FLAT WASHER, 1/2 SS	2
21	18997400	HEX. NUT, 1/2-13NC. SS	4
22	18026822	BOLT, 3/8-16NC. X 1 SS	4
23	18991200	FLATWASHER, 3/8" SS	4
24	18987900	FLANGE NUT, 3/8-16NC. SS	4
25	22197	SHIPPING STAND	4
26	18027438	BOLT, 1/2-13NC. X 1 1/4 ZC	8
27	18851400	FLAT WASHER, 1/2 ZC	8
28	18457600	LOCK NUT, 1/2-13NC. ZC	8
29	23177	PIN (439-51644)	1
30	71077	HAIRPIN CLIP 3/16 #8	2

ITEMS 4 AND 5 ARE BOLTED TO LH FENDER

ITEMS 25 TO 28 ARE USED FOR STORAGE AND TRANSPORT ONLY. MAY BE RETURNED FOR CREDIT.

MT-10 SERIES TENDER
BODY AND FRAME ILLUSTRATION
RH SIDE VIEW
FENDER, BRACE, & MUD FLAP MOUNTING

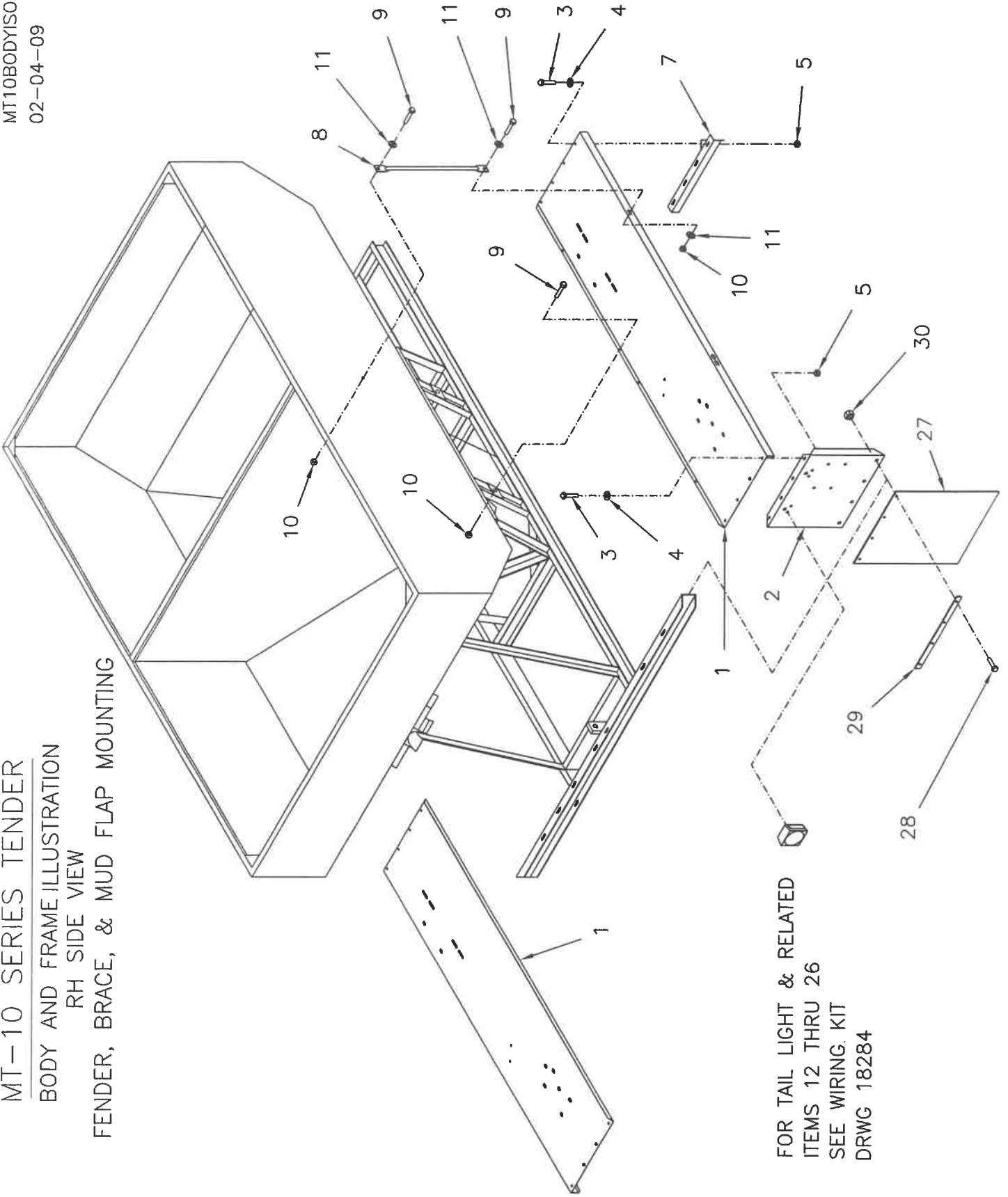

FOR TAIL LIGHT & RELATED
ITEMS 12 THRU 26
SEE WIRING KIT
DRWG 18284

MT-10 SERIES TENDER
 BODY AND FRAME ILLUSTRATION
 RH SIDE VIEW

MT10BODYISO2LST
 02-04-09

ITEM	PART NO.	DESCRIPTION		QTY
		FENDER KIT, INCLUDES ITEMS 1 THRU 11		
1	28105A	FENDER		2
2	28106	FENDER MOUNT		2
3	18026418	BOLT, 5/16-18NC. X 3/4	SS	16
4	18991100	FLAT WASHER, 5/16	SS	24
5	18987700	FLANGE NUT, 5/16-18NC.	SS	16
6	28163	MOUNT WELDT, LH (NOT SHOWN)		1
7	28164	MOUNT WELDT, RH FENDER LIGHT		1
8	28108	BRACE TUBE		1
9	18026822	BOLT, 3/8-16NC. X 1	SS	12
10	18987900	FLANGE NUT, 3/8	SS	12
11	18991200	FLAT WASHER, 3/8-16NC.	SS	16
	28340	LIGHT KIT INCLUDES ITEMS 12 THRU 26 (SEE DRWG 18284)		
12	01829	TAIL LIGHT, LH (WITH LIC. ILLUM.)		1
13	01836	TAIL LIGHT, RH		1
14	18026422	BOLT, 5/16-18NC. X 1	SS	10
15	18881001	FLAT WASHER, 1/4	SS	10
16	18103	LIGHT, VBAR COMB. (RED LENS)		3
17	18104	LIGHT, VBAR COMB. (AMBER LENS)		2
18	18457600	NUT. CTR LOCK 5/16-NC ZC	ZC	10
19	41859	CLAMP, VINYL COVERED 9/16		10
20	18415812	NUT HEX. #10-24NC.	ZC	10
21	18475700	NUT HEX. 1/4-20NC.	ZC	4
22	57182	CLIP, LARGE FRAME		6
23	57183	SPLICE CONNECTOR		1
24	57177	WIRE HARNESS W LOOM, FRONT		1
25	57175	WIRE HARNESS W LOOM, REAR		1
26	18704216	MACH SCREW, #10-24NC. X 1	ZC	10
	33243	MUD FLAP KIT INCLUDES ITEMS 27 THRU 30		
27	32170A	MUD FLAP, (24 X 30)		2
28	18056824	BOLT, 3/8-16NC. X 1	ZC	8
29	47006302	MUD FLAP STRAP		2
30	18496800	FLANGE NUT, 3/8-16NC	ZC	8

MT8, MT10 SERIES TENDER ENGINE MOUNT OPTION ILLUSTRATION

MT10ENGMNT08
REV 4-23-13

pkg 33463B (HYD ENG DRIVE)
pkg 33462A (HYD DRIVE)

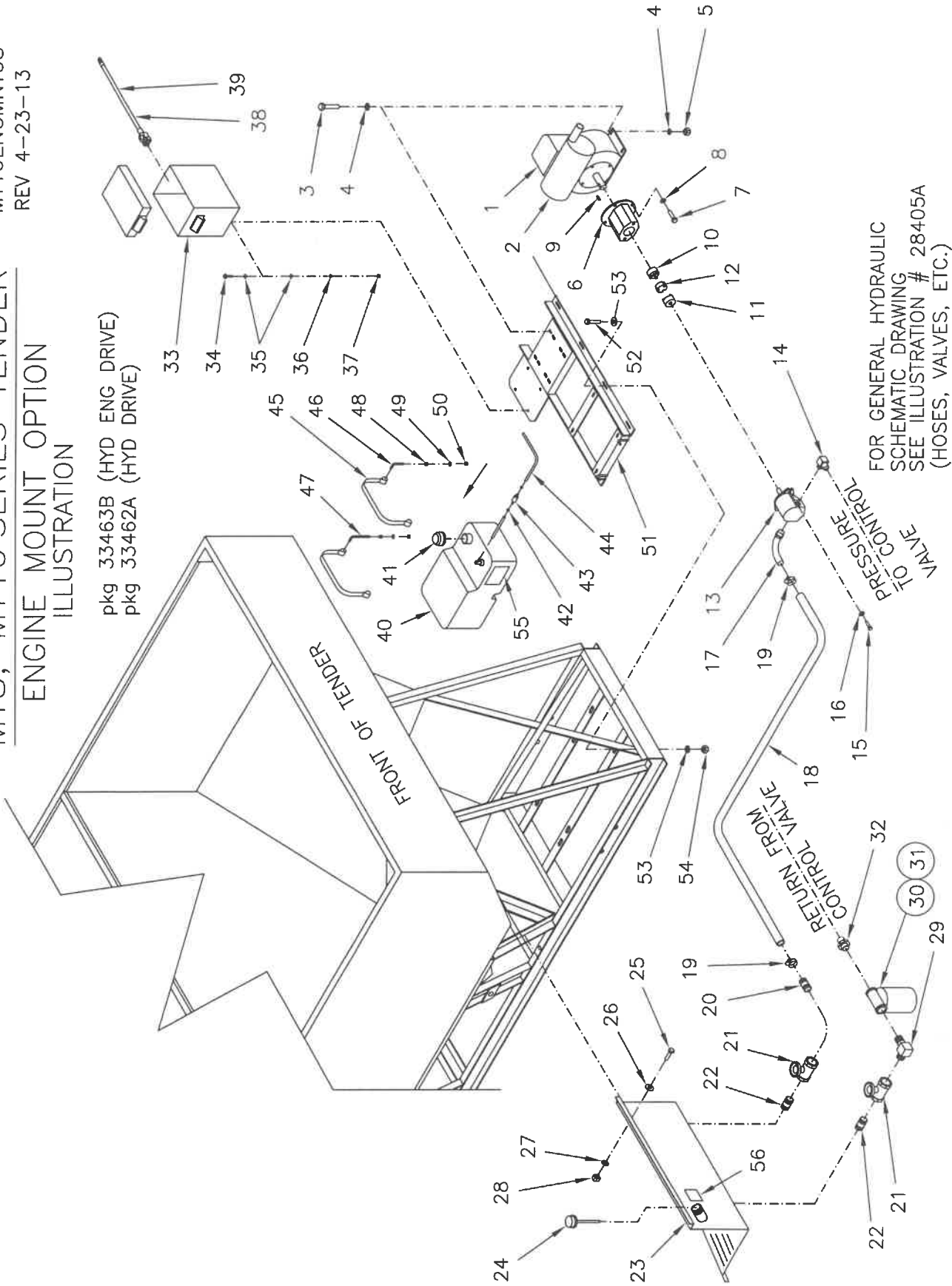

FOR GENERAL HYDRAULIC
SCHEMATIC DRAWING
SEE ILLUSTRATION # 28405A
(HOSES, VALVES, ETC.)

ENGINE DRIVE PACKAGE COMPLETE

FOR FRONT VALVE MOUNT
18 HP ENGINE PKG #

<u>ITEM</u>	<u>PART NO.</u>	<u>DESCRIPTION</u>	<u>QTY</u>
1	309853	ENGINE, KOHLER COMMAND, 18 HP.	1
2	2478605	MUFFLER PACKAGE	1
3	18056826	BOLT, 3/8-16 X 1 1/2	ZC 4
4	18811200	FLATWASHER, 3/8	ZC 8
5	18457800	NUT, CENTERLOCK, 3/8-16	ZC 4
6	52244	ADAPTER, ENGINE TO PUMP	1
7	18054123	BOLT, 7/16-18 X 1 1/4	ZC 4
8	18891300	LOCKWASHER, 7/16	ZC 4
9	10031	DRIVE KEY, 1/4 SQ. X 1 1/2	1
10	52248	COUPLER HALF, .112 BORE, 1/4 KWY.	1
11	52249	COUPLER HALF, .625 BORE, 5/32 KWY	1
12	52250	SPIDER COUPLER, HYTREL RBBR.	1
13	52243	HYD. PUMP, 2-BOLT, W/KEY	1
14	445001	ADAPTER, 90° (6801-12)	1
15	18057526	BOLT, 1/2-13 X 1	ZC 2
16	18851400	FLATWASHER, 1/2 SAE	ZC 2
17	21240	ADAPTER, HOSE BARB X 90° (4601-16)	1
18	38872	SUCTION HOSE, 1" X 42"	1
19	200250	HOSE CLAMP, (1" & 1 1/4 HOSE)	2
20	22432	NIPPLE, 1" NPT X 1" HOSE	1
21	21372	GATE VALVE, 1" NPT	2
22	72280	CLOSE NIPPLE, 1" NPT	2
23	28160	OIL TANK, STEEL WELDMENT	1
24	28173	CAP/DIPSTICK	1
25	18706622	BOLT, PAN HEAD, 3/8-16NC X 1	SS 6
26	18811210	FLAT WASHER, 3/8	SS 6
27	omitted		
28	18987900	NUT, FLANGE 3/8-16	SS 6
29	52298	ADAPTER, 90° (5500-16-12)	1
30	01170	FILTER COMPLETE	1
31	11128	FILTER ELEMENT ONLY	
32	2404-12-12	ADAPTER, 3/4 NPT X #12 MJIC	1
33	01353	BATTERY BOX, POLYETHYLENE	1
34	18706421	PAN HD BOLT, 5/16-18NC. X 3/4	SS 4
35	18991110	LOCK WASHER, 5/16	SS 4
36	18991100	FLAT WASHER, 5/16	SS 4
37	18987700	FLANGE NUT, 5/16-18NC.	SS 4
38	01350	BATTERY CABLE, (POS) RED	1
39	01351	BATTERY CABLE, (NEG) BLK.	1
40	5275579	GASOLINE TANK (POLYETHYLENE)	1
41	FILLER CAP, SEE LOCAL HARDWARE STORE		
42	200244	HOSE CLAMP, (7/16 - 1")	4
43	53431	FUEL FILTER, IN-LINE	1
44	14121	FUEL LINE, HOSE 1/4 I.D. X 42"	2
45	1105172	HOLD-DOWN STRAP	2
46	26903	J-BOLT, 5/16-18NC. X 3	1
47	26904	J-BOLT, 5/16-18NC. X 6	1
48	18496400	FLANGE NUT, 5/16-18NC.	ZC 2
49	18891110	FLAT WASHER, 5/16	ZC 2
50	18406400	HEX. NUT, 5/16-18NC.	ZC 4
51	38854	FRAME, ENGINE & TANK MOUNT	1
52	18056824	BOLT, 3/8-16NC. X 1 1/4	ZC 4
53	18811200	FLAT WASHER, 3/8	ZC 8
54	18457800	LOCK NUT, 3/8-16NC	ZC 4
55	200197	DECAL, GASOLINE WARNING	1
56	27634	DECAL, HYDRAULIC OIL	1

FOR GENERAL HYDRAULIC SCHEMATIC DRAWING
SEE ILLUSTRATION # 28405A

MT-10 SERIES TENDER REAR DISCHARGE AUGER

MT10AUGRISO
REV 12/02/20

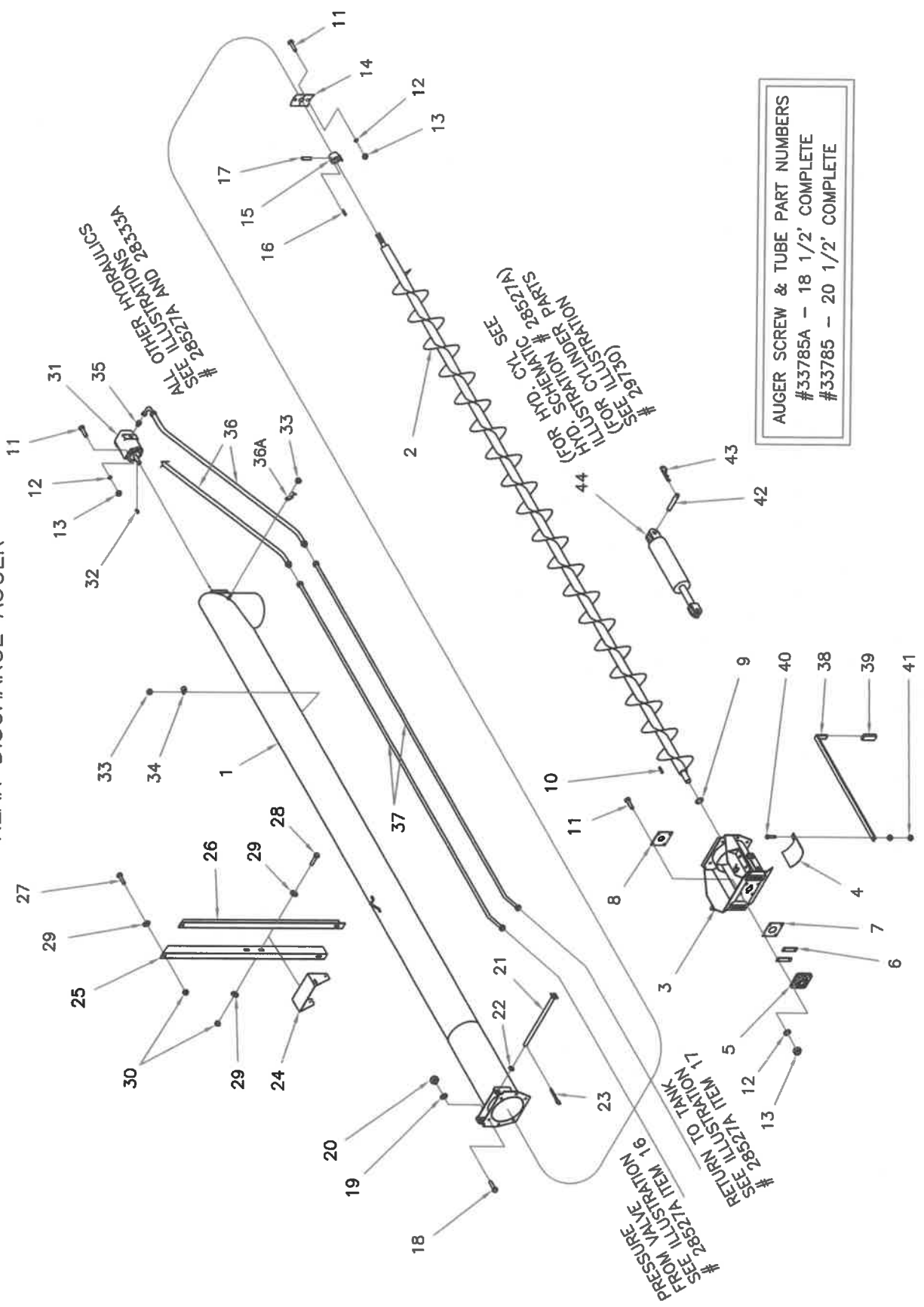

AUGER SCREW & TUBE PART NUMBERS
#33785A - 18 1/2' COMPLETE
#33785 - 20 1/2' COMPLETE

MT10 TENDER

MT10AUGRLST
REV 12/02/20

DISCHARGE AUGER PARTS LIST

ITEM	PART NO.	DESCRIPTION	QTY
1	02998A	AUGER TUBE WELDMENT, (18 1/2 FT. AUGER)	1
	29020	AUGER TUBE WELDMENT, (20 1/2 FT. AUGER)	
2	38609	SCREW WELDMENT, (18 1/2 FT. AUGER)	1
	38610	SCREW WELDMENT, (20 1/2 FT. AUGER)	
3	06976B	BOOT WELDMENT SS	1
4	06280	CLEANOUT DOOR WELDT	1
5	52065	BEARING, W/4-BOLT FLANGE 1 1/2" BORE	1
6	19346A	SPACER BAR	2
7	19345	REAR PLATE, (2.25 DIA. CENTER HOLE)	1
8	38551	INNER PLATE (1.625 DIA CENTER HOLE)	1
9	18300323	THRUST WASHER, (1 1/2 X 10 ga. MACH. WSHR)	4
10	20982	KEY, 3/8 SQ X 1 1/2" LG (ENG DRIVE ONLY)	1
11	18057428	BOLT, 1/2-13NC. X 1 3/4	ZC 8
12	18891400	LOCK WASHER, 1/2	ZC 8
13	18417400	HEX. NUT, 1/2-13NC	ZC 8
14	18674	END COVER	2
15	02972	COUPLER WELDMENT	1
16	10031	DRIVE KEY, 1/4 SQ. X 1 1/2	1
17	18767450	SET SCREW, 5/16-18NC. X 3/4 SQ. HEAD	2
18	18475240	BOLT, 1/2-13NC. X 1 1/4	SS 6
19	18991400	LOCK WASHER, 1/2	SS 6
20	18477400	HEX. NUT, 1/2-13NC	SS 6
21	02990A	AUGER PIVOT PIN	1
22	18852000	FLATWASHER, 7/8 SAE	ZC 1
23	18560826	COTTER PIN, 3/16 X 1 1/2	1
24	28099	AUGER REST	1
25	28100	ANGLE, AUGER MOUNTING LH	1
26	28101	ANGLE, AUGER MOUNTING RH	1
27	18057424	BOLT, 1/2-13NC. X 1 1/4	ZC 4
28	18057424	BOLT, 1/2-13NC. X 1 1/4	ZC 4
29	18851400	FLAT WASHER 1/2	ZC 12
30	18417400	HEX. NUT, 1/2-13NC.	ZC 8
31	51930	MOTOR, HYDRAULIC (SEE SCHEMATIC 28527A)	1
	94021	SEAL KIT FOR HYD MOTOR (NOT SHOWN)	1
32	20352	WOODRUFF KEY	1
33	18987700	FLANGE NUT, 5/16-18 NC.	S.S. 12
34	41770	HOSE CLAMP, 3/4 I.D. VINYL COATED	12
35	444001	STR. CONNECTOR #12 JICM X #12M O-RING	2
36	53581	HYD. HOSE, (3/4 X 24")	2
36A	20345	HOSE CLIP	2
37	51643	HYD LINE 3/4" X 184"	2
38	14448	HANDLE EXTENTION	1
39	10269	RUBBER GRIP	1
40	18025615	BOLT, 5/16-18NC. X 1 1/2	S.S. 1
41	18476350	HEX. NUT, 5/16-18NC.	S.S. 2
42	439-51644	1" HEADED CAST PIN	2
43	71007	CYLINDER PIN HAIRPIN CLIP	2
44		HYD. LIFT CYLINDER AND CYL COMPONENTS	

SEE HYDRAULIC SCHEMATIC ILLUSTRATION # 28527A
FOR INTERNAL PARTS SEE ILLUSTRATION # 29730

REF. DRAWING - HYDRAULIC MOTOR & HOSE

MT8-MT10

(Ref. Drwg. 28333A)

L.H. AUGER FLIGHTING
3/4" HYDRAULIC PLUMBING

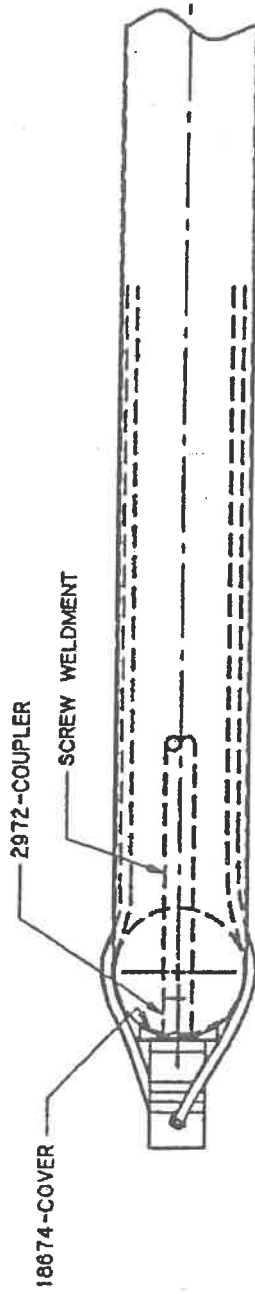

PRESSURIZED SIDE (CW AUGER ROTATION-VIEW FROM BOTTOM OF AUGER)

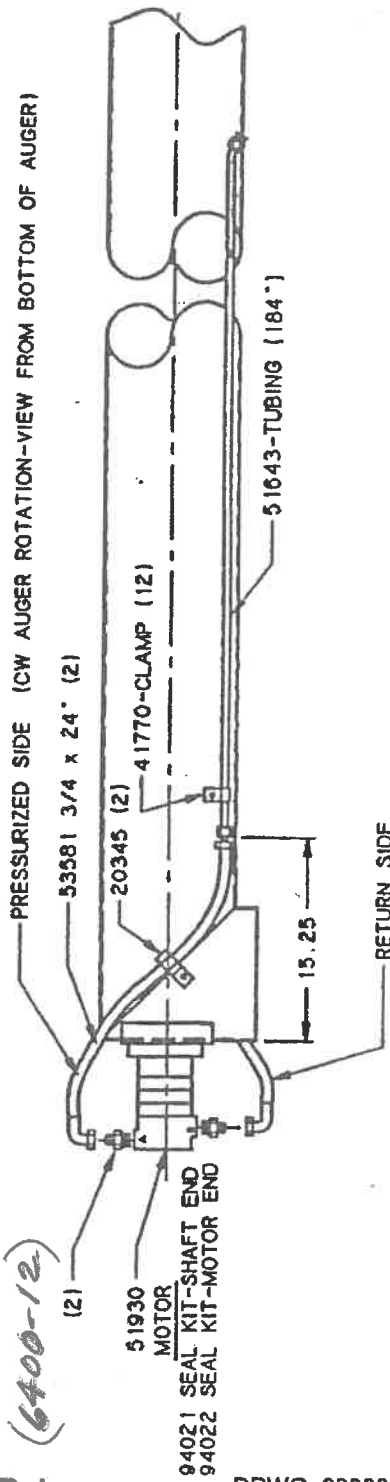

(6400-12)

3+

31A

MT8-MT10

2-2-09

TRUCK HYDRAULIC PLUMBING W/ AUGER LIFT & SHUT-OFF
(Ref. Drwg. 28527A)

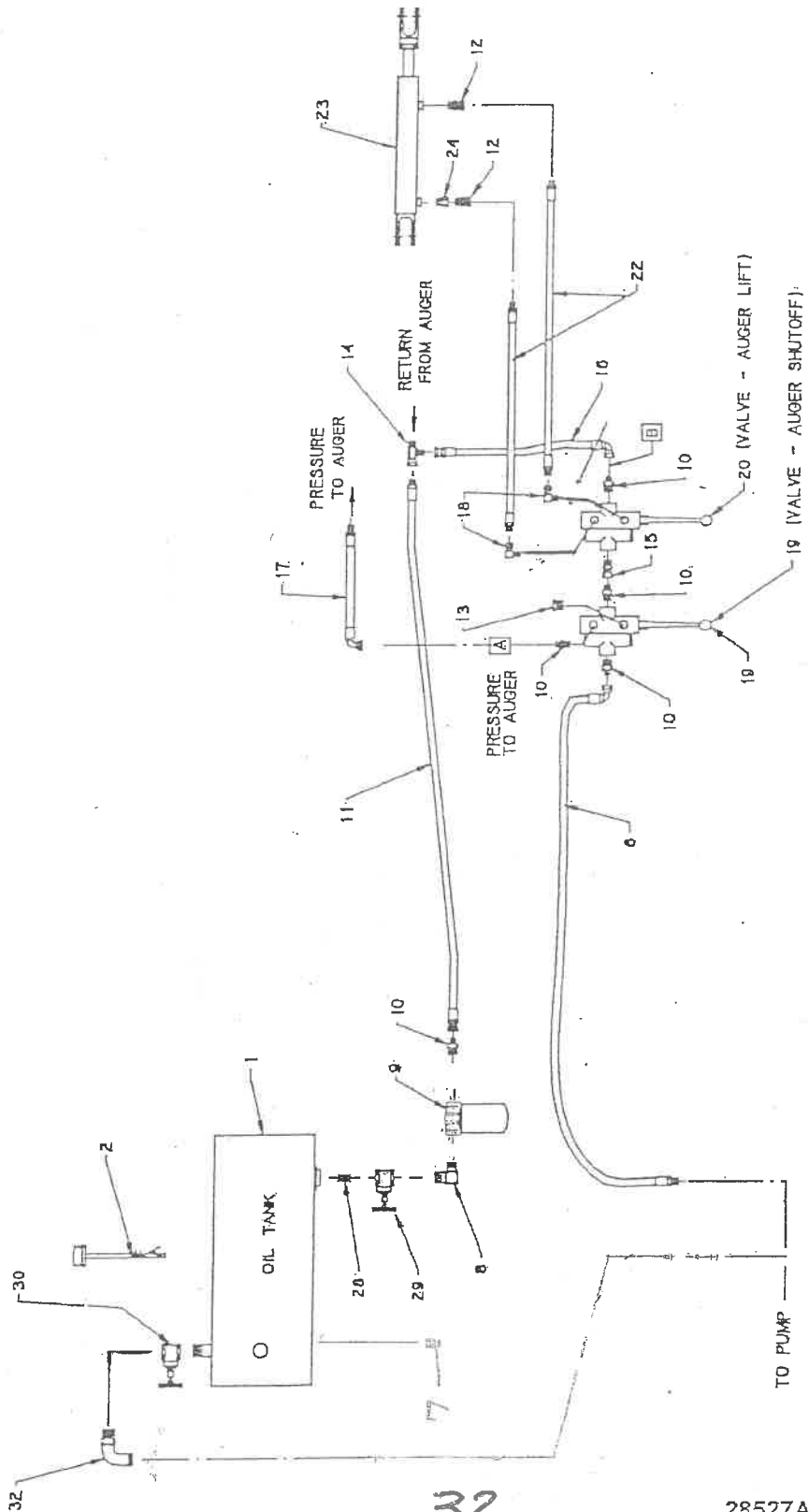

TRUCK HYDRAULIC PLUMBING SCHEMATIC

MT1028527LST
11/18/19

W/AUGER LIFT AND SHUT-OFF
REAR VALVE MOUNT

REF DRWG. 28527A

<u>ITEM</u>	<u>PART NO.</u>	<u>DESCRIPTION</u>	<u>QTY</u>
1	38711	OIL TANK	1
2	2153	DIPSTICK	1
3	-- TO ITEM 5 NOT USED		--
6	53577	HYD. HOSE, (3/4 X 240") 3/4P X #12JICFS X 90°	1
7	72175	PLUG, OIL TANK 3/4 NPT	1
8	52298	ELBOW, 3/4NPT X 1"NPT (5500-16-12)	1
9	1170	HYDRAULIC OIL FILTER	1
	11128	FILTER ELEMENT	1
10	2404-12-12	ADAPTER, 3/4P X #12JIC	5
11	53725	HYD. HOSE, (3/4 X 76") #12JICFS X #12JICM	1
12	51050	ADAPTER, 1/4P X 3/8P (1404-6-4)	2
13	72220	PLUG, 3/4NPT	1
14	53573	TEE, #12JICFS X (2) #12JICM (6602-12)	1
15	53471	ADAPTER, 3/4P X #12JICFS (6505-12)	1
16	52292	HYD. HOSE, 3/4 X 96" (#12JICFS X #12JICFS X 90°)	1
17	52293	HYD. HOSE, 3/4 X 96" (#12JICM X #12JICFS X 90°)	1
18	51331	ADAPTER, UNION 1/2MP X 1/4 NPSM(1501-8-4)	2
19	53482A	CONTROL VALVE, (3 POSITION DETENT)	1
20	51670	CONTROL VALVE, (SPRING RETURN)	1
21	-- NOT USED		--
22	51371	HYD. HOSE, 1/4 X 54" 1/4P MALE EA. END	2
23	51669	HYD. CYLINDER,. (2" X 12")	1
	47003515	CYLINDER PIN KIT	1
NOT SHOWN	98278	SEAL KIT (REPAIRS)	
	98279	CLEVIS WELDMENT (REPAIRS)	
24	28187	ADAPTER, (RESTRICTOR) 5405-6-6RX.062	1
25	-- TO ITEM 27 NOT USED		--
28	72280	CLOSE NIPPLE, 1" NPT	1
29	21372	GATE VALVE, 1" NPT	1
30	2006	GATE VALVE, 1 1/4 NPT.	1
31	NOT USED		--
32	72368	ELBOW/HOSE BARB, X 90°, 1 1/4	1
NOT SHOWN	HARDWARE TO MOUNT VALVES		
	18056830	BOLT, 3/8-16NC. X 2	ZC 4
	18811200	FLAT WASHER, (SPACERS UNDER VALVES)	ZC 12
	18911200	LOCK WASHER, 3/8	ZC 4
	18436800	HEX. NUT, 3/8-16NC.	ZC 4
NOT SHOWN	HARDWARE TO MOUNT OIL TANK		
	18056824	BOLT, 3/8-16NC. X 1 1/4	ZC 4
	18811200	FLAT WASHER, 3/8	ZC 4
	18911200	LOCK WASHER, 3/8	ZC 4
	18436800	HEX. NUT, 3/8-16NC.	ZC 4

MT10 TENDER
 ENGINE DRIVE HYDRAULIC PLUMBING
 WITH AUGER LIFT AND SHUTOFF
 FRONT VALVE MOUNT

DRAWING NO 28405A
 REV 04-22-13

(ALSO SEE MT10ENGMNT08 & MT10AUGRISO
 FOR ADDITIONAL PART DETAILS ON MACHINE)

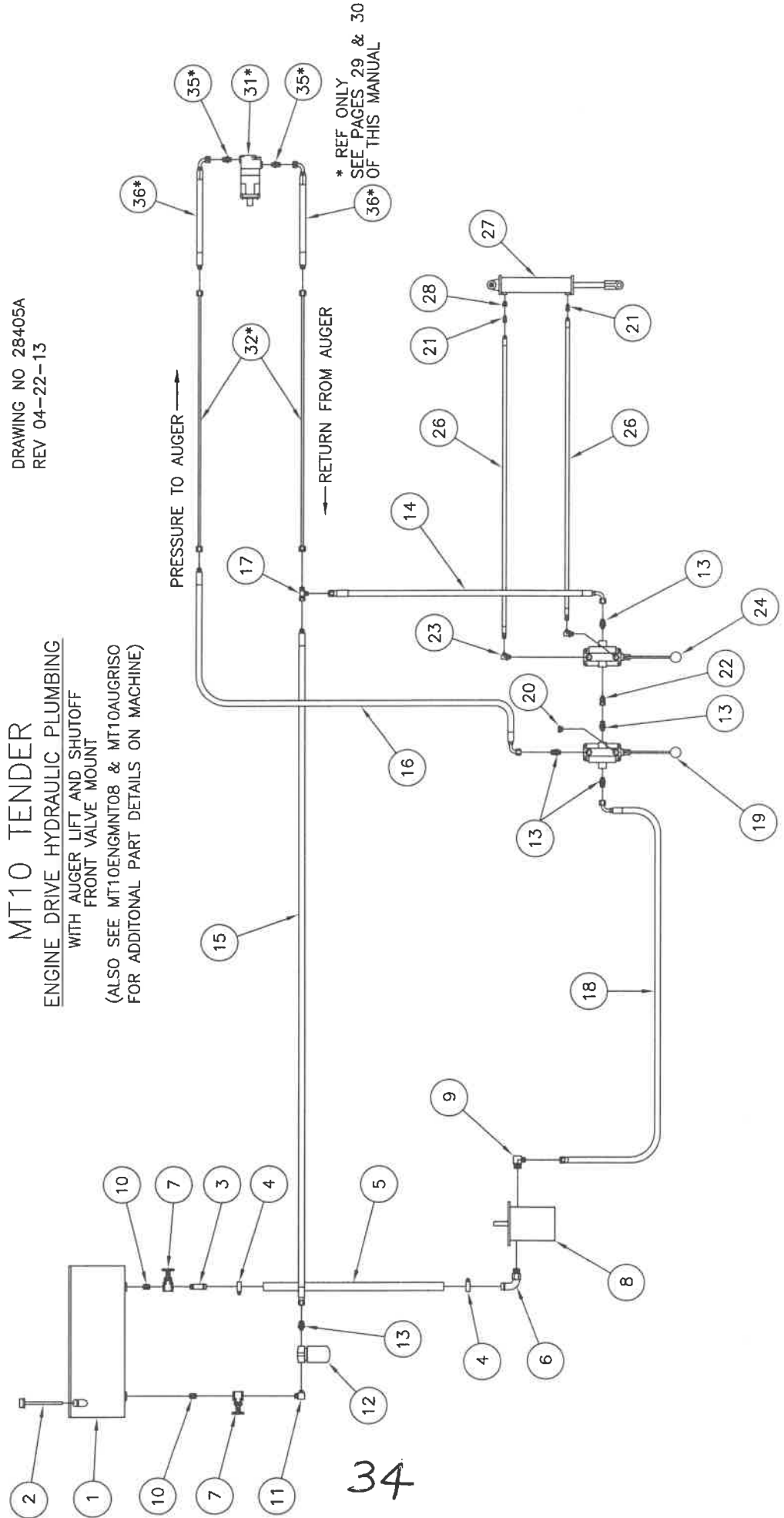

ENGINE DRIVE

HYDRAULIC PLUMBING SCHEMATIC
W/AUGER LIFT AND SHUT-OFF
FRONT VALVE MOUNT

MT1028405ALST
11/18/19

ITEM	PART NO.	DESCRIPTION	QTY
1	SEE "ENGINE MOUNT OPTION" ILLUSTRATION #MT10ENGMNT08 FOR COMPLETE ENGINE MOUNT REQUIREMENTS	OIL TANK (28160)	1
2		DIPSTICK (28173)	1
3		HOSEBARB, 1" NPT. X 1" HOSE (22432)	1
4		HOSE CLAMP, (1" & 1 1/4 HOSE) (200250)	2
5		SUCTION HOSE, 1" X 42" (38872)	1
6		ADAPTER, HOSE BARB X 90° (4601-16)	1
7		GATE VALVE, 1" NPT (21372)	2
8		HYD. PUMP, 2-BOLT, W/KEY (52243)	1
9		ADAPTER, 90° (6801-12)	1
10		CLOSE NIPPLE, 1" NPT.(72280)	2
11		ELBOW, 3/4NPT X 1"NPT (5500-16-12)	1
12		HYDRAULIC OIL FILTER (01170)	1
13	2404-12-12	ADAPTER, 3/4P X #12JIC	4
14	52292	HYD. HOSE, 3/4 X 96" (#12JICFS X #12JICFS X 90°)	1
15	53650	HYD. HOSE, 3/4 X 120 (#12JICM X #12JICFS)	1
16	52293	HYD. HOSE, 3/4 X 96" (#12JICM X #12JICFS X 90°)	1
17	53573	TEE, #12JICFS X (2) #12JICM (6602-12)	1
18	53582	HYD. HOSE, 3/4 X 132" (#12JICFS X #12JICFS X 90°)	1
19	53482A	CONTROL VALVE, (3 POSITION DETENT)	1
20	72220	PIPE PLUG, 3/4 NPT	1
21	51050	ADAPTER, 1/4P X 3/8P (1404-6-4)	2
22	53471	ADAPTER, 3/4P X #12JICFS (6505-12)	1
23	53331	ADAPTER, 1/4P X 3/8P X 90° (1501-8-4)	2
24	51670	CONTROL VALVE, (SPRING RETURN)	1
25	NOT USED		-
26	51371	HYD. HOSE, 1/4 X 54" 1/4P MALE EA. END	2
27	51669	HYD. CYLINDER,. (2" X 12")	1
	47003515	CYLINDER PIN KIT	1
NOT SHOWN	98278	SEAL KIT (REPAIRS)	
	98279	CLEVIS WELDMENT (REPAIRS)	
28	28187	ADAPTER, (RESTRICTOR) 5405-6-6RX.062	1
NOT SHOWN	HARDWARE TO MOUNT VALVES		
	18056830	BOLT, 3/8-16NC. X 2	ZC 4
	18811200	FLAT WASHER, (SPACERS UNDER VALVES)	ZC 12
	18911200	LOCK WASHER, 3/8	ZC 4
	18436800	HEX. NUT, 3/8-16NC.	ZC 4
NOT SHOWN	HARDWARE TO MOUNT OIL TANK		
	18996832	BOLT, 3/8-16NC. X 1 1/4	SS 4
	18811210	FLAT WASHER, 3/8	SS 4
	18881201	LOCK WASHER, 3/8	SS 4
	18476800	HEX. NUT, 3/8-16NC.	SS 4

HYDRAULIC CYLINDER

AUGER LIFT

(Ref. Drawing 29730)
 (2" X 12") - 1 1/8" dia. rod

	<u>Ref.</u>	<u>Part No.</u>	<u>Qty</u>	<u>Description</u>
	1.	98279	1	Clevis - Weldment
	2.	98282	1	Rod - Cylinder
Screw-On	3.	92319	1	End Gland
End Gland	4.	98091	1	Piston
Type	5.	98093	1	Nut
	6.	98281	1	Tube
	7.	98278	1	Seal Kit

Not Shown

98280 1 Jam Nut (Clevis)

51669 - Hyd Cylinder w/Clevis (Complete)

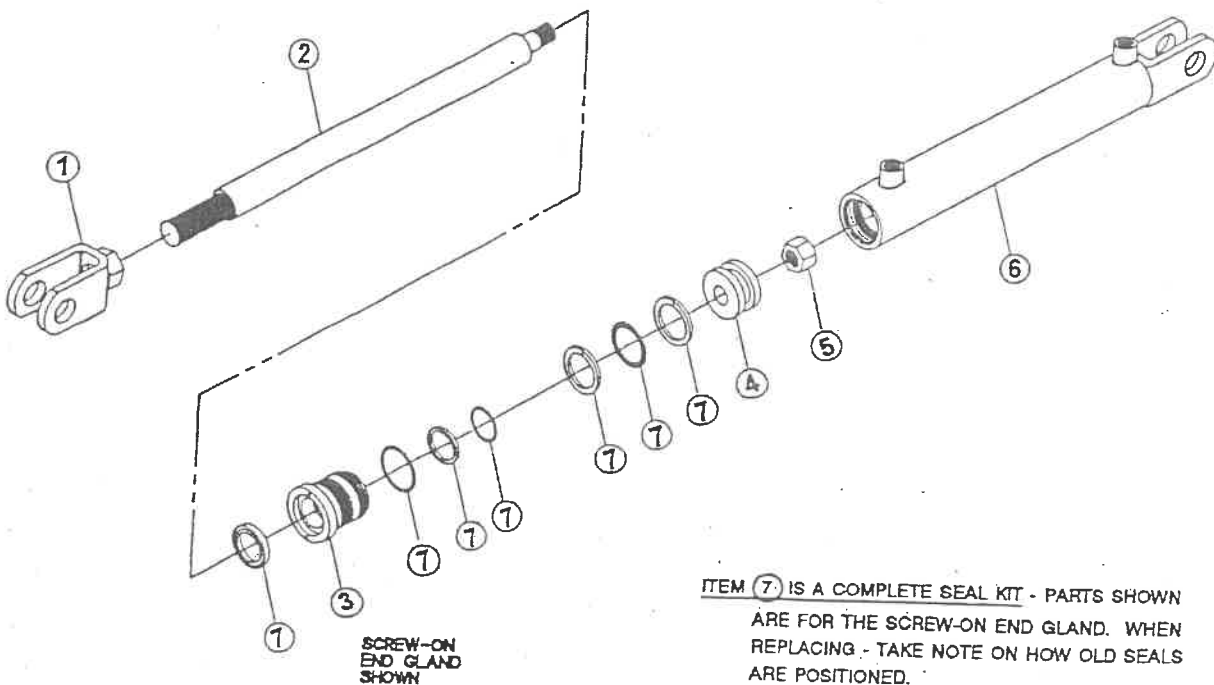

29730

28340 LIGHT KIT

WIRING DIAGRAM

MT8, MT10, MT16, MT24, MT32

NOTE: FAR LED LIGHTS ON THE TRUCK NEEDS EITHER AN LED FLASHER, OR A 50 WATT 6 OHM RESISTOR ADDED TO THE WIRE HARNESS

AMBER CLEARANCE LIGHT

NOTE: CUT 48" END TO DESIRED LENGTH AND ADD CONNECTOR

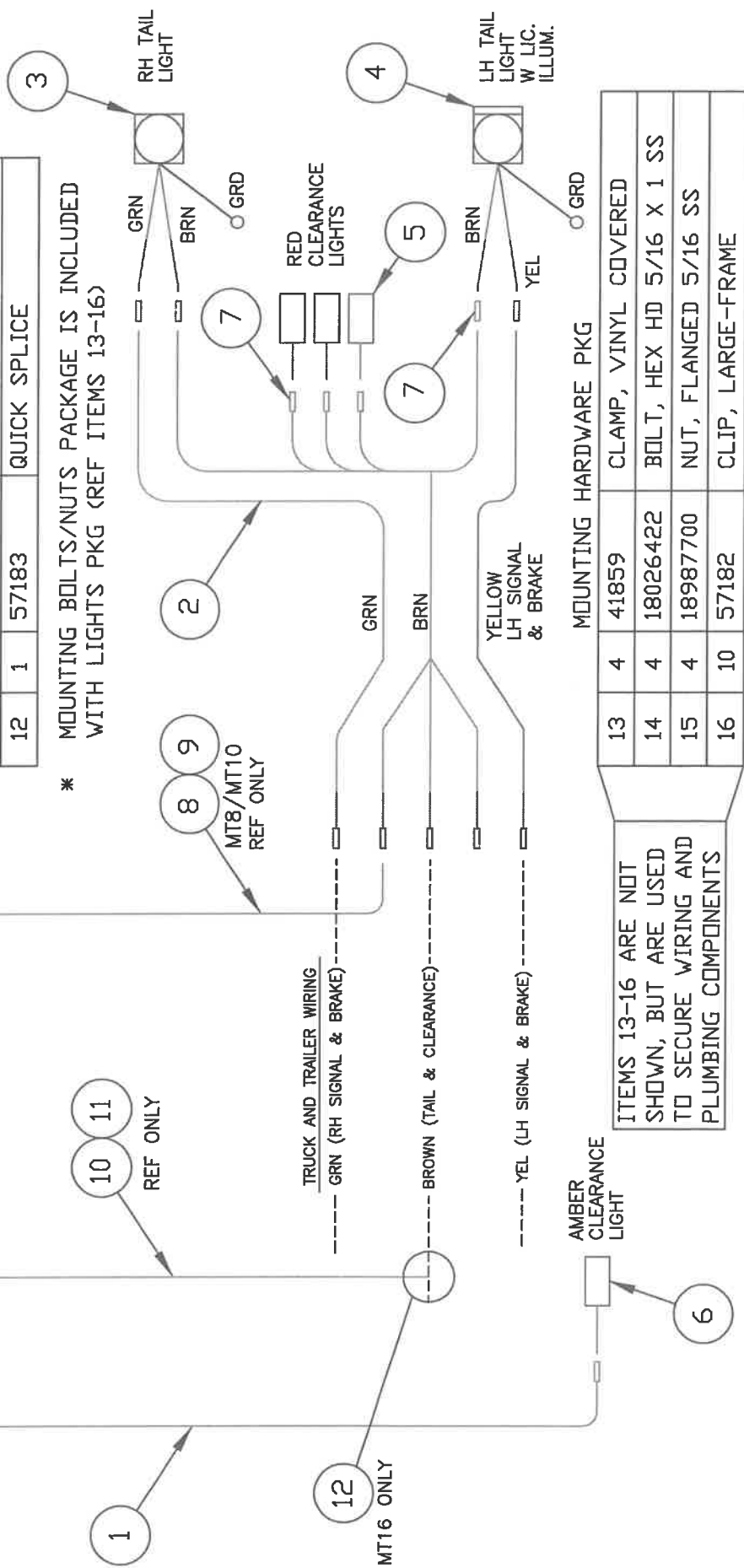

ITEM	QTY	PARTNUMBER	DESCRIPTION
1	1	57177	WIRE HARNESS W LOOM
2	1	57175	WIRE HARNESS W LOOM
3	1	01836	TAIL-LIGHT RH W/O LIC.
4	1	01829	TAIL-LIGHT W LIC ILL.
5	3	18103	CLEARANCE LIGHT, RED
6	2	18104	CLEARANCE LIGHT, AMBER
7	4	42448	BUTT CONNECTER
8	1	57180 REF	WIRE, 14GA BROWN
9	1	57181 REF	LOOM
10	1	57151 REF	WIRE, 14GA BROWN
11	1	57140 REF	LOOM
12	1	57183	QUICK SPLICE

* *

* MOUNTING BOLTS/NUTS PACKAGE IS INCLUDED WITH LIGHTS PKG (REF ITEMS 13-16)

MOUNTING HARDWARE PKG

13	4	41859	CLAMP, VINYL COVERED
14	4	18026422	BOLT, HEX HD 5/16 X 1 SS
15	4	18987700	NUT, FLANGED 5/16 SS
16	10	57182	CLIP, LARGE-FRAME

ITEMS 13-16 ARE NOT SHOWN, BUT ARE USED TO SECURE WIRING AND PLUMBING COMPONENTS

SHUR-LOK JUNIOR REPLACEMENT PARTS

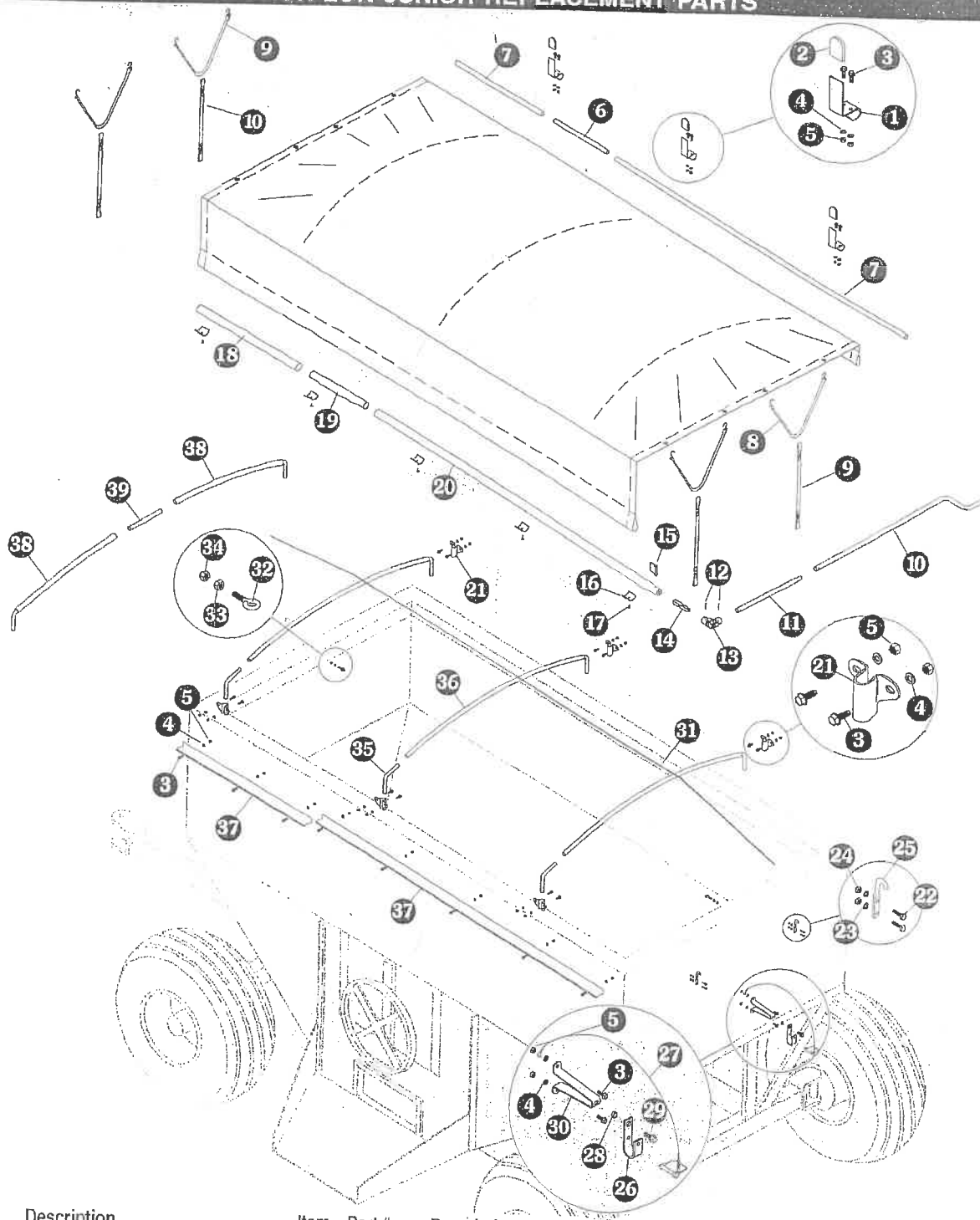

Item	Part #	Description
1	1105163	Recessed Tarp Stop
2	1700729	Protective Cap
3	1700400	Self-Tapping Screw, 3/8" x 1"
4	1700434	Lock Washer, 3/8"
5	1700407	Hex Nut, 3/8"
6	1107077	Swaged Connector, 1 1/4" x 18"
7	1105164	Fixed Tube, 1 1/8" x 96"
8	1700650	Rubber Tarp Strap, 21"
9	1105172	Easy Reach Strap, 24"
	1107005	Easy Reach Strap, 48"
10	1100461	Offset Crank Arm
11	1107838	Crank Extension, 32 5/8"
12	1700445	Spring Pin, 1/4" x 1 1/2"
13	1700527	U-Joint, 3/4" x 1" x 5"

Item	Part #	Description
14	1105166	Crank Key
15	1700526	Wire Lock Pin, 3/8" x 2 1/2"
16	1701354	U-Clamp, Plastic
17	1700398	Self-Drilling Screw, 1/4" x 3/4"
18	1110328	Roll Tube, 2" x 96"
19	1107076	Swaged Connector, 2" x 18"
20	1105174	Roll Tube w/Socket, 8"
21	1115702	Single Bow Bracket, Universal
22	1700381	Cap Screw, 1/4" x 1"
23	1700436	Lock Washer, 1/4"
24	1700408	Hex Nut, 1/4"
25	1700682	Box Hook, 3/8" x 3 1/4"
26	1100040	Crank Retainer J-Hook

Item	Part #	Description
27	1100574	SS Cable w/#5 Interlock Snap
28	1101683	Retainer Bushing, 11/16"
29	1702996	Cap Screw, 1/2" x 1 1/4"
30	1100033	Crank Retainer, 7" Standoff
31	1108578	1/4" Polyester Rope, 30 Ft.
32	1700717	Eyebolt Anchor, 5/16"
33	1700411	Hex Nut, 5/16"
34	1700419	Nylon Lock Nut, 5/16"
35	1100695	Bow Shank, 3/4" x 108°
36	1100758	Bow Tube, Low Rise, Std.
37	1701547	Side Mount Latch Plate, Galv., 8"
38	1106926	Bow, High Rise, X-Wide
39	1100685	Tube Insert, 1" x 10"

TARP INSTALLATION

Item	Part #	Description
1.	1105174	Fixed Tube, 1 1/8" x 96"
2.	1105164	Roll Tube w/Square Key, 96"
3.	1701354	Plastic U-Clamp
4.	1700729	Protective Cap
5.	1105163	Recessed Tarp Stop
6.	1107077	Swaged Connector, 1 1/4" x 18"
7.	1107076	Swaged Connector, 2" x 18"
8.	1110328	Roll Tube, 2" x 96"
9.	*	Tarp
B.		Self-Tapping Screw, 3/8" x 1"
D.		Self-Drilling Screw, 1/4" x 3/4"
G.		Lock Washer, 3/8"
M.		Hex Nut, 3/8"
* Specify length and width of box		

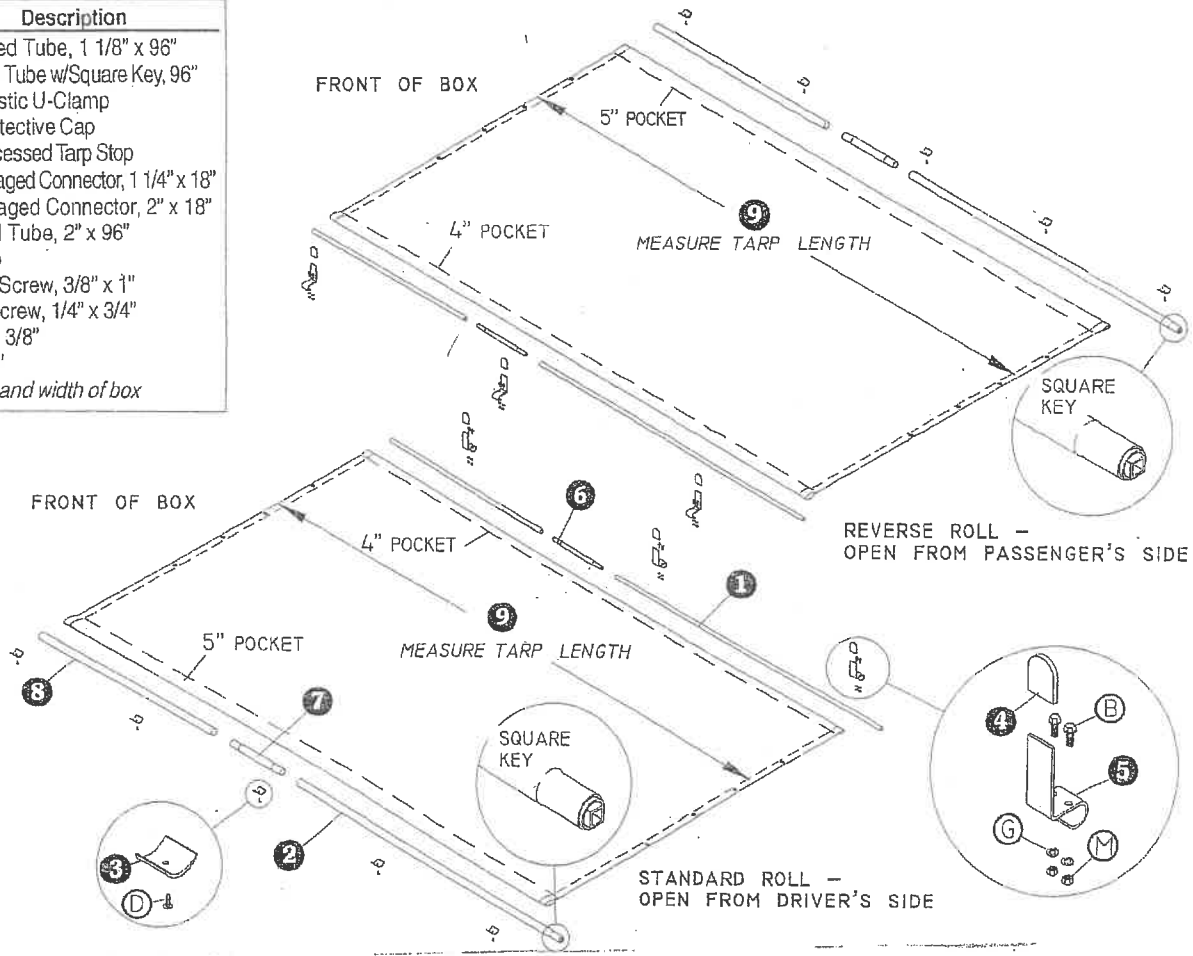

SEE "SHUR-LOK" OWNER'S MANUAL
FOR INSTALLATION INSTRUCTIONS

